



**9120
WHEAT
STREET, NE**
COVINGTON,
GA 30014

FOR LEASE
40,000+/- SF Warehouse Building

BRIAN BRATTON, SIOR

Senior Vice President
404.942.2028
bbratton@kingindustrial.com

STEVE RATCHFORD, SIOR, CCIM

Senior Vice President
404.942.2003
sratchford@kingindustrial.com

King Industrial
Realty, Inc.

Industrial • Commercial • Investment
404.942.2000 | kingindustrial.com

Wheat Street Northeast

FOR LEASE
40,000+/- SF



PROPERTY HIGHLIGHTS

- 500+/- SF Office Space
- 4 Dock High Doors
- (1) 16'Hx12'W Drive-In Door
- 20'-28' Clear Ceiling Height
- Power: 400 Amps, 277/480 Volts
- Sprinklered
- 200' Truck Court
- Zoned Light Industrial in the City of Covington
- **6 Months Free Rent with a 5 Year Deal!**

BRIAN BRATTON, SIOR

Senior Vice President

404.942.2028

bbratton@kingindustrial.com

STEVE RATCHFORD, SIOR, CCIM

Senior Vice President

404.942.2003

sratchford@kingindustrial.com

Every effort has been made to provide accurate information, but no liability is assumed for errors or omissions.



Industrial • Commercial • Investment
404.942.2000 | kingindustrial.com

ADDITIONAL PHOTOS



BRIAN BRATTON, SIOR

Senior Vice President

404.942.2028

bbratton@kingindustrial.com

STEVE RATCHFORD, SIOR, CCIM

Senior Vice President

404.942.2003

sratchford@kingindustrial.com

Every effort has been made to provide accurate information, but no liability is assumed for errors or omissions.

King Industrial
Realty, Inc.

CORFAC
INTERNATIONAL

Industrial • Commercial • Investment
404.942.2000 | kingindustrial.com

FLOOR PLAN

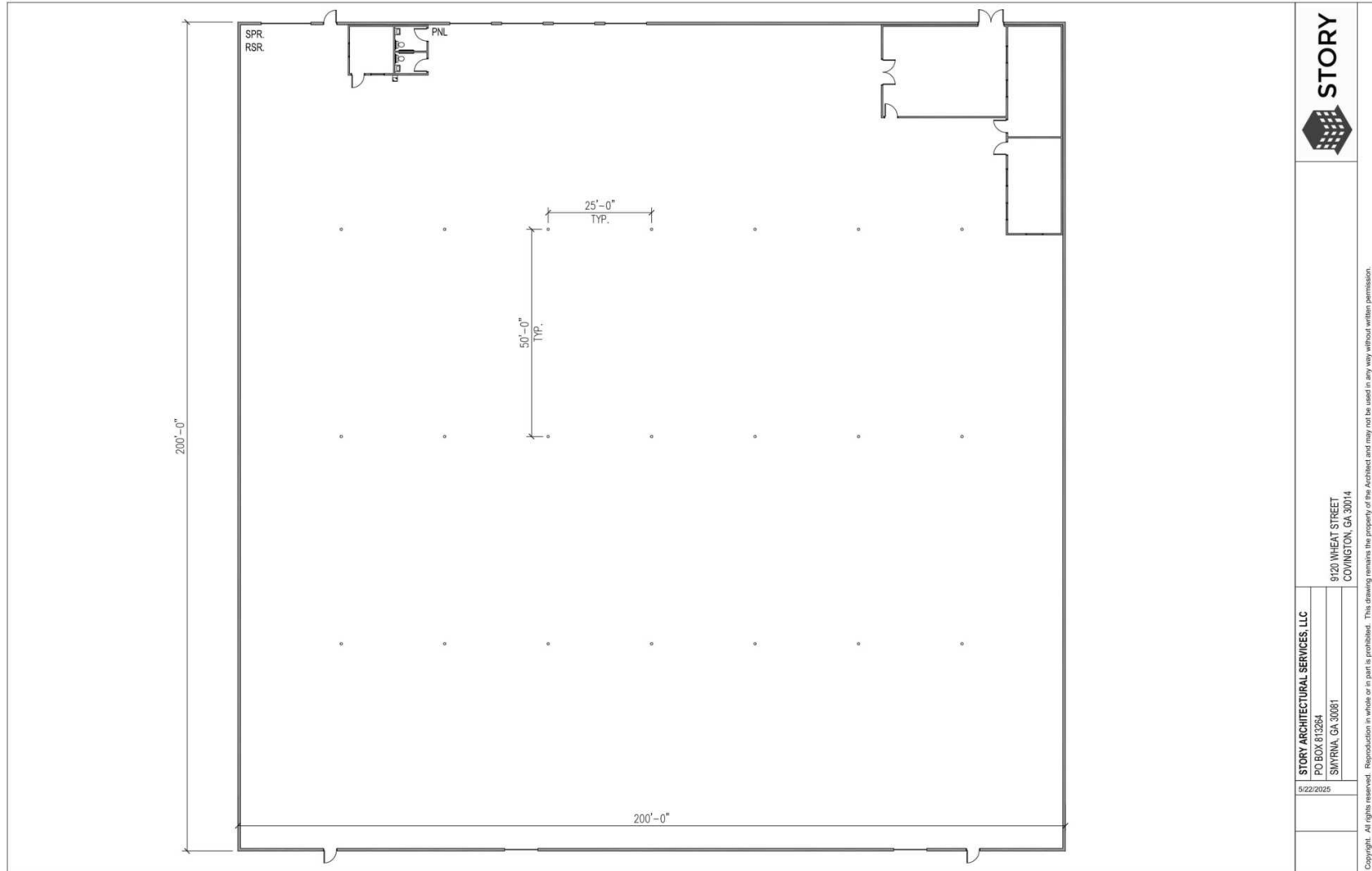

BRIAN BRATTON, SIOR

Senior Vice President

404.942.2028

bbratton@kingindustrial.com

STEVE RATCHFORD, SIOR, CCIM

Senior Vice President

404.942.2003

sratchford@kingindustrial.com

King Industrial
Realty, Inc.

CORFAC
INTERNATIONAL

Industrial • Commercial • Investment
404.942.2000 | kingindustrial.com

EXCLUSIVELY LISTED BY:

BRIAN BRATTON, SIOR

Senior Vice President
bbratton@kingindustrial.com
404.942.2028

STEVE RATCHFORD, SIOR, CCIM

Senior Vice President
sratchford@kingindustrial.com
404.942.2003

Wheat Street Northeast

KING Industrial
Realty, Inc.

Industrial • Commercial • Investment
404.942.2000 | kingindustrial.com