

4341 NORMAN BRIDGE ROAD

Montgomery, Alabama 36105



OFFERING SUMMARY

Sale Price:	\$432,000
Lease Rate:	Call Agent for Pricing
Lot Size:	1.377 Acres
Year Built:	1980
Building Size:	10,800 SF
Zoning:	M-1 Light Industrial
Traffic Count:	6,497
Price / SF:	\$40.00

PROPERTY OVERVIEW

Aronov Realty Brokerage, Inc. is pleased to offer the opportunity to purchase or lease 4341 Norman Bridge Road. This property offers a spacious 10,800 square foot building ideally suited for Warehouse use on a 1.37 acres lot. Close proximity to East South Boulevard and I-65 make this location easily accessible.

LOCATION OVERVIEW

Conveniently located near the intersection of Norman Bridge Road and E Fleming Road. Less than half a mile to East South Boulevard and 2.5 miles from I-65.

PROPERTY HIGHLIGHTS

- 392 SF of Office
- 10,408 SF of Warehouse
- 18' Clear Height
- 1 Dock High Door
- 2 Drive-In Doors

PRESENTED BY:

Scott Harris
Senior Vice President & Qualifying Broker
334.462.2608
scott.harris@aronov.com

aronovcommercial.com
3500 Eastern Boulevard
Montgomery, AL 36116

Warehouse Property For Sale or Lease

ARONOV

4341 NORMAN BRIDGE ROAD

Montgomery, Alabama 36105



PRESENTED BY:

Scott Harris

Senior Vice President & Qualifying Broker

334.462.2608

scott.harris@aronov.com

aronovcommercial.com

3500 Eastern Boulevard

Montgomery, AL 36116

This information is from sources deemed reliable, but agent makes no representation or warranty as to the accuracy of the information. Package is subject to prior sale, price change, correction and withdrawal.

4341 NORMAN BRIDGE ROAD

Montgomery, Alabama 36105

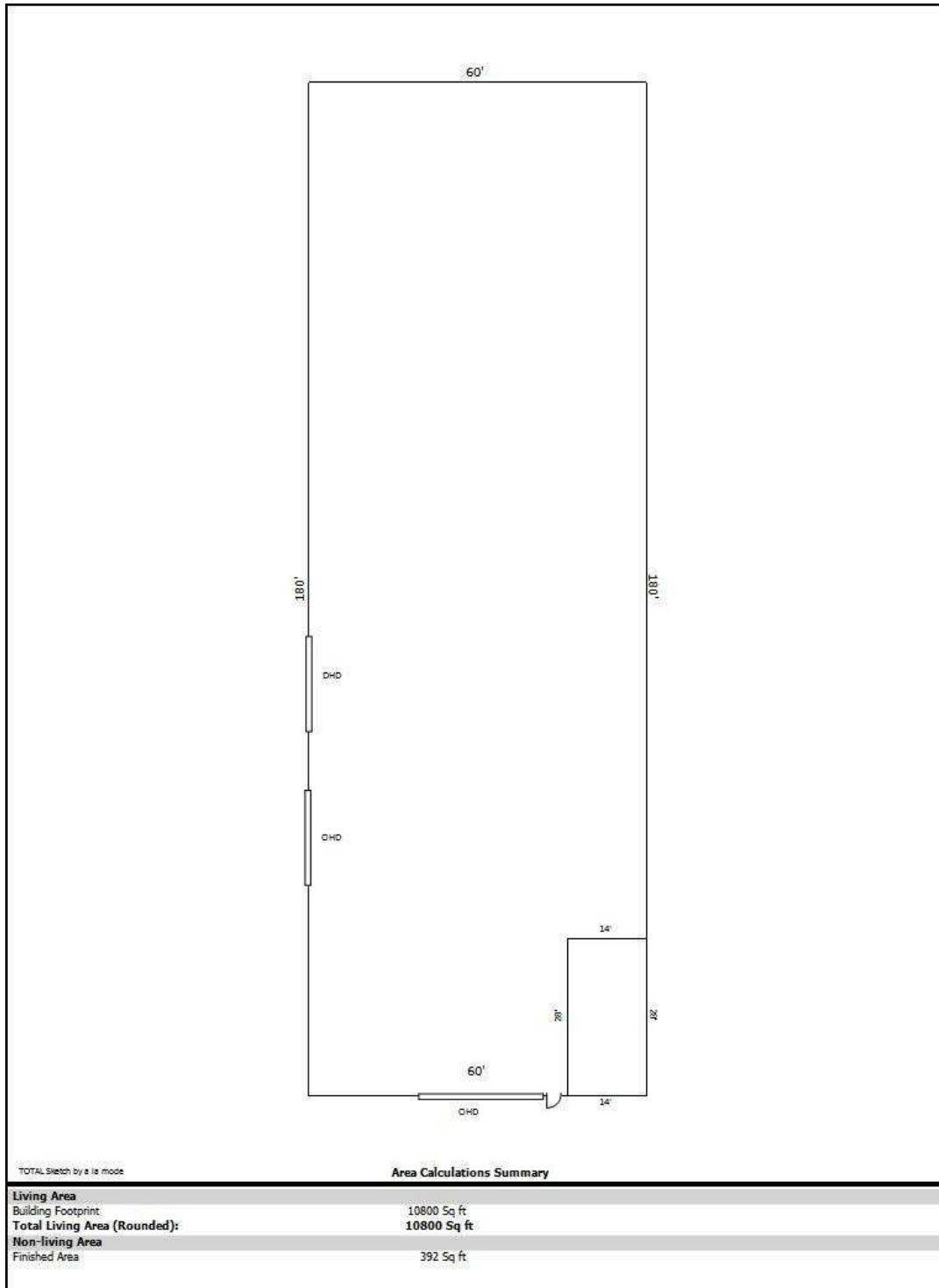

PRESENTED BY:

Scott Harris

Senior Vice President & Qualifying Broker

334.462.2608

scott.harris@aronov.com

aronovcommercial.com

3500 Eastern Boulevard

Montgomery, AL 36116

Warehouse Property For Sale or Lease

ARONOV

4341 NORMAN BRIDGE ROAD

Montgomery, Alabama 36105

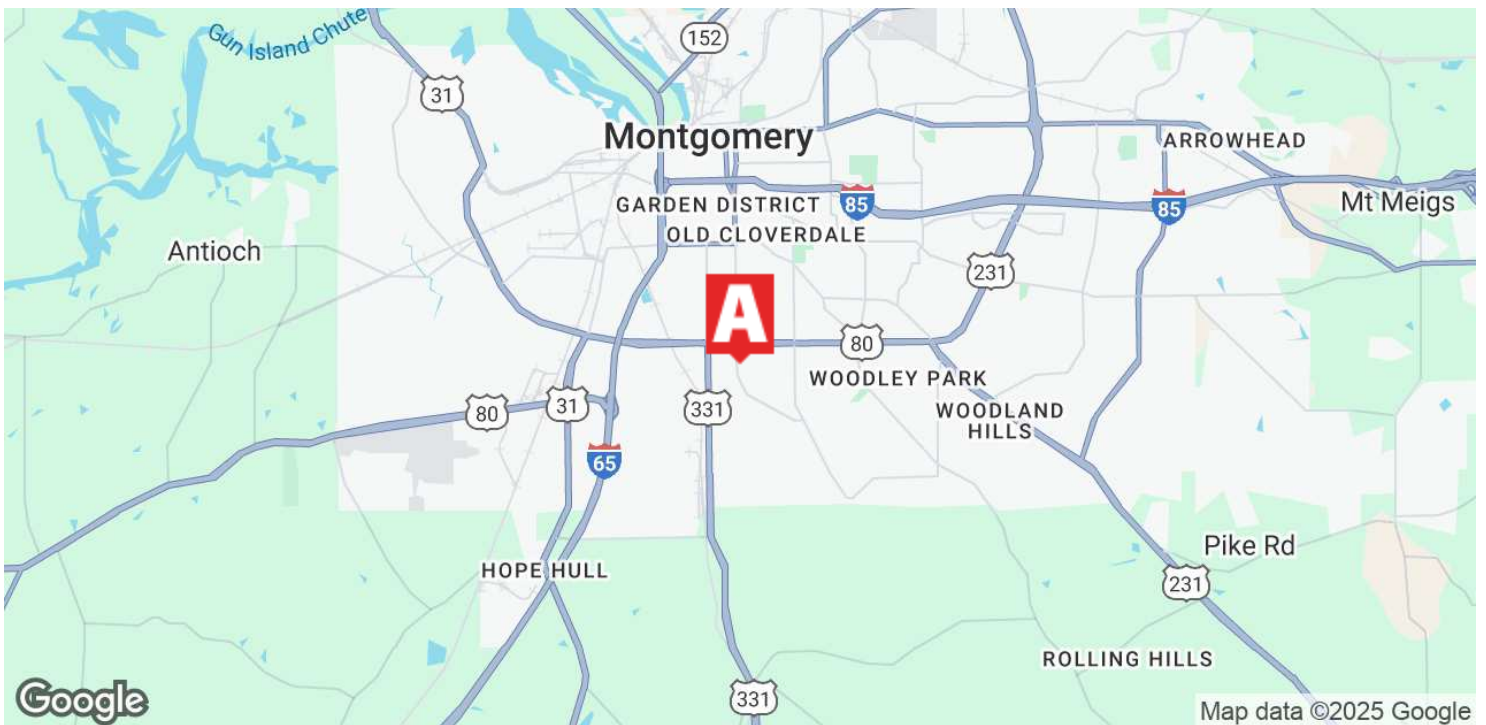

PRESENTED BY:

Scott Harris

Senior Vice President & Qualifying Broker

334.462.2608

scott.harris@aronov.com

aronovcommercial.com

3500 Eastern Boulevard

Montgomery, AL 36116

This information is from sources deemed reliable, but agent makes no representation or warranty as to the accuracy of the information. Package is subject to prior sale, price change, correction and withdrawal.