

# 16214 57th Avenue E

Puyallup, WA 98375

20,000 SF Yard & 1,920 SF Warehouse



## Property Overview

- Sublease through March 31, 2027
- 1,920 SF open warehouse/shop space with no office
- 1 oversized grade-level loading door
- 20,000 SF secured and paved yard area
- The property is fully fenced and gated with secured access
- \$1.00 per warehouse SF, NNN
- \$0.25 per yard SF, NNN
- Available with 30-day notice

# Aerial and Floor Plan

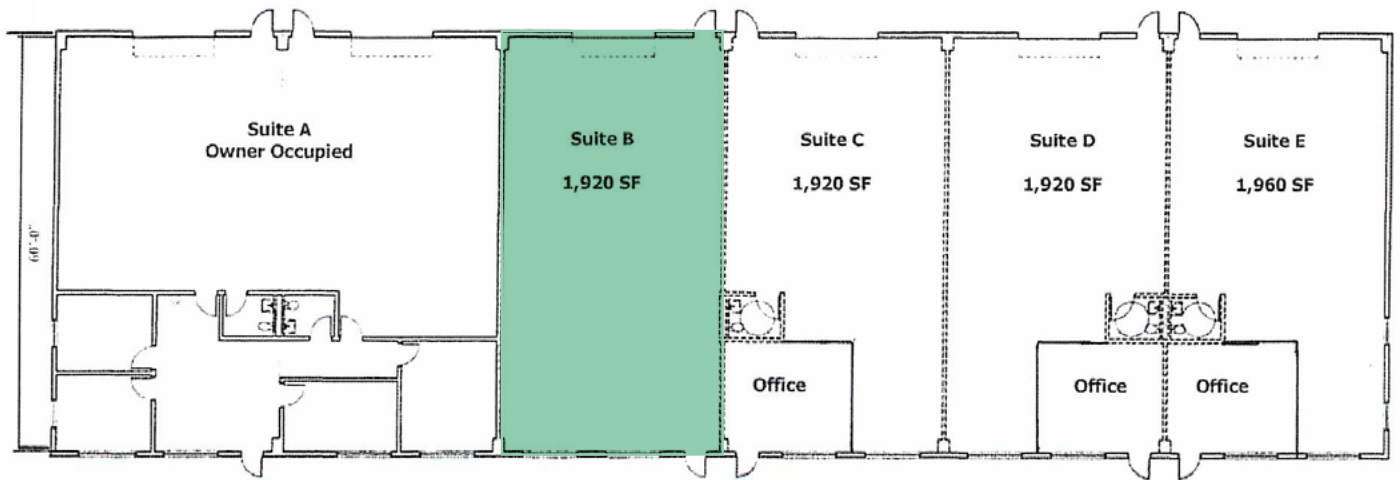

## Contact Us

**Chris Cowles**

First Vice President  
+1 253 596 0048  
chris.cowles@cbre.com

**Monte Decker**

Senior Vice President  
+1 253 380 2390  
monte.decker@cbre.com

© 2026 CBRE, Inc. All rights reserved. This information has been obtained from sources believed reliable, but has not been verified for accuracy or completeness. You should conduct a careful, independent investigation of the property and verify all information. Any reliance on this information is solely at your own risk. CBRE and the CBRE logo are service marks of CBRE, Inc. All other marks displayed on this document are the property of their respective owners, and the use of such logos does not imply any affiliation with or endorsement of CBRE. Photos herein are the property of their respective owners. Use of these images without the express written consent of the owner is prohibited. BSO\_01.07.2026