



CUSHMAN &
WAKEFIELD



OFFICE SPACE FOR LEASE

MOUNTAIN VIEW CORPORATE CENTER I

756 EAST WINCHESTER / SALT LAKE CITY, UT

HIGH PROFILE, CLASS A PROPERTY

- Excellent secured, underground parking
- High profile, Class A building
- Immediate access to I-215
- Close to restaurants, banks, business services and shopping
- I-215 visibility
- Abundant window lines provide for great natural light
- Great location with unmatched freeway visibility
- 1,979 RSF to 13,891 RSF Available
- **\$27.00/RSF, Full Service**

AVAILABLE SUITES

SUITE 300	5,633 RSF
SUITE 302	2,353 RSF
SUITE 303	3,926 RSF
SUITE 305	1,979 RSF

**SUITES CAN BE COMBINED
FOR 13,891 RSF CONTIGUOUS**

CONTACT

Dana Baird, CCIM
Executive Managing Director
+1 801 303 5526
dana.baird@cushwake.com

Mike Richmond
Executive Managing Director
+1 801 303 5434
mike.richmond@cushwake.com

170 South Main Street, Suite 1600
Salt Lake City, UT 84101
+1 801 322 2000
cushmanwakefield.com

MOUNTAIN VIEW CORPORATE CENTER I

756 EAST WINCHESTER / SALT LAKE CITY, UT

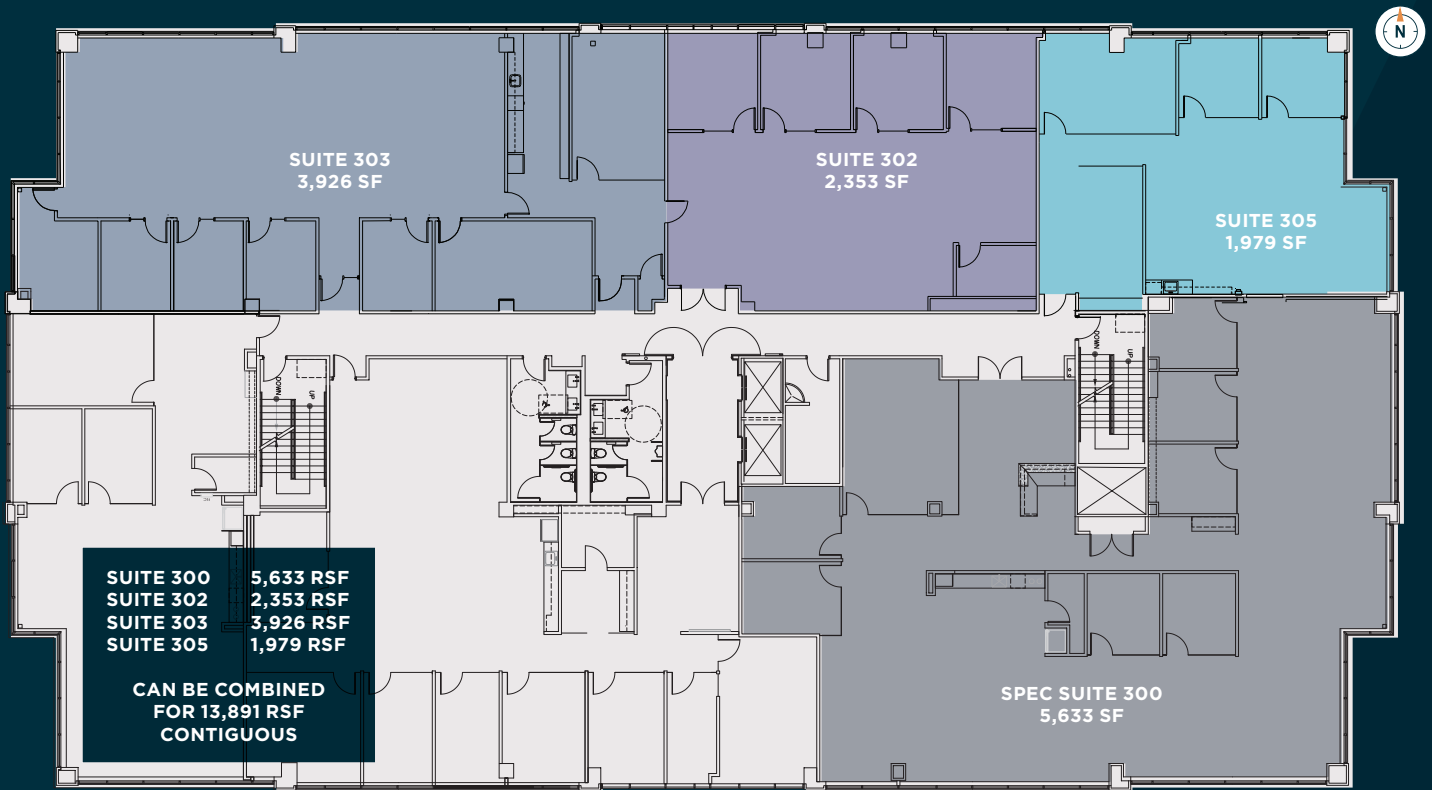

THIRD FLOOR



CONTACT

DANA BAIRD, CCIM
 Executive Managing Director
 +1 801 303 5526
 dana.baird@cushwake.com

MIKE RICHMOND
 Executive Managing Director
 +1 801 303 5434
 mike.richmond@cushwake.com

