

15301 – 15311 W. MCNICHOLS RD.
DETROIT, MICHIGAN



**SIGNATURE
ASSOCIATES**
KNOW SIGNATURE | KNOW RESULTS

MEDICAL FOR SALE
4,804 Square Feet Available



PROPERTY FEATURES

- 4,804 square feet available
- Existing dental office
- Modern facility with many updates
- Zoned B2
- Sale Price: \$395,000 (\$82.22/sq. ft.)

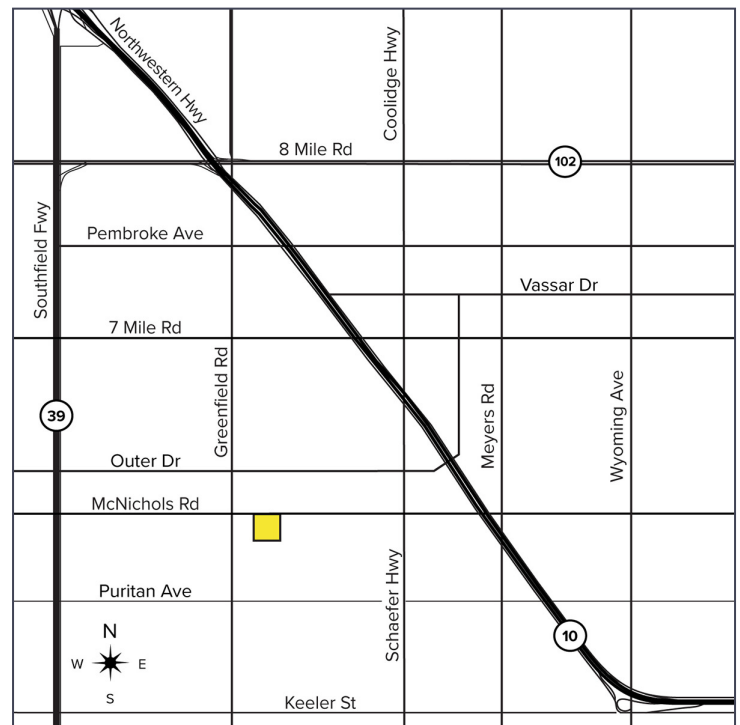

For more information, please contact:

JOE STACK
(248) 359 0615
jstack@signatureassociates.com

CHRIS MONSOUR
(248) 948 0107
cmonsour@signatureassociates.com

SIGNATURE ASSOCIATES
One Towne Square, Suite 1200
Southfield, MI 48076
www.signatureassociates.com

15301 – 15311 W. McNichols Rd. – Detroit, Michigan

Medical For Sale

4,804
Square Feet
AVAILABLE

Site Plan

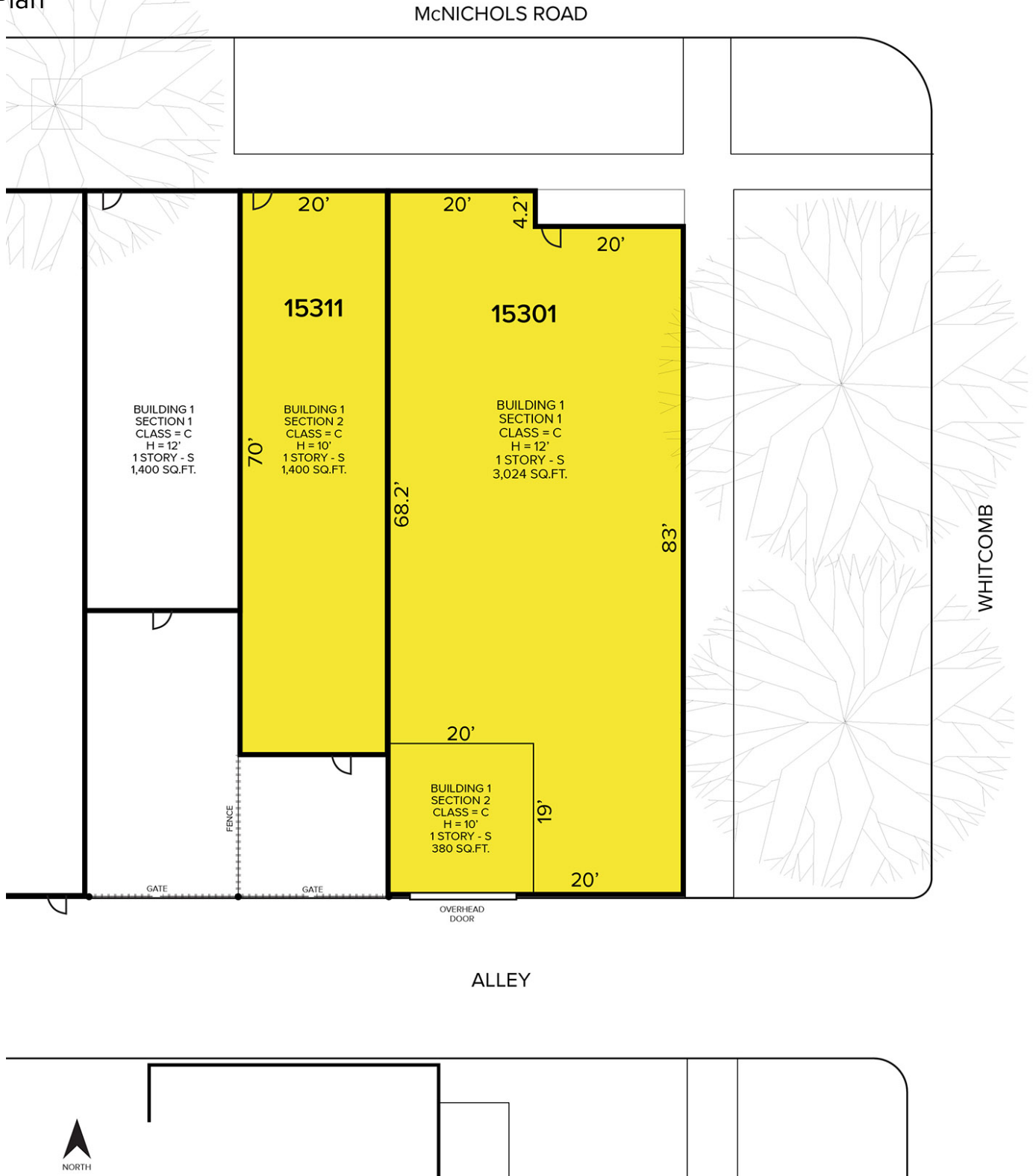

For more information, please contact:

JOE STACK
(248) 359 0615
jstack@signatureassociates.com

CHRIS MONSOUR
(248) 948 0107
cmonsour@signatureassociates.com

SIGNATURE ASSOCIATES
One Towne Square, Suite 1200
Southfield, MI 48076
www.signatureassociates.com

15301 – 15311 W. McNichols Rd. – Detroit, Michigan

Medical For Sale

4,804
Square Feet
AVAILABLE

Aerial

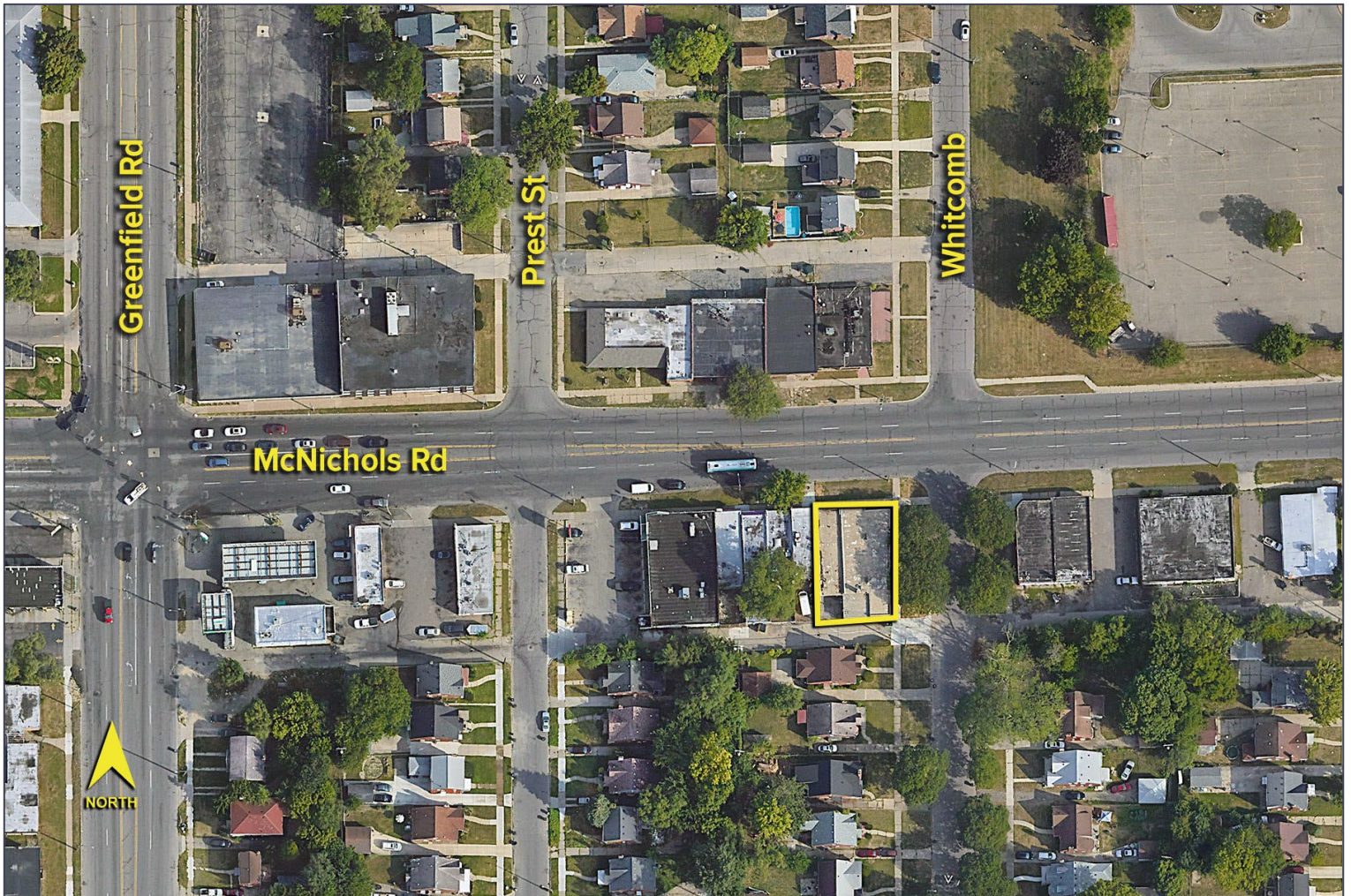

For more information, please contact:

JOE STACK
(248) 359 0615
jstack@signatureassociates.com

CHRIS MONSOUR
(248) 948 0107
cmonsour@signatureassociates.com

SIGNATURE ASSOCIATES
One Towne Square, Suite 1200
Southfield, MI 48076
www.signatureassociates.com