

7,210 SF



Prologis NW Corporate Park



3428 NW Yeon Avenue - Bldg 8
Portland, OR 97210 USA

LOCATION

- Guilds Lake / NW Industrial Area
- Ten (10) Buildings; 678,026 SF Park

FACILITY

- Approximately 7,210 SF with 447 SF Office/Showroom
- Two (2) Single Dock Doors
- One (1) Grade Level Door
- Fully Sprinklered
- 250 Amps of 480v Power (could be updated to 400A with new panel.)
- 20' Clear Height

ADVANTAGES AND AMENITIES

- Highly Visible, Close-In NW Location
- Minutes to Downtown Portland
- Immediate Access to I-405 and I-5
- Park Amenities Include Food and Convenience Services
- Please Call Brokers for Current Rates

Your single-source service for efficient move-in and operations: prologisessentials.com

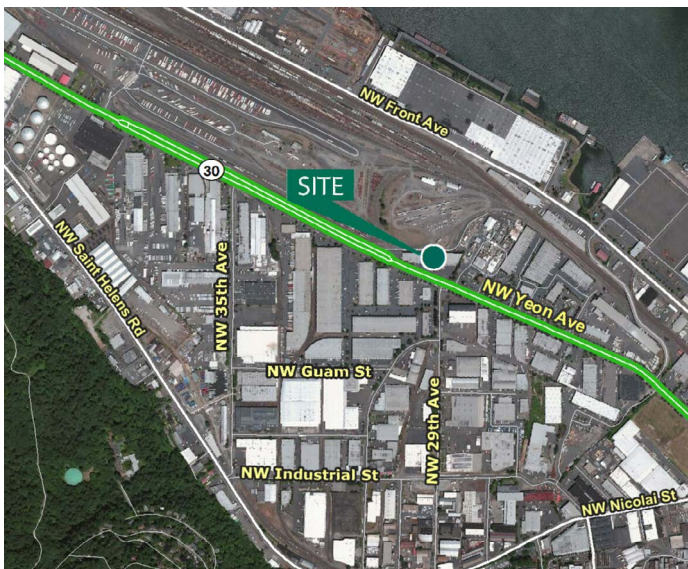

7,210 SF



Prologis NW Corporate Park

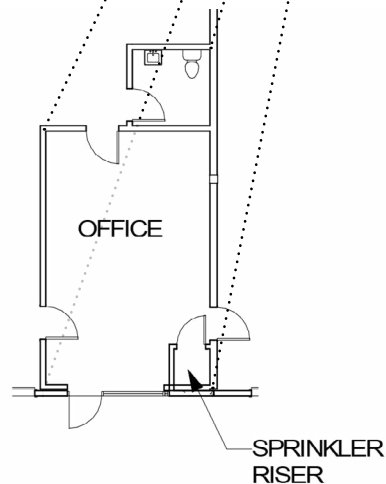
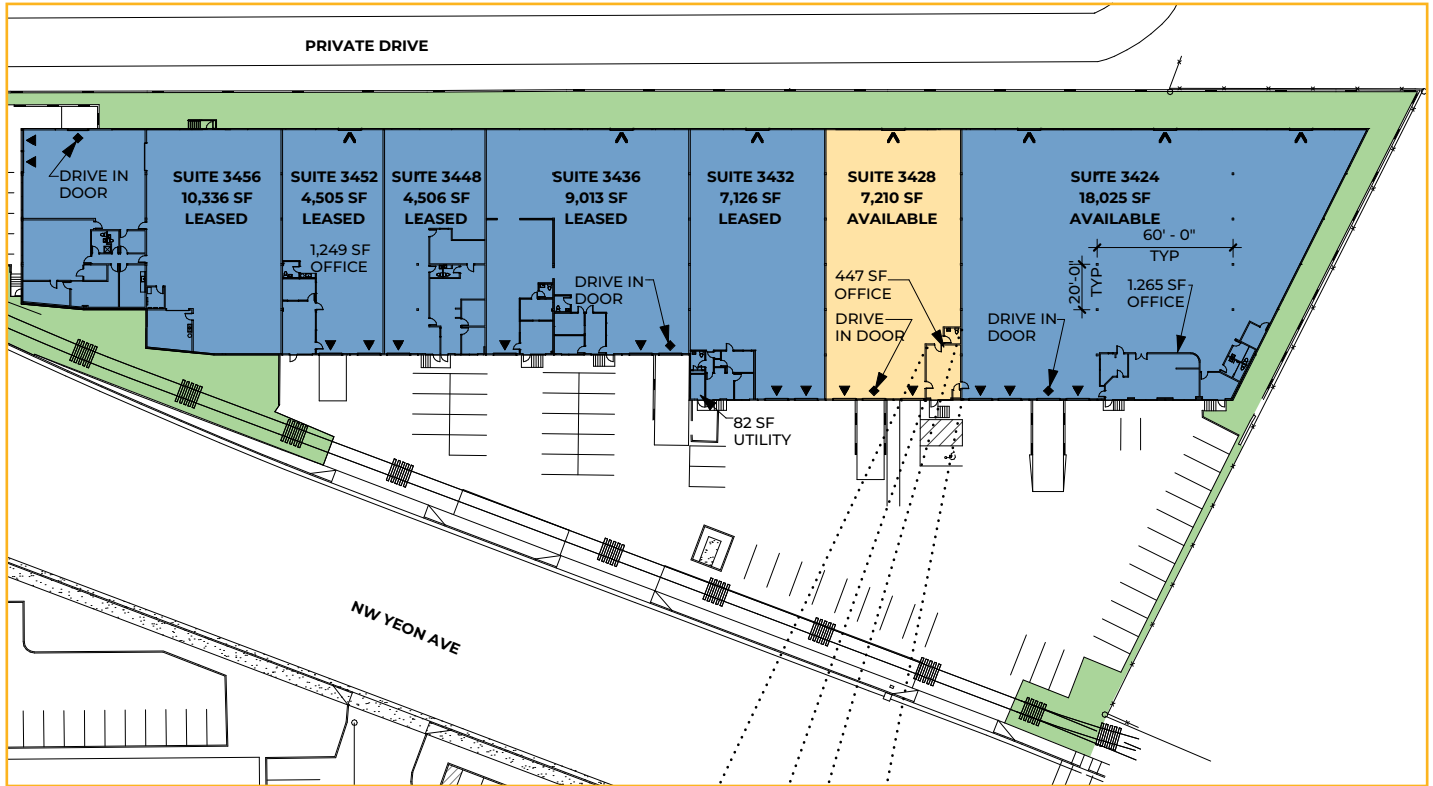

Capacity Commercial Group
Scott Kappes, SIOR
scottk@capacitycommercial.com
ph +1 503 517 9877
cell +1 503 816 4201
805 SW Broadway Street,
Suite 600,
Portland, OR 97205 USA

Capacity Commercial Group
Kenny Houser, SIOR
kenny@capacitycommercial.com
ph +1 503 517 9875
cell +1 503 385 6080
805 SW Broadway Street,
Suite 600,
Portland, OR 97205 USA

Prologis
Kurt Nelson
knelson@prologis.com
ph +1 503.276.7361
4380 SW Macadam Avenue
Suite 440
Portland, OR 97239