

WAREHOUSE SPACE FOR LEASE
709B Nichols Blvd
 COLORADO SPRINGS, CO



PROPERTY SUMMARY

	Square Feet	Monthly Rent \$10.00/SF	NNNs \$3.25/SF	Monthly Total
--	--------------------	-----------------------------------	--------------------------	----------------------

709B:	8,375	\$6,979.17	\$2,268.23	\$9,247.40
--------------	-------	------------	------------	------------

2026 Est. Expenses (NNNs)	\$2,268.23/MO (3.25/SF)			
---------------------------	-------------------------	--	--	--

YEAR BUILT / RENOVATED:	1971/2017			
-------------------------	-----------	--	--	--

ZONING:	LI			
---------	----	--	--	--

PARKING:	Perimeter of Building			
----------	-----------------------	--	--	--

- Large shell-warehouse space with 2, 12'x10' overhead doors
- 2,000 SF of additional mezzanine space
- NEW fire suppression throughout building

PROPERTY SUMMARY

DRIVE TIME - MINUTES:

	5 MIN	10 MIN	15 MIN
2024 Est. Population	15,476	89,385	270,063
2024 Est. HHs	7,032	40,513	118,066
2024 Est. Avg. HH Income	\$93,556	\$97,585	\$103,724

RADIUS - MILES:

	1 MILE	3 MILES	5 MILES
2024 Est. Population	11,459	87,379	247,666
2024 Est. HHs	5,124	39,281	108,701
2024 Est. Avg. HH Income	\$83,986	\$101,739	\$101,995

Source: Esri (2024), Esri-Data Axle, U.S. Census Bureau



Matt or Mike Craddock
 matt@craddockcommercial.com
 mike@craddockcommercial.com
719.630.2233 | craddockcommercial.com

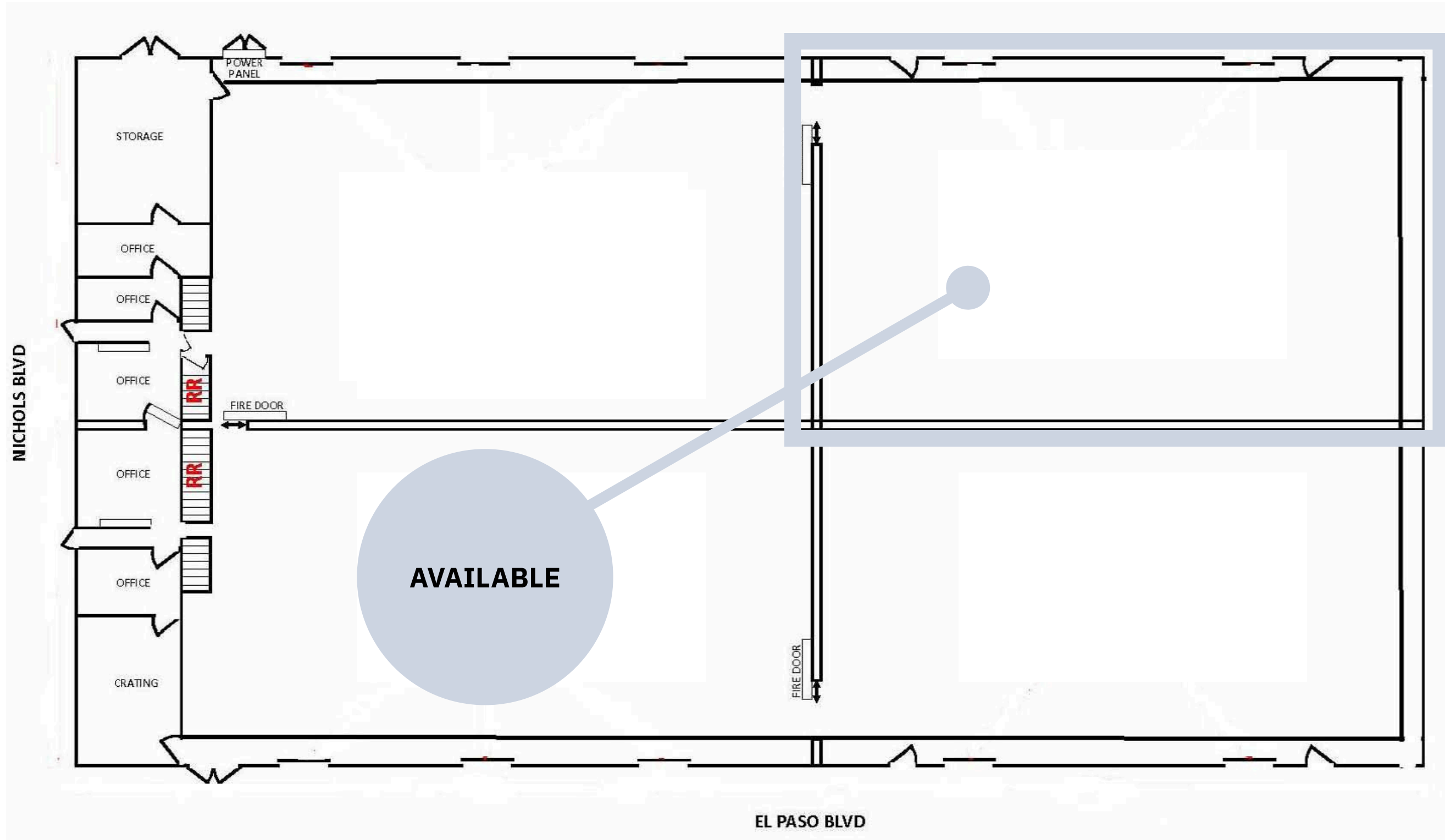

SURROUNDING AREA

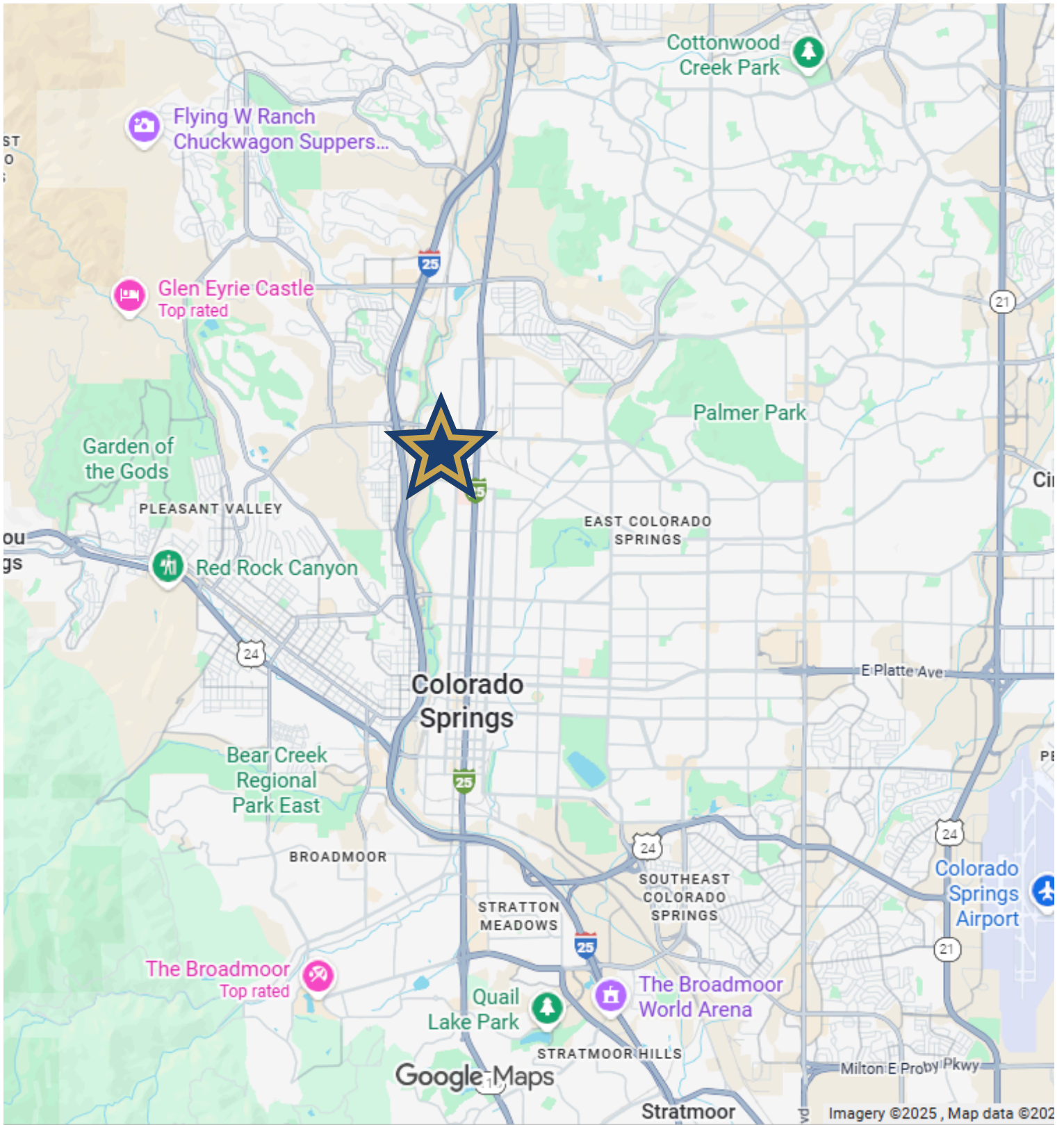

337 E. Pikes Peak Ave | Suite 200
Colorado Springs, CO 80903
719.630.2233 • craddockcommercial.com

Matt or Mike Craddock
matt@craddockcommercial.com
mike@craddockcommercial.com