

# NORTHWEST SERVICE CENTER



10625 NEWKIRK STREET, SUITE 100 | DALLAS, TEXAS 75220



## PROPERTY HIGHLIGHTS

- Total Building SF: 38,551 RSF
- Available SF: 3,466 SF
- Clear Height: 18'
- Year Built: 1984
- Ample Parking
- 120' Shared Truck Court
- Professionally Landscaped
- Fully Sprinklered
- 24/7 Security Monitoring
- Strong/Responsive Property Management

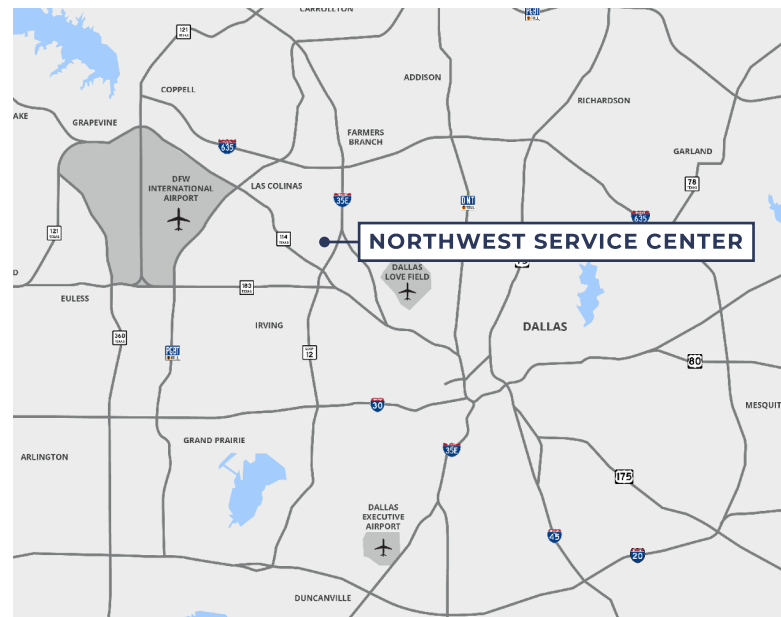

**JON SKIDMORE** | 214.442.8942 | [jskidmore@holtlunsford.com](mailto:jskidmore@holtlunsford.com)  
**LUKE FLOYD** | 972.585.5109 | [lfloyd@holtlunsford.com](mailto:lfloyd@holtlunsford.com)



This information is deemed reliable, however Holt Lunsford Commercial makes no guarantees, warranties or representation as to the completeness or accuracy thereof.

# NORTHWEST SERVICE CENTER



10625 NEWKIRK STREET, SUITE 100 | DALLAS, TEXAS 75220

## SPACE FEATURES

- One (1) Dock High Door
- 18' Clear Height
- Fully Sprinklered
- 100% Climate Controlled
- Ability to Build Out Office Pod

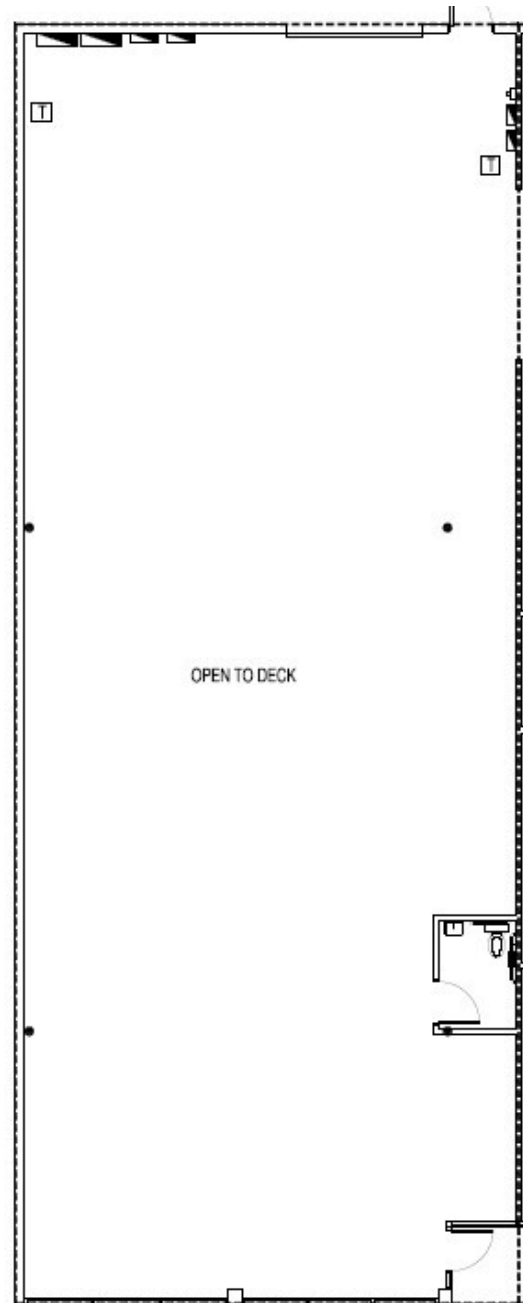

**JON SKIDMORE** | 214.442.8942 | [jskidmore@holtlunsford.com](mailto:jskidmore@holtlunsford.com)  
**LUKE FLOYD** | 972.585.5109 | [lfloyd@holtlunsford.com](mailto:lfloyd@holtlunsford.com)



This information is deemed reliable, however Holt Lunsford Commercial makes no guarantees, warranties or representation as to the completeness or accuracy thereof.

