



FOR LEASE

RESTAURANT/RETAIL

SOUTHWEST BAKERSFIELD

4625

MING AVENUE

BAKERSFIELD, CA 93309

PROPERTY HIGHLIGHTS

- Located in Southwest Bakersfield
- Prime Location
- Freestanding Retail Building
- Monument & Building signage available
- Possible Drive Through available
- Including hood-ventilation system, walk-in freezers, and coolers
- Abundant parking with 33 parking spaces
- Convenient access to the I-99, I-58 and all new crosstown freeways
- Strong Daily Traffic Counts - 32K Ming

4625 MING AVENUE

PROPERTY FEATURES

Building Size:	±5,098 SF
Parcel Number :	440-022-01-00-1
Land Area :	0.56 Acres / 24,238 SF
Zoning :	C-2
Parking :	7.04/1,000 SF
Frontage:	234' on Buckley Way, 360' on Ming Ave
Corridor :	SW Bakersfield
Occupancy :	0%
Asking Rent:	\$3.00/NNN

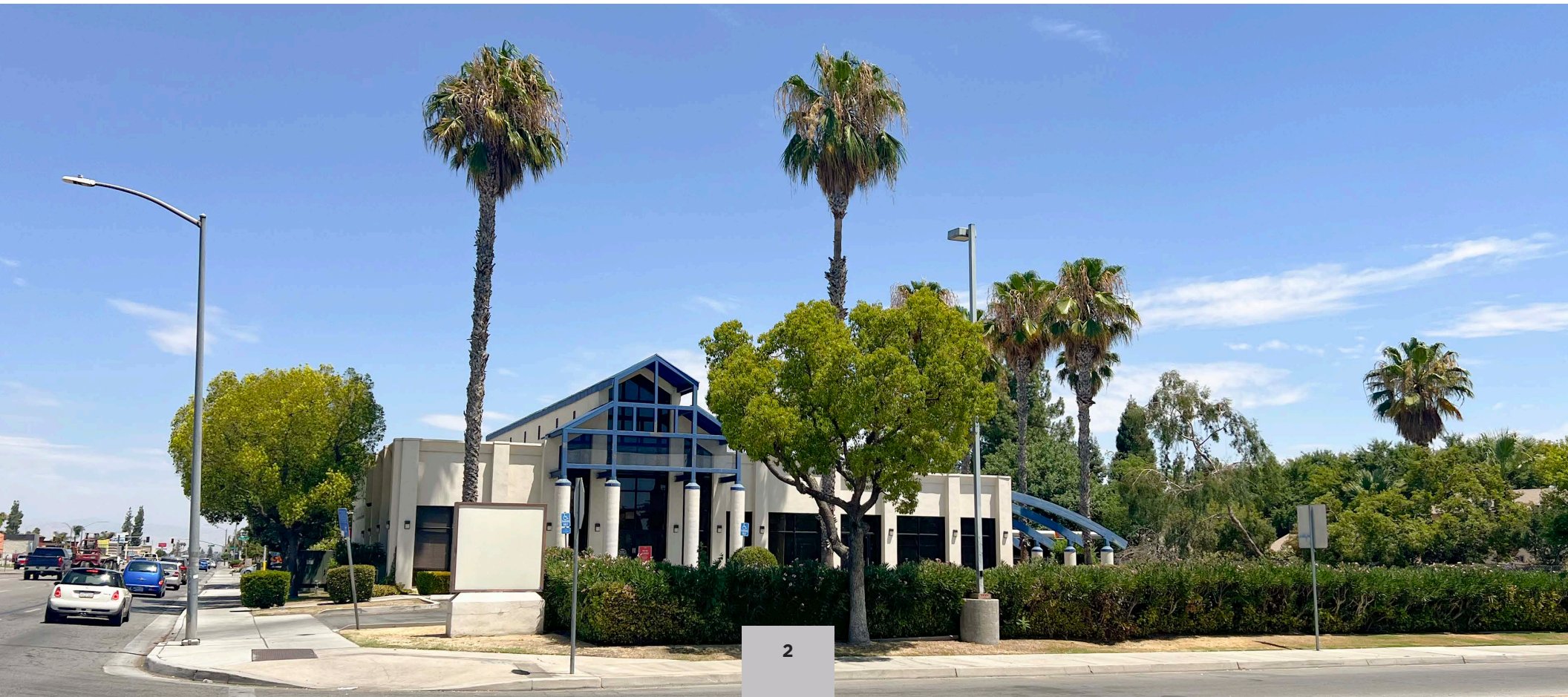

4625 MING AVENUE

FLOOR PLAN

±5,098 RSF
TOTAL AVAILABLE

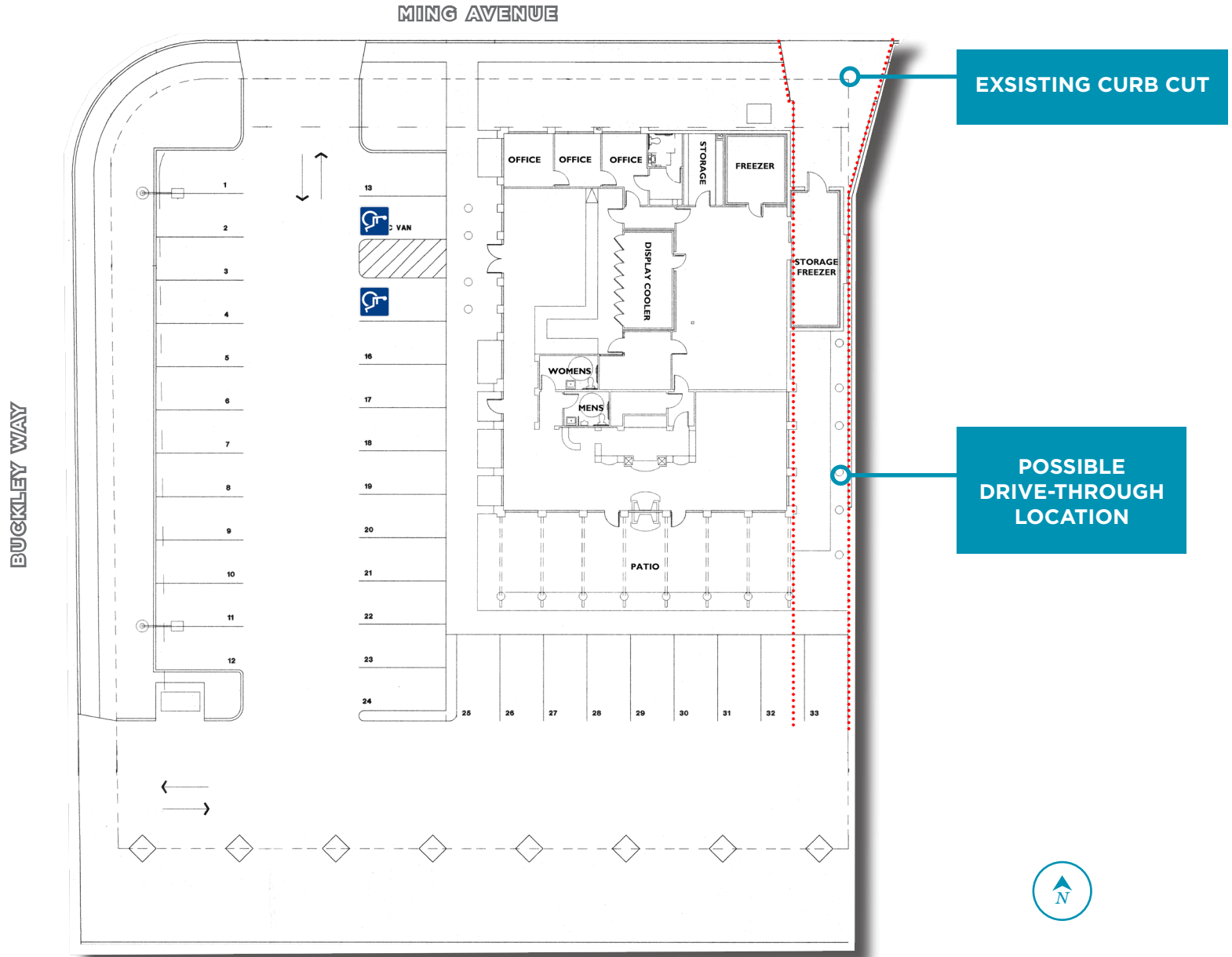





4625 MING AVENUE

AERIAL MAP



foodmaxx **Walgreens**
BioLife **AT&T**
Stanton OPTICAL **SKECHERS**

Chuck E. Cheese's **Quality Furniture**
Bank of America
carter's **SalonCentric**
O'Reilly AUTO PARTS
metro by T-Mobile **Guitar Center**
MattressLand & Furniture **TJ-maxx**

McDonald's **Panda Express** **Valley Strong Credit Union**

PETSMART **Wienerschnitzel** **DEL TACO** **THE SALVATION ARMY**

Mister Car Wash **TACO BELL** **golden corral** **Tacos La Villa MEXICAN GRILL**
Where Residents Eat **RESTAURANT PRO** **TACO BROS** **SONIC**

HUEVO HOUSE cafe **THE HONEY BEEHIVE**
MAUI PHO **PIZZA CO.**

STARBUCKS COFFEE **ROSS DRESS FOR LESS** **ups** **FASTrip**
LONG JOHN SILVERS **DriveTime** **DISCOUNTS** **DD'S DISCOUNTS** **Dunn Edwards PAINTS**
GameStop **CHASE**

24,431 VPD

31,085 VPD

22,369 VPD

50,417 VPD

157,328 VPD



**CUSHMAN &
WAKEFIELD**



CONTACT INFO

Jeff Andrew

Executive Director
+1 661 633 3827
jeff.andrew@cushwake.com
Lic. 00941323

Michael Piccirillo

Senior Associate
+1 661 645 2366
michael.piccirillo@cushwake.com
Lic. 02100320

5060 California Avenue
Suite 1000
Bakersfield, CA 93309
Lic. 01880493
cushmanwakefield.com

©2021 Cushman & Wakefield. All rights reserved. The information contained in this communication is strictly confidential. This information has been obtained from sources believed to be reliable but has not been verified. NO WARRANTY OR REPRESENTATION, EXPRESS OR IMPLIED, IS MADE AS TO THE CONDITION OF THE PROPERTY (OR PROPERTIES) REFERENCED HEREIN OR AS TO THE ACCURACY OR COMPLETENESS OF THE INFORMATION CONTAINED HEREIN, AND SAME IS SUBMITTED SUBJECT TO ERRORS, OMISSIONS, CHANGE OF PRICE, RENTAL OR OTHER CONDITIONS, WITHDRAWAL WITHOUT NOTICE, AND TO ANY SPECIAL LISTING CONDITIONS IMPOSED BY THE PROPERTY OWNER(S). ANY PROJECTIONS, OPINIONS OR ESTIMATES ARE SUBJECT TO UNCERTAINTY AND DO NOT SIGNIFY CURRENT OR FUTURE PROPERTY PERFORMANCE.