

GOLDFINGER STUDIOS - COMMERCIAL CONDOS FOR SALE

Goldfinger Studios is a series of dramatic spaces carved out of a renovated mid-century modern aluminum casting foundry. The building has been rezoned as "PUD" or Planned Unit Development -- Possible uses of the condos include office, woodworking shop, pottery studio, art studio, massage therapy, energy healing, etc. Some spaces will be used for collector car storage. Several would make dramatic Event Space.

The structure is an all masonry building with 20+ foot ceilings and rugged construction. Ceiling height allows room for mezzanines and car lifts. All condos are temperature-controlled. The location is ideal -- off the beaten path but not too secluded. In fact, it's walkable to Grafton's coffee shops, pizza parlors, bars and restaurants, and 3 minutes from the entrance to I-43. The property includes a large parking lot to the South of the property, as well as open park-like green space.

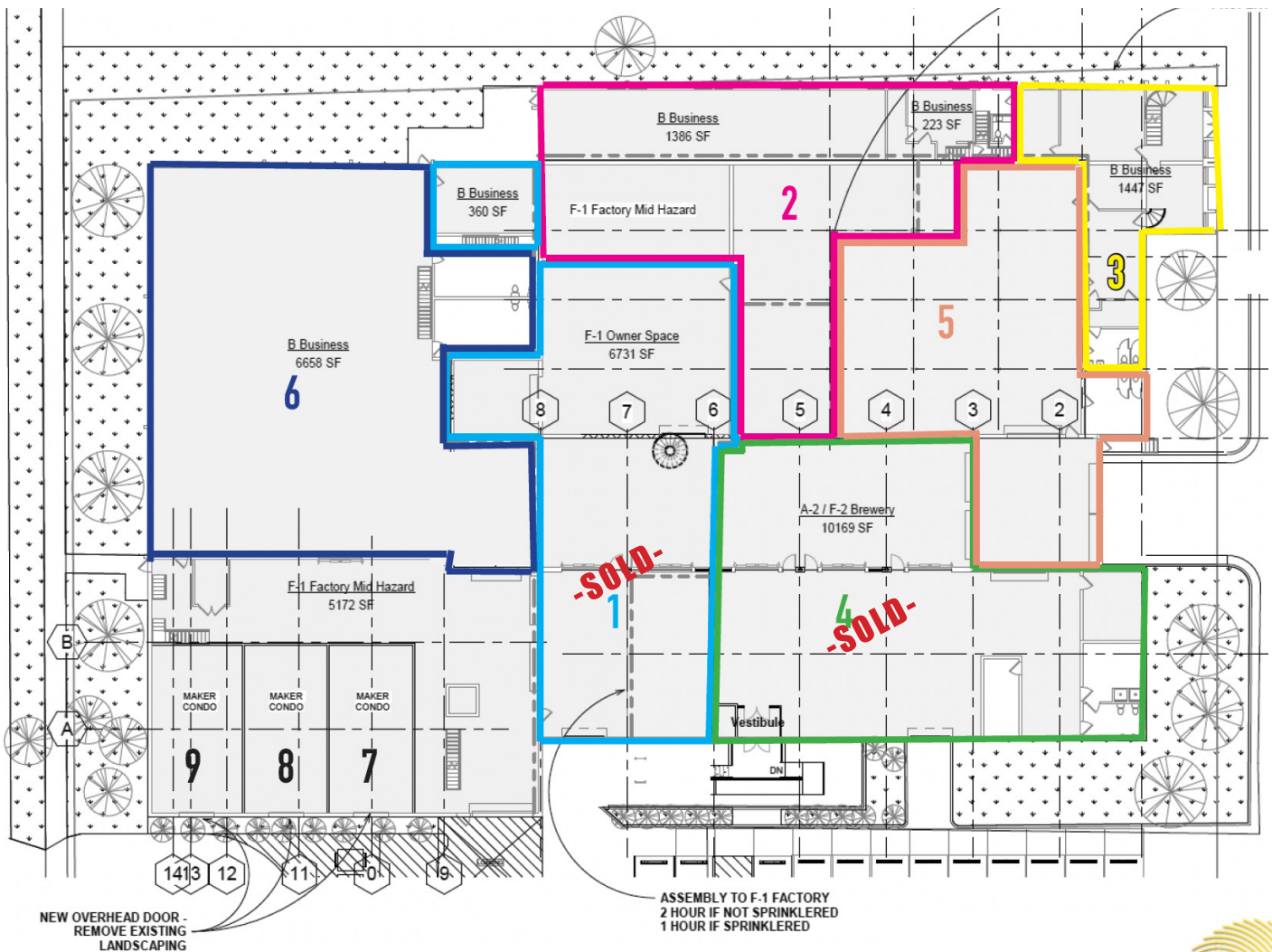

1411 6TH AVENUE, GRAFTON, WI 53024