



**OSPREY PLAZA**  
822-880 S TAMAMI TRL  
OSPREY, FLORIDA 34229

**PROPERTY HIGHLIGHTS**

- Fully renovated in 2025
- Flexible layouts for office, retail, or warehouse use
- Strong visibility and traffic on S Tamiami Trail
- Ample parking within the plaza
- Turnkey, move-in-ready spaces



DEMOGRAPHICS	0.3 MILES	0.5 MILES	1 MILE
Total Households	314	825	2,026
Total Population	586	1,617	4,142
Average HH Income	\$122,081	\$128,655	\$140,384

For More Information  
**MARCIA CUTTLER**  
Agent/Associate  
941 923 0535 x308  
marcia@americanpropertygroup.com

# OSPREY PLAZA



## OFFERING SUMMARY

Lease Rate:	\$15 - 17.50 SF/yr (MG)
Building Size:	19,480 SF
Available SF:	1,750 - 2,750 SF
Lot Size:	57,154 SF
Year Built:	1973
Renovated:	2025
Zoning:	CI

## PROPERTY OVERVIEW

American Property Group of Sarasota, Inc. presents 822-880 S Tamiami Trail, Osprey, FL

Property Type: Office/Retail/Warehouse

Property Size: Multiple Units Available

Osprey Plaza offers multiple spaces for lease in a recently renovated plaza (2025) featuring a new roof, HVAC, ceilings, flooring, walls, and a freshly painted exterior. Tenants enjoy a modern, move-in-ready environment in a highly visible location on busy S Tamiami Trail in the heart of Osprey.

Available Units:

846 - 1,750 SF Office/Retail Space (\$17.50 SF/yr MG | \$2,552/month MG)

880 - 2,750 SF Warehouse Space (\$15 SF/yr MG | \$3,437/month MG)

## MARCIA CUTTLER

Agent/Associate  
941.923.0535 x308  
marcia@americanpropertygroup.com



# OSPREY PLAZA

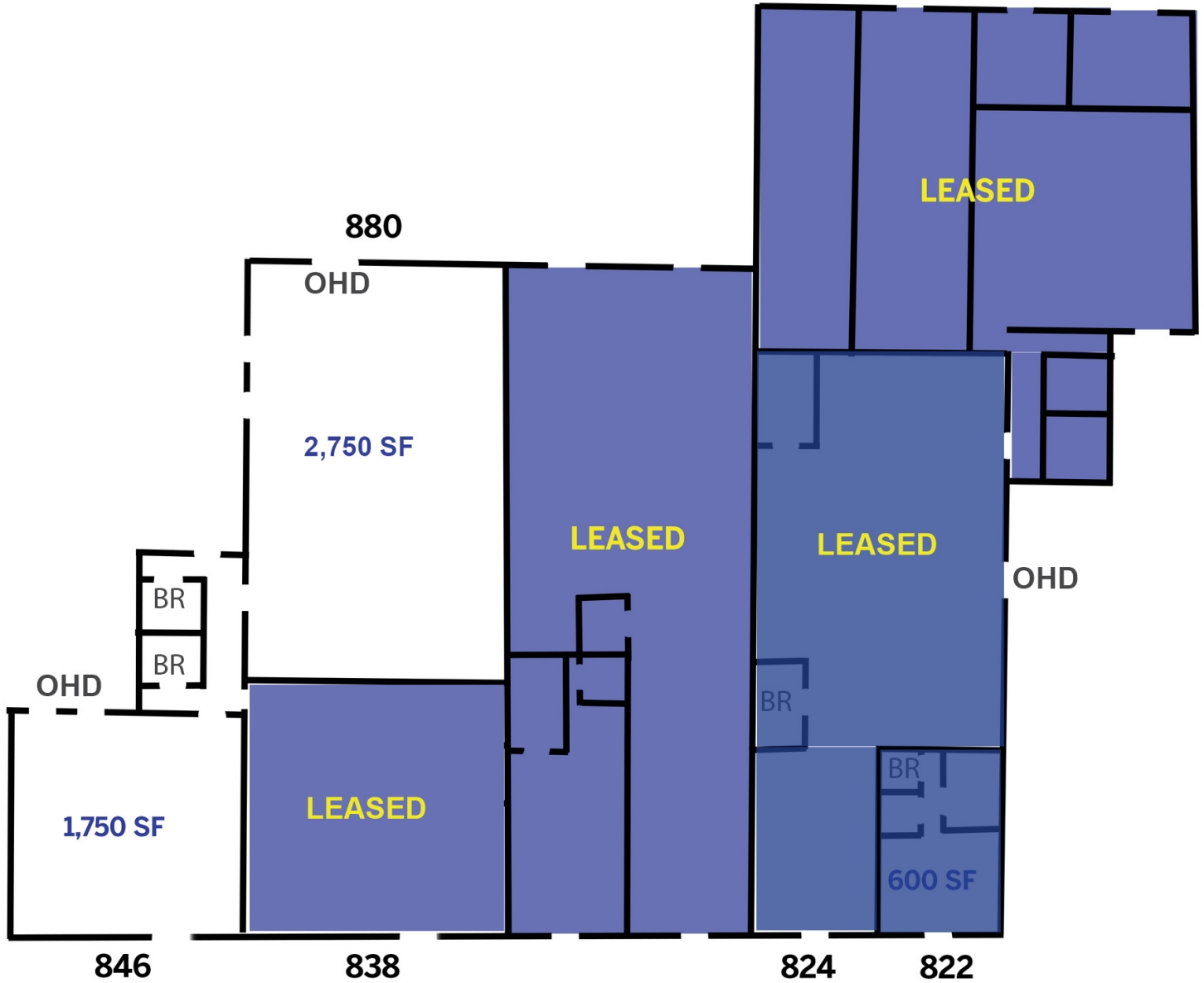

**MARCIA CUTTLER**  
Agent/Associate  
941.923.0535 x308  
marcia@americanpropertygroup.com

**AMERICAN  
PROPERTY GROUP**  
OF SARASOTA, INC.

# 846 S TAMIAMI TRAIL - 1,750 SF



**MARCIA CUTTLER**

Agent/Associate  
941.923.0535 x308  
marcia@americanpropertygroup.com

**AMERICAN  
PROPERTY GROUP**  
OF SARASOTA, INC.

# 880 S TAMIAMI TRL - 2,750 SF



**MARCIA CUTTLER**

Agent/Associate  
941.923.0535 x308  
marcia@americanpropertygroup.com

**AMERICAN  
PROPERTY GROUP**  
OF SARASOTA, INC.

# OSPREY PLAZA

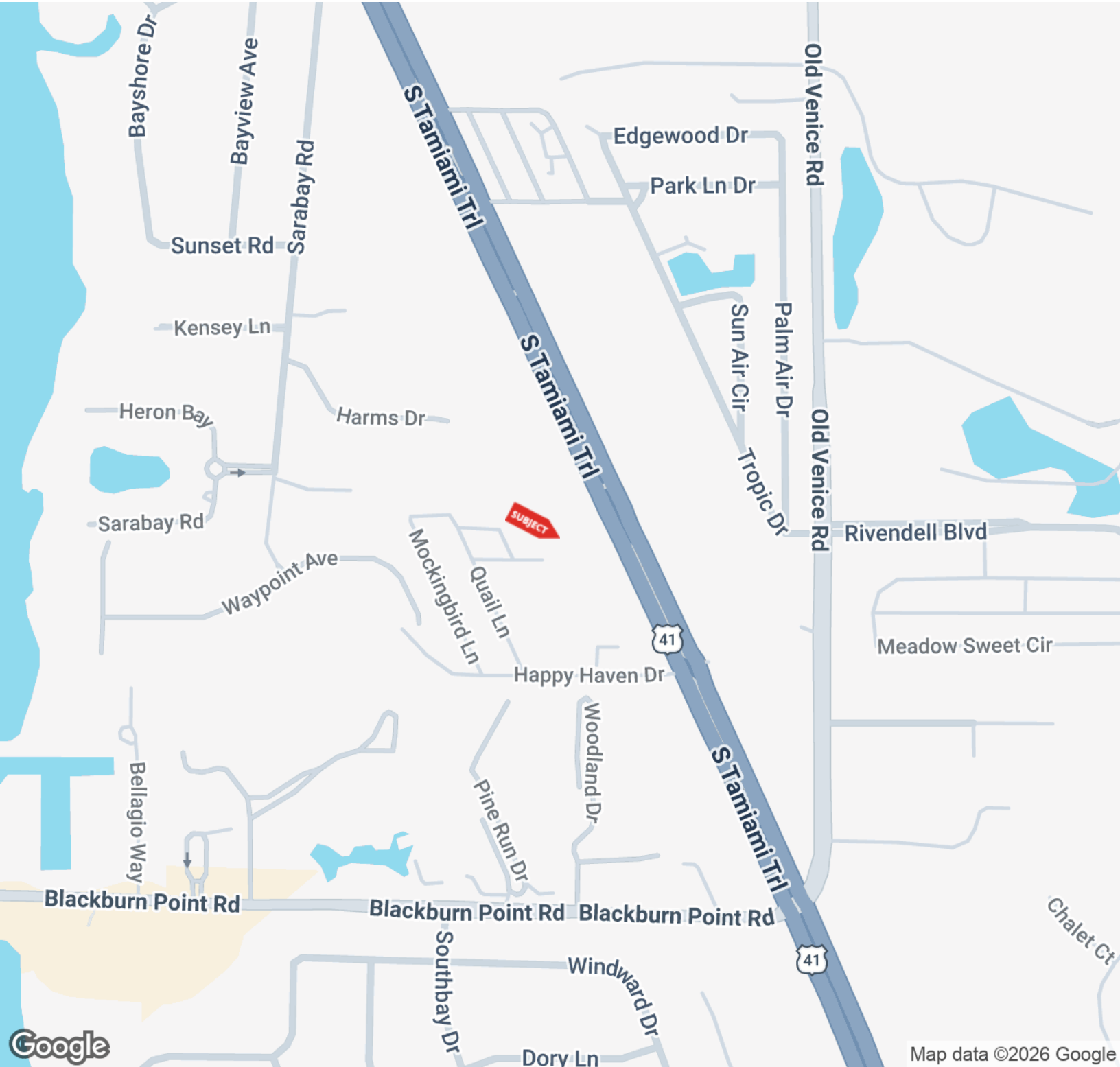

**MARCIA CUTTLER**

Agent/Associate  
941.923.0535 x308  
marcia@americanpropertygroup.com

**AMERICAN  
PROPERTY GROUP**  
OF SARASOTA, INC.

# OSPREY PLAZA

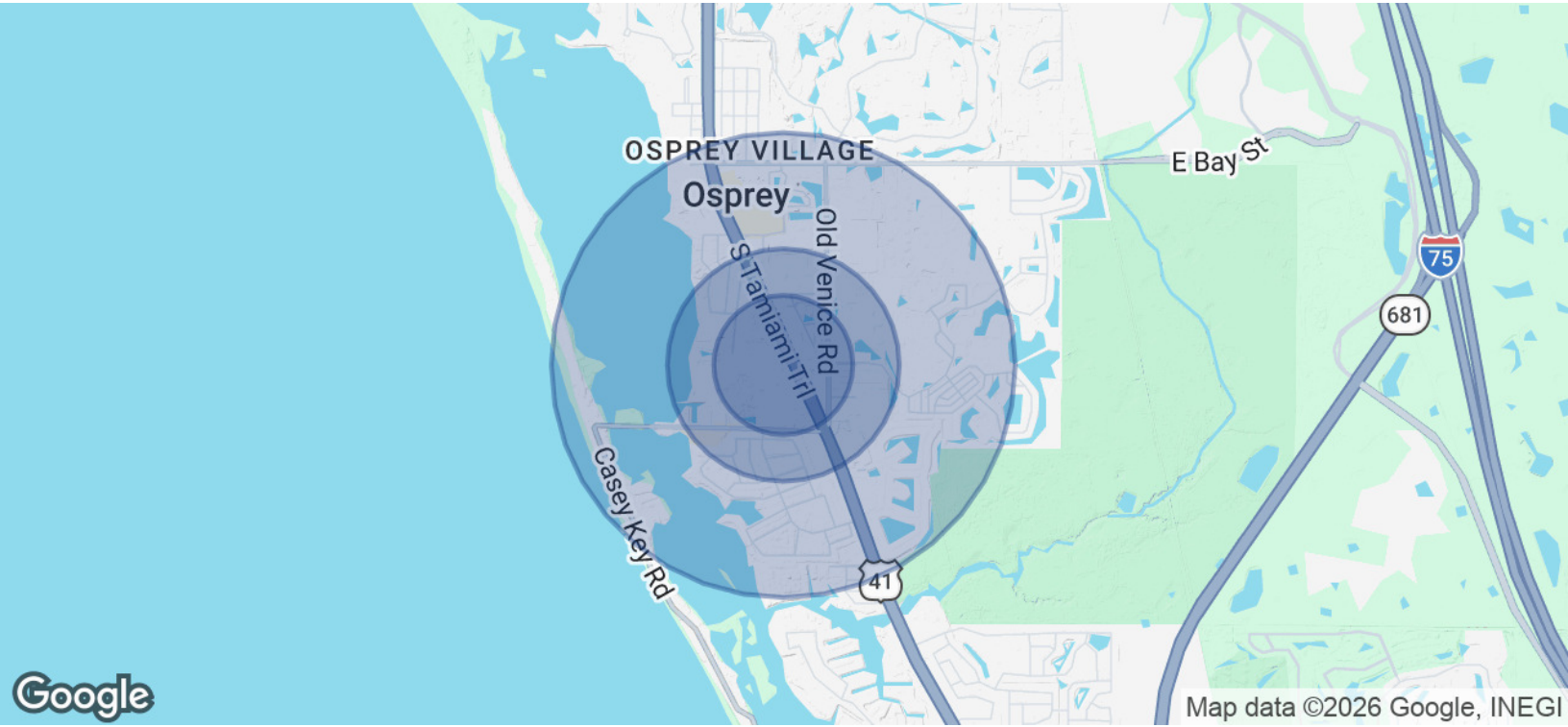

## POPULATION

	0.3 MILES	0.5 MILES	1 MILE
Total Population	586	1,617	4,142
Average Age	63	62	61
Average Age (Male)	63	62	61
Average Age (Female)	63	62	61

## HOUSEHOLDS & INCOME

	0.3 MILES	0.5 MILES	1 MILE
Total Households	314	825	2,026
# of Persons per HH	1.9	2	2
Average HH Income	\$122,081	\$128,655	\$140,384
Average House Value	\$665,878	\$711,154	\$754,441

2020 American Community Survey (ACS)

### MARCIA CUTTLER

Agent/Associate  
 941.923.0535 x308  
 marcia@americanpropertygroup.com

