

NOTICE: These drawings are prepared by Ellipses Design, Inc. and are not to be used for any other purpose without the written consent of Ellipses Design, Inc. The user assumes all liability for any errors or omissions in these drawings and any consequences thereof.

DATE	
NO.	
BY	
CHKD	
APP'D	
SCALE	

BAOBAB
ARCHITECTS P.C.

200 W. PALOWA
AVENUE
ANAHEIM, CA
92801-1174
TEL: 714.771.1174
WWW.BAOBABARCHITECTS.COM

1733 CONEY ISLAND AVENUE, BRIDGEVIEW, CA 94605

ZONING DIAGRAMS

7-004.00

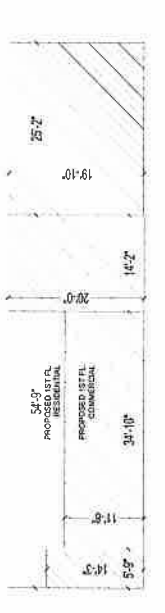

PROPOSED 1ST FLOOR AREA CALCULATION

AREA	WIDTH (FEET)	LENGTH (FEET)	AREA (SQ FT)
1	17	8	136
2	8	19	152
3	15	10	150
4	15	10	150
5	15	10	150
6	15	10	150
7	15	10	150
8	15	10	150
9	15	10	150
10	15	10	150
11	15	10	150
12	15	10	150
13	15	10	150
14	15	10	150
15	15	10	150
16	15	10	150
17	15	10	150
18	15	10	150
19	15	10	150
20	15	10	150
21	15	10	150
22	15	10	150
23	15	10	150
24	15	10	150
25	15	10	150
26	15	10	150
27	15	10	150
28	15	10	150
29	15	10	150
30	15	10	150
31	15	10	150
32	15	10	150
33	15	10	150
34	15	10	150
35	15	10	150
36	15	10	150
37	15	10	150
38	15	10	150
39	15	10	150
40	15	10	150
41	15	10	150
42	15	10	150
43	15	10	150
44	15	10	150
45	15	10	150
46	15	10	150
47	15	10	150
48	15	10	150
49	15	10	150
50	15	10	150
51	15	10	150
52	15	10	150
53	15	10	150
54	15	10	150
55	15	10	150
56	15	10	150
57	15	10	150
58	15	10	150
59	15	10	150
60	15	10	150
61	15	10	150
62	15	10	150
63	15	10	150
64	15	10	150
65	15	10	150
66	15	10	150
67	15	10	150
68	15	10	150
69	15	10	150
70	15	10	150
71	15	10	150
72	15	10	150
73	15	10	150
74	15	10	150
75	15	10	150
76	15	10	150
77	15	10	150
78	15	10	150
79	15	10	150
80	15	10	150
81	15	10	150
82	15	10	150
83	15	10	150
84	15	10	150
85	15	10	150
86	15	10	150
87	15	10	150
88	15	10	150
89	15	10	150
90	15	10	150
91	15	10	150
92	15	10	150
93	15	10	150
94	15	10	150
95	15	10	150
96	15	10	150
97	15	10	150
98	15	10	150
99	15	10	150
100	15	10	150
TOTAL			3600

PROPOSED 2ND FLOOR AREA CALCULATION

AREA	WIDTH (FEET)	LENGTH (FEET)	AREA (SQ FT)
1	17	8	136
2	8	19	152
3	15	10	150
4	15	10	150
5	15	10	150
6	15	10	150
7	15	10	150
8	15	10	150
9	15	10	150
10	15	10	150
11	15	10	150
12	15	10	150
13	15	10	150
14	15	10	150
15	15	10	150
16	15	10	150
17	15	10	150
18	15	10	150
19	15	10	150
20	15	10	150
21	15	10	150
22	15	10	150
23	15	10	150
24	15	10	150
25	15	10	150
26	15	10	150
27	15	10	150
28	15	10	150
29	15	10	150
30	15	10	150
31	15	10	150
32	15	10	150
33	15	10	150
34	15	10	150
35	15	10	150
36	15	10	150
37	15	10	150
38	15	10	150
39	15	10	150
40	15	10	150
41	15	10	150
42	15	10	150
43	15	10	150
44	15	10	150
45	15	10	150
46	15	10	150
47	15	10	150
48	15	10	150
49	15	10	150
50	15	10	150
51	15	10	150
52	15	10	150
53	15	10	150
54	15	10	150
55	15	10	150
56	15	10	150
57	15	10	150
58	15	10	150
59	15	10	150
60	15	10	150
61	15	10	150
62	15	10	150
63	15	10	150
64	15	10	150
65	15	10	150
66	15	10	150
67	15	10	150
68	15	10	150
69	15	10	150
70	15	10	150
71	15	10	150
72	15	10	150
73	15	10	150
74	15	10	150
75	15	10	150
76	15	10	150
77	15	10	150
78	15	10	150
79	15	10	150
80	15	10	150
81	15	10	150
82	15	10	150
83	15	10	150
84	15	10	150
85	15	10	150
86	15	10	150
87	15	10	150
88	15	10	150
89	15	10	150
90	15	10	150
91	15	10	150
92	15	10	150
93	15	10	150
94	15	10	150
95	15	10	150
96	15	10	150
97	15	10	150
98	15	10	150
99	15	10	150
100	15	10	150
TOTAL			3600

PROPOSED 1ST FLOOR REZONING AREA CALCULATION

AREA	WIDTH (FEET)	LENGTH (FEET)	AREA (SQ FT)
1	17	8	136
2	8	19	152
3	15	10	150
4	15	10	150
5	15	10	150
6	15	10	150
7	15	10	150
8	15	10	150
9	15	10	150
10	15	10	150
11	15	10	150
12	15	10	150
13	15	10	150
14	15	10	150
15	15	10	150
16	15	10	150
17	15	10	150
18	15	10	150
19	15	10	150
20	15	10	150
21	15	10	150
22	15	10	150
23	15	10	150
24	15	10	150
25	15	10	150
26	15	10	150
27	15	10	150
28	15	10	150
29	15	10	150
30	15	10	150
31	15	10	150
32	15	10	150
33	15	10	150
34	15	10	150
35	15	10	150
36	15	10	150
37	15	10	150
38	15	10	150
39	15	10	150
40	15	10	150
41	15	10	150
42	15	10	150
43	15	10	150
44	15	10	150
45	15	10	150
46	15	10	150
47	15	10	150
48	15	10	150
49	15	10	150
50	15	10	150
51	15	10	150
52	15	10	150
53	15	10	150
54	15	10	150
55	15	10	150
56	15	10	150
57	15	10	150
58	15	10	150
59	15	10	150
60	15	10	150
61	15	10	150
62	15	10	150
63	15	10	150
64	15	10	150
65	15	10	150
66	15	10	150
67	15	10	150
68	15	10	150
69	15	10	150
70	15	10	150
71	15	10	150
72	15	10	150
73	15	10	150
74	15	10	150
75	15	10	150
76	15	10	150
77	15	10	150
78	15	10	150
79	15	10	150
80	15	10	150
81	15	10	150
82	15	10	150
83	15	10	150
84	15	10	150
85	15	10	150
86	15	10	150
87	15	10	150
88	15	10	150
89	15	10	150
90	15	10	150
91	15	10	150
92	15	10	150
93	15	10	150
94	15	10	150
95	15	10	150
96	15	10	150
97	15	10	150
98	15	10	150
99	15	10	150
100	15	10	150
TOTAL			3600

NOTES: 1. Verify the proposed area of the rezoning is within the boundaries of the rezoning area. 2. Verify the proposed area of the rezoning is within the boundaries of the rezoning area. 3. Verify the proposed area of the rezoning is within the boundaries of the rezoning area. 4. Verify the proposed area of the rezoning is within the boundaries of the rezoning area. 5. Verify the proposed area of the rezoning is within the boundaries of the rezoning area. 6. Verify the proposed area of the rezoning is within the boundaries of the rezoning area. 7. Verify the proposed area of the rezoning is within the boundaries of the rezoning area. 8. Verify the proposed area of the rezoning is within the boundaries of the rezoning area. 9. Verify the proposed area of the rezoning is within the boundaries of the rezoning area. 10. Verify the proposed area of the rezoning is within the boundaries of the rezoning area. 11. Verify the proposed area of the rezoning is within the boundaries of the rezoning area. 12. Verify the proposed area of the rezoning is within the boundaries of the rezoning area. 13. Verify the proposed area of the rezoning is within the boundaries of the rezoning area. 14. Verify the proposed area of the rezoning is within the boundaries of the rezoning area. 15. Verify the proposed area of the rezoning is within the boundaries of the rezoning area. 16. Verify the proposed area of the rezoning is within the boundaries of the rezoning area. 17. Verify the proposed area of the rezoning is within the boundaries of the rezoning area. 18. Verify the proposed area of the rezoning is within the boundaries of the rezoning area. 19. Verify the proposed area of the rezoning is within the boundaries of the rezoning area. 20. Verify the proposed area of the rezoning is within the boundaries of the rezoning area. 21. Verify the proposed area of the rezoning is within the boundaries of the rezoning area. 22. Verify the proposed area of the rezoning is within the boundaries of the rezoning area. 23. Verify the proposed area of the rezoning is within the boundaries of the rezoning area. 24. Verify the proposed area of the rezoning is within the boundaries of the rezoning area. 25. Verify the proposed area of the rezoning is within the boundaries of the rezoning area. 26. Verify the proposed area of the rezoning is within the boundaries of the rezoning area. 27. Verify the proposed area of the rezoning is within the boundaries of the rezoning area. 28. Verify the proposed area of the rezoning is within the boundaries of the rezoning area. 29. Verify the proposed area of the rezoning is within the boundaries of the rezoning area. 30. Verify the proposed area of the rezoning is within the boundaries of the rezoning area. 31. Verify the proposed area of the rezoning is within the boundaries of the rezoning area. 32. Verify the proposed area of the rezoning is within the boundaries of the rezoning area. 33. Verify the proposed area of the rezoning is within the boundaries of the rezoning area. 34. Verify the proposed area of the rezoning is within the boundaries of the rezoning area. 35. Verify the proposed area of the rezoning is



NO. 1	NO. 2	NO. 3	NO. 4	NO. 5	NO. 6	NO. 7	NO. 8	NO. 9	NO. 10

BAOBAB
ARCHITECTS P.C.

1730 CONY
ISLAND
AVENUE
BROOKLYN
NY 11220



PROJECT
1730 CONY
ISLAND
AVENUE
BROOKLYN
NY 11220

WALL DETAILS

DATE	NO.	DESCRIPTION

A-007.00

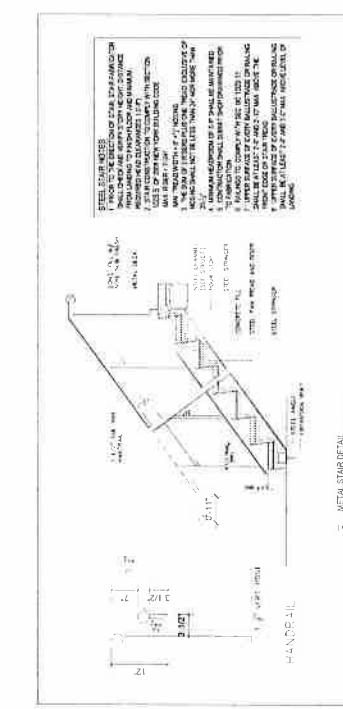

SCALE 1/4"=1'-0"

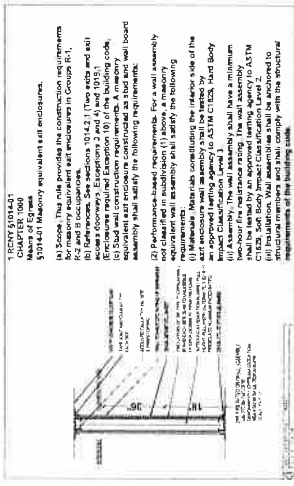

SCALE 1/4"=1'-0"



SCALE 3/4"=1'-0"

SCALE 3/4"=1'-0"

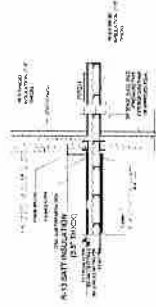

SCALE 3/4"=1'-0"

SCALE 3/4"=1'-0"

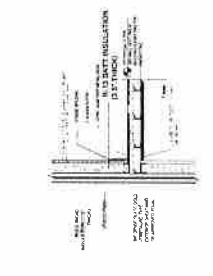

SCALE 3/4"=1'-0"

SCALE 3/4"=1'-0"

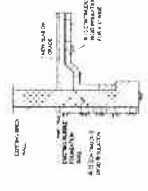

SCALE 3/4"=1'-0"

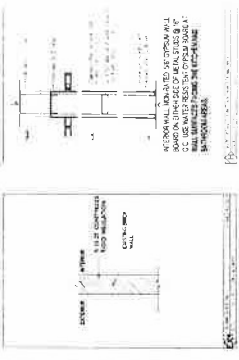
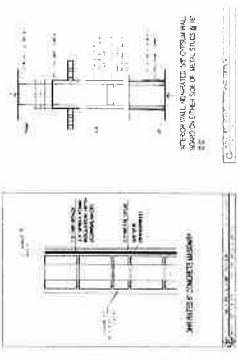
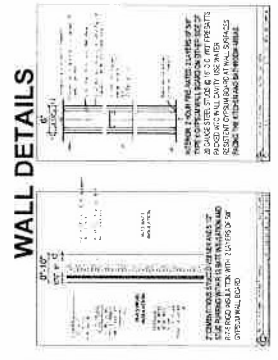

AIR SEALING NOTES AND PRICES

BULKHEAD OR AIR SEALING ALTERNATIVE CONSIDERING AN ASB SUBSTITUTION...
 1. BULKHEAD OR AIR SEALING ALTERNATIVE CONSIDERING AN ASB SUBSTITUTION...
 2. BULKHEAD OR AIR SEALING ALTERNATIVE CONSIDERING AN ASB SUBSTITUTION...
 3. BULKHEAD OR AIR SEALING ALTERNATIVE CONSIDERING AN ASB SUBSTITUTION...
 4. BULKHEAD OR AIR SEALING ALTERNATIVE CONSIDERING AN ASB SUBSTITUTION...
 5. BULKHEAD OR AIR SEALING ALTERNATIVE CONSIDERING AN ASB SUBSTITUTION...
 6. BULKHEAD OR AIR SEALING ALTERNATIVE CONSIDERING AN ASB SUBSTITUTION...
 7. BULKHEAD OR AIR SEALING ALTERNATIVE CONSIDERING AN ASB SUBSTITUTION...
 8. BULKHEAD OR AIR SEALING ALTERNATIVE CONSIDERING AN ASB SUBSTITUTION...
 9. BULKHEAD OR AIR SEALING ALTERNATIVE CONSIDERING AN ASB SUBSTITUTION...
 10. BULKHEAD OR AIR SEALING ALTERNATIVE CONSIDERING AN ASB SUBSTITUTION...

AIR SEALING NOTES AND PRICES

BULKHEAD OR AIR SEALING ALTERNATIVE CONSIDERING AN ASB SUBSTITUTION...
 1. BULKHEAD OR AIR SEALING ALTERNATIVE CONSIDERING AN ASB SUBSTITUTION...
 2. BULKHEAD OR AIR SEALING ALTERNATIVE CONSIDERING AN ASB SUBSTITUTION...
 3. BULKHEAD OR AIR SEALING ALTERNATIVE CONSIDERING AN ASB SUBSTITUTION...
 4. BULKHEAD OR AIR SEALING ALTERNATIVE CONSIDERING AN ASB SUBSTITUTION...
 5. BULKHEAD OR AIR SEALING ALTERNATIVE CONSIDERING AN ASB SUBSTITUTION...
 6. BULKHEAD OR AIR SEALING ALTERNATIVE CONSIDERING AN ASB SUBSTITUTION...
 7. BULKHEAD OR AIR SEALING ALTERNATIVE CONSIDERING AN ASB SUBSTITUTION...
 8. BULKHEAD OR AIR SEALING ALTERNATIVE CONSIDERING AN ASB SUBSTITUTION...
 9. BULKHEAD OR AIR SEALING ALTERNATIVE CONSIDERING AN ASB SUBSTITUTION...
 10. BULKHEAD OR AIR SEALING ALTERNATIVE CONSIDERING AN ASB SUBSTITUTION...

DCR NOW JOB # B0052 34-H

