

The logo for NAI Commercial, featuring the letters 'NAI' in a bold, sans-serif font with a red triangle to the left of the 'A', followed by the word 'Commercial' in a smaller, black, sans-serif font.

NAICommercial

A blue diagonal banner with white text that reads '238 SF PRIVATE OFFICE'.

**238 SF
PRIVATE OFFICE**



Unit 302 - 938 Howe Street | Vancouver, BC

FOR LEASE

Located mid-block between Smithe and Nelson Street, 938 Howe Street is well located next to the courthouse and walking distance from Skytrain, Pacific Centre, Robson Square, Yaletown, and the Granville and Cambie bridges.

Brian Mackenzie
Vice President, Leasing & Sales
604 691 6618
bmackenzie@naicommercial.ca

NAI Commercial
1075 W Georgia St, Suite 1300
Vancouver, BC V6E 3C9
+1 604 683 7535
naicommercial.ca

Unit 302 - 938 Howe Street Vancouver, BC

Improvements

All open plan, plenty of windows facing east.

Amenities

- ▶ Concierge service
- ▶ Common coffee room
- ▶ Common boardrooms on each floor

Available Area
238 SF of actual area

Parking
One stall (#95) is available for rent at \$250 per stall plus taxes

Gross Monthly Rent
\$1,150 per month plus GST

Floor Plan

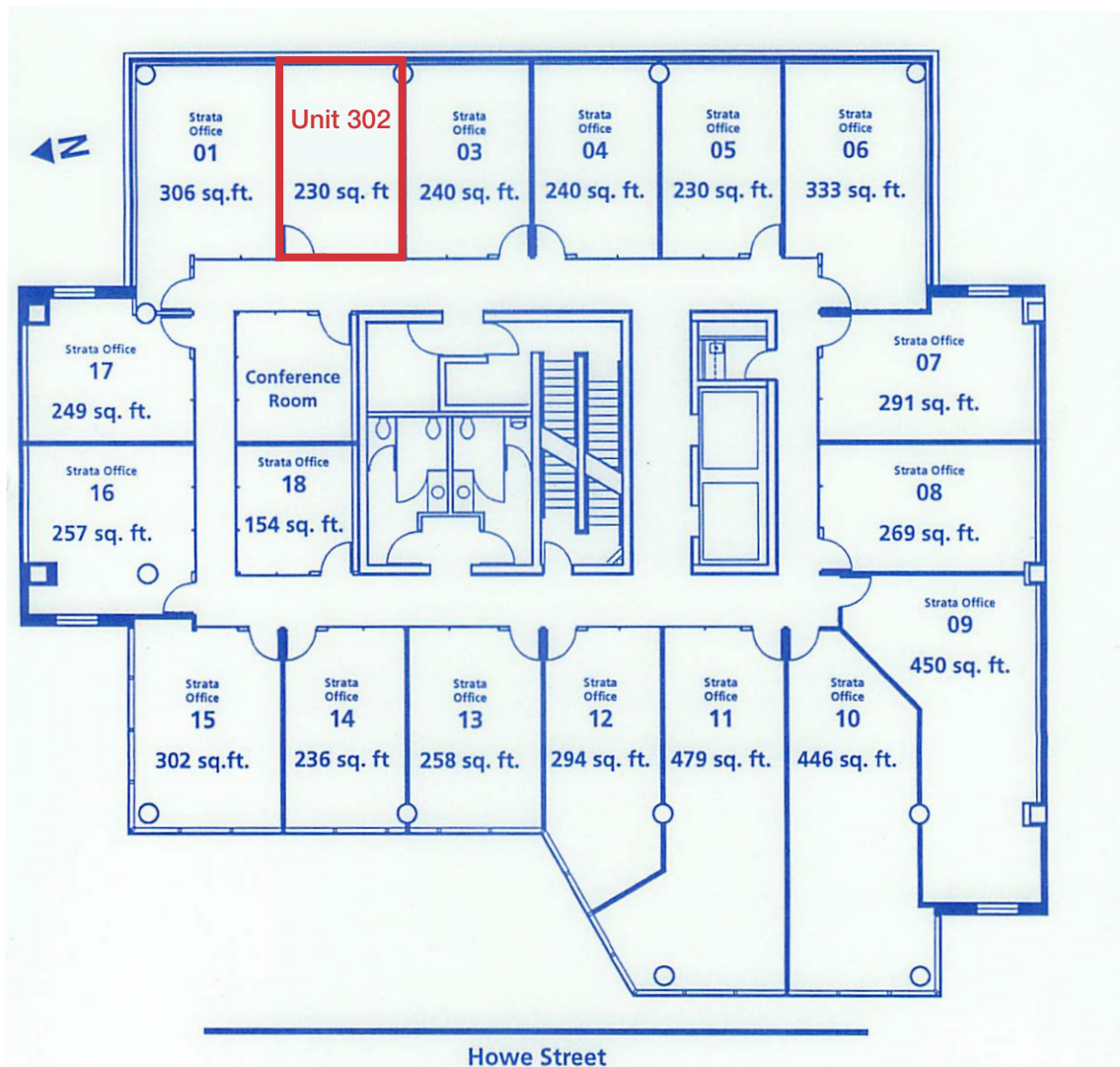



OPEN PLAN



COMMON BOARDROOM



COMMON KITCHEN





BC PLACE

Stadium-Chinatown

Granville

Vancouver City Centre

Burrard

SUBJECT PROPERTY

HOWE ST

Courthouse

99

Brian Mackenzie
Vice President Leasing & Sales
604 691 6618
bmackenzie@naicommercial.ca

NAICommercial

No warranty or representation, express or implied, is made as to the accuracy of the information contained herein, and the same is submitted subject to errors, omissions, change of price, rental or other conditions, prior sale, lease or financing, or withdrawal without notice, and of any special listing conditions imposed by our principals no warranties or representations are made as to the condition of the property or any hazards contained therein are any to be implied. Aerial image(s) courtesy of Google, Landsat/Copernicus

NAI Commercial
1075 W Georgia St, Suite 1300
Vancouver, BC V6E 3C9
+1 604 683 7535
naicommercial.ca