

B & A Tower Center

“The BAT”
COMING SOON!

1515 Broadway | Sacramento



RETAIL SPACE IN THE HEART OF TOWER DISTRICT

NEWMARK

DEVON ATLEE

916-569-2336

devon.atlee@nrmk.com

CA RE License #00944128

CHANDLER EDEN

916-569-2380

chandler.eden@nrmk.com

CA RE License #02081848

THE
TOWER
DISTRICT

GREATER BROADWAY
MANAGEMENT DISTRICT PLAN



PROPERTY OVERVIEW:

The Former B of A building is now available for lease. The project is seeking 2 to 3 complimentary retailers to backfill this iconic $\pm 9,664$ RSF building. This 74-year old building has an old bank vault and is overparked with 38 on-site spaces. Extensive remodeling to be completed by the end of 2026 with occupancy in early 2027. Contact Chandler Eden or Devon Atlee for more information or to schedule a tour.

HIGHLIGHTS:

- Bank Building
- End Cap Restaurant Space Available with Potential for Outdoor Dining
- Located at the High Traffic Corner of Broadway and 15th St. which are two of the main thoroughfares through Downtown and Midtown Sacramento
- Easy Access to Freeway
- 38 On-Site Parking Spaces

Building renderings forthcoming

POTENTIAL NEW FAÇADE



NEWMARK

THE BAT | 1515 BROADWAY | SACRAMENTO

POTENTIAL NEW FAÇADE



RESTAURANT

GYMNASIUM

NEWMARK

THE BAT | 1515 BROADWAY | SACRAMENTO

B & A Tower Center

“The BAT”

1515 Broadway | Sacramento

SITE PLAN

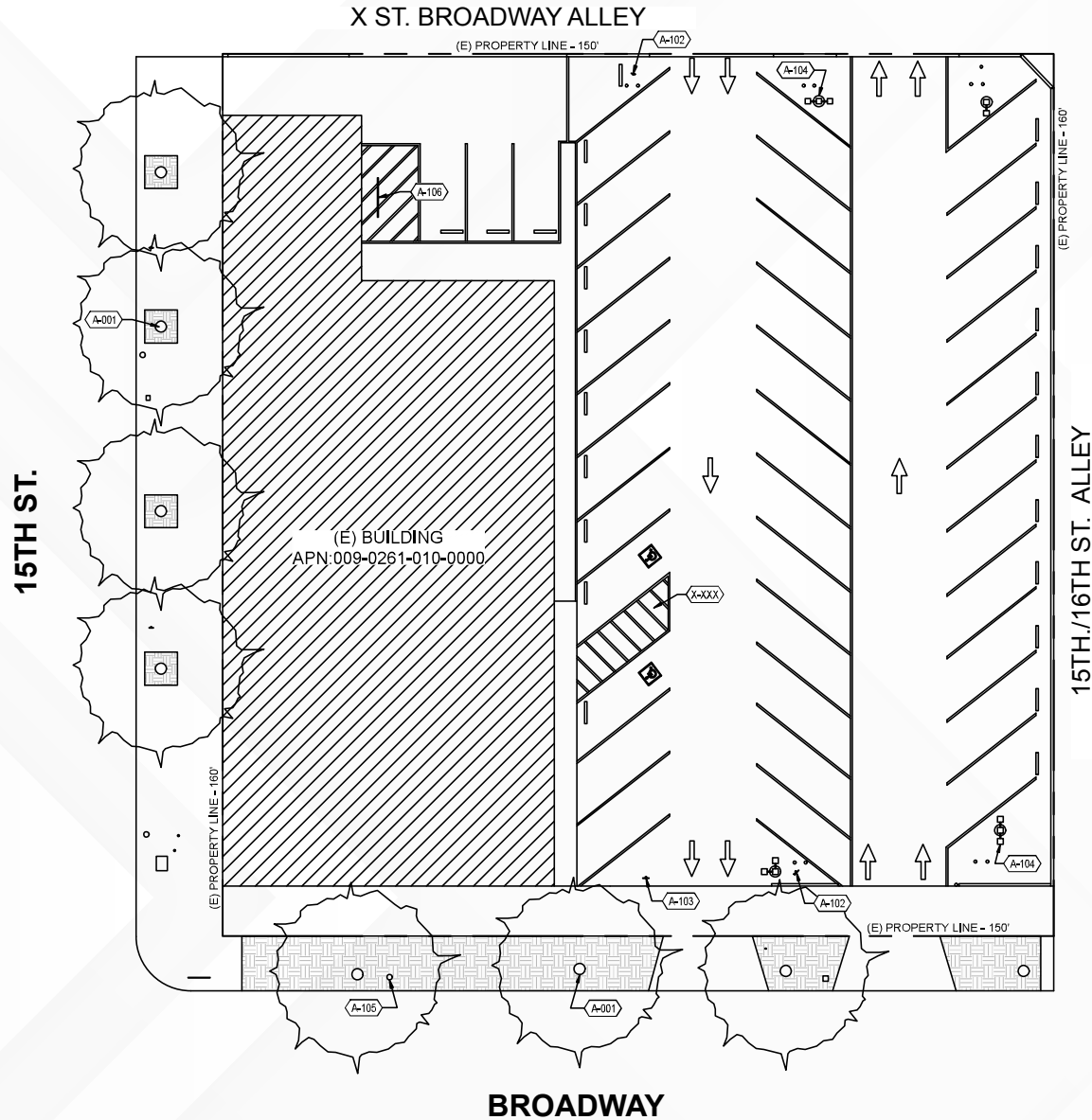

NEWMARK

B & A Tower Center

“The BAT”

1515 Broadway | Sacramento

FLOOR PLAN & SIZE POTENTIAL

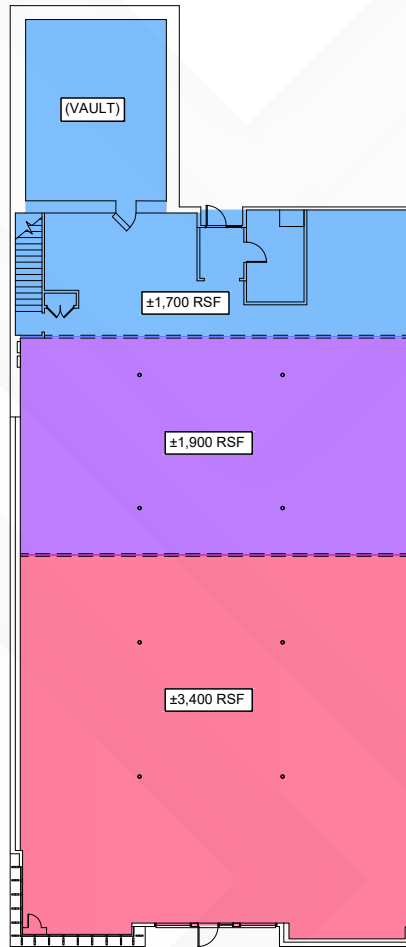

1ST FLOOR

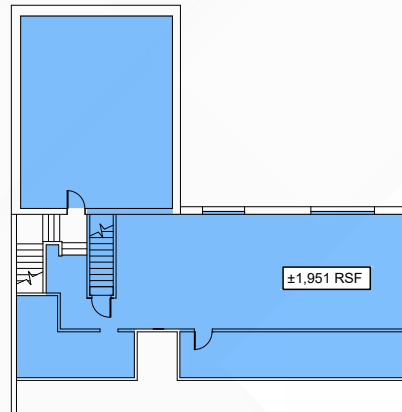

2ND FLOOR

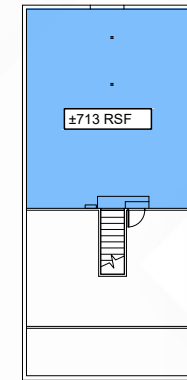

PENTHOUSE

SIZE RANGES





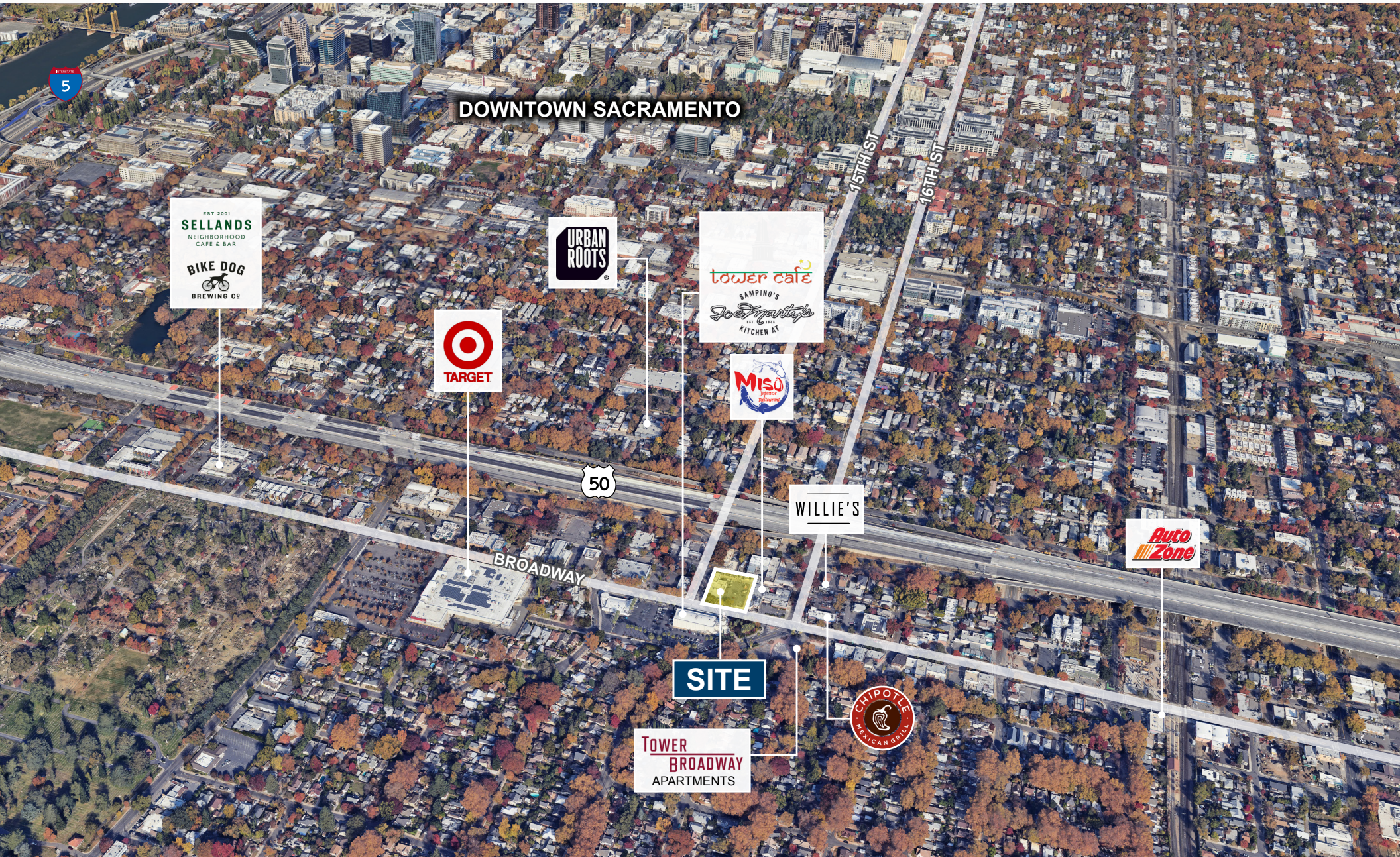

1,900 SF - 9,664 SF

BROADWAY AERIAL



GATEWAY TO SACRAMENTO'S ICONIC LAND PARK NEIGHBORHOOD

DEMOGRAPHICS

	1 Mile	3 Mile	5 Mile
 Population	26,687	158,043	389,233
 Median Age	36.9	38.4	37.0
 Households	13,595	63,387	153,510
 Median Household Income	\$88,529	\$87,105	\$82,059
 Median Home Value	\$778,428	\$667,401	\$577,528
 Unemployment Rate	4.9%	5.2%	6.0%

NEWMARK



THE BAT | 1515 BROADWAY | SACRAMENTO

1515 BROADWAY

DEVON ATLEE

916-569-2336

devon.atlee@nmrk.com
CA RE License #00944128

CHANDLER EDEN

916-569-2380

chandler.eden@nmrk.com
CA RE License #02081848

NEWMARK

980 9th Street, Suite 2500 | Sacramento, Ca. 95814

The distributor of this communication is performing acts for which a real estate license is required. The information contained herein has been obtained from sources deemed reliable but has not been verified and no guarantee, warranty or representation, either express or implied, is made with respect to such information. Terms of sale or lease and availability are subject to change or withdrawal without notice. • 4/2026