

FIRST FLOOR PLAN  
(INCLUDING DEMOLITION)  
SCALE: 1/4" = 1'-0"

HALL TYPE LEGEND

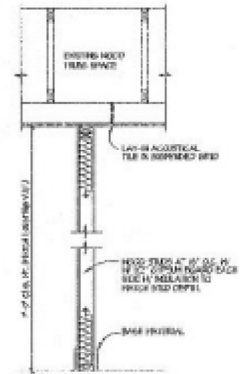
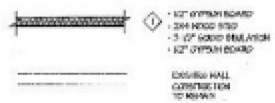

WALL SECTION  
SCALE: 3/4" = 1'-0"

- GENERAL DEMOLITION NOTES**
1. ALL DEMOLITION NOTES ON DEMOLITION DRAWINGS FOR THE EXISTING BUILDING ARE APPROXIMATE ONLY. CONTRACTORS MUST VERIFY ACTUAL FIELD MEASUREMENTS & CONDITIONS.
  2. ROOM NUMBERS AND FLOOR CONSTRUCTION CONSTRUCTION AND SO NOT EXCESSIVELY SQUARE OR 4 FT. EXISTING ROOM NUMBER SHALL BE USED.
  3. BUILDING MATERIALS AND CONSTRUCTION NOTED ON DRAWING FOR THE EXISTING BUILDING ARE REMOVE HEREIN IN ACCORDANCE WITH CONTRACTOR TO MAINTAIN COMPLETE FIELD CONDITIONS.
  4. CONTRACTOR SHALL PROVIDE TEMPORARY PARTITIONING BETWEEN NEW AND OCCUPIED CONTRACTOR PER CODE REQUIREMENTS.
  5. DO NOT REMOVE ANY INDICATED STEEL BEAMS, COLUINS OR TRUSSING (EXCEPT WALLS) WITHOUT FIRST NOTIFYING TO INSURE THAT REMOVAL WILL NOT AFFECT THE STRUCTURAL INTEGRITY OF CONSTRUCTION TO REMAIN.
  6. REMOVE & REPAIR ALL EXISTING ROOFS, SUEMERS, VENTS, ETC. IN AREA OF NEW WORK TO MAINTAIN PROPOSED CONSTRUCTION.
  7. CONTRACTOR SHALL PROVIDE ACCESS TO EXISTING BUILDING DURING CONSTRUCTION FOR EMPLOYEES, NEARBY, ETC. PER ALL CODE REQUIREMENTS.
  8. MAKE DEMOLITION HEREIN IS INDICATED OR REQUIRED ALL WORK SHALL BE PAID AND REPAIRED TO LIKE NEW CONDITION.
  9. REFER TO MECHANICAL AND ELECTRICAL DRAWINGS FOR ADDITIONAL DEMOLITION WORK BY MECHANICAL AND ELECTRICAL TRADES IN CONNECTION WITH NEW WORK OR RELATED OR ARCHITECTURAL PLANS.
- FLOOR PLAN / DEMOLITION KEYED NOTES**
1. REMOVE EXISTING HALL COFFERED.
  2. REMOVE EXISTING DOOR & FRAME, STORE AND REUSE.
  3. ALLOW HALLS PER NOTE FLOOR FINISHES OVER NEWER OVERLAP.
  4. VERIFY HALL DOOR LOCATOR BY ORDER TO VERIFY EXISTING ELECTRICAL IN WALL.

DO NOT SCALE DRAWINGS  
SEE FIGURE DIMENSIONS ONLY.  
THE ARCHITECT SHALL NOT BE RESPONSIBLE FOR  
NEW WORK THAT EXCEEDS THESE DIMENSIONS. ALL  
RECONSTRUCTION SHALL BE DONE AT THE CONTRACTOR'S  
RISK. CONTRACTOR SHALL NOTIFY ARCHITECT OF  
ANY DISCREPANCIES IN THESE DOCUMENTS BEFORE  
PROCEEDING WITH ANY RELATED WORK.