

CONDOMINIUM MAP OF LITTLETON STATION CONDOMINIUMS FIRST AMENDMENT

LOCATED WITHIN THE SOUTHWEST ONE-QUARTER OF SECTION 16,
TOWNSHIP 5 SOUTH, RANGE 68 WEST OF THE 6TH PRINCIPAL MERIDIAN,
CITY OF LITTLETON, COUNTY OF ARAPAHOE, STATE OF COLORADO
SHEET 2 OF 7

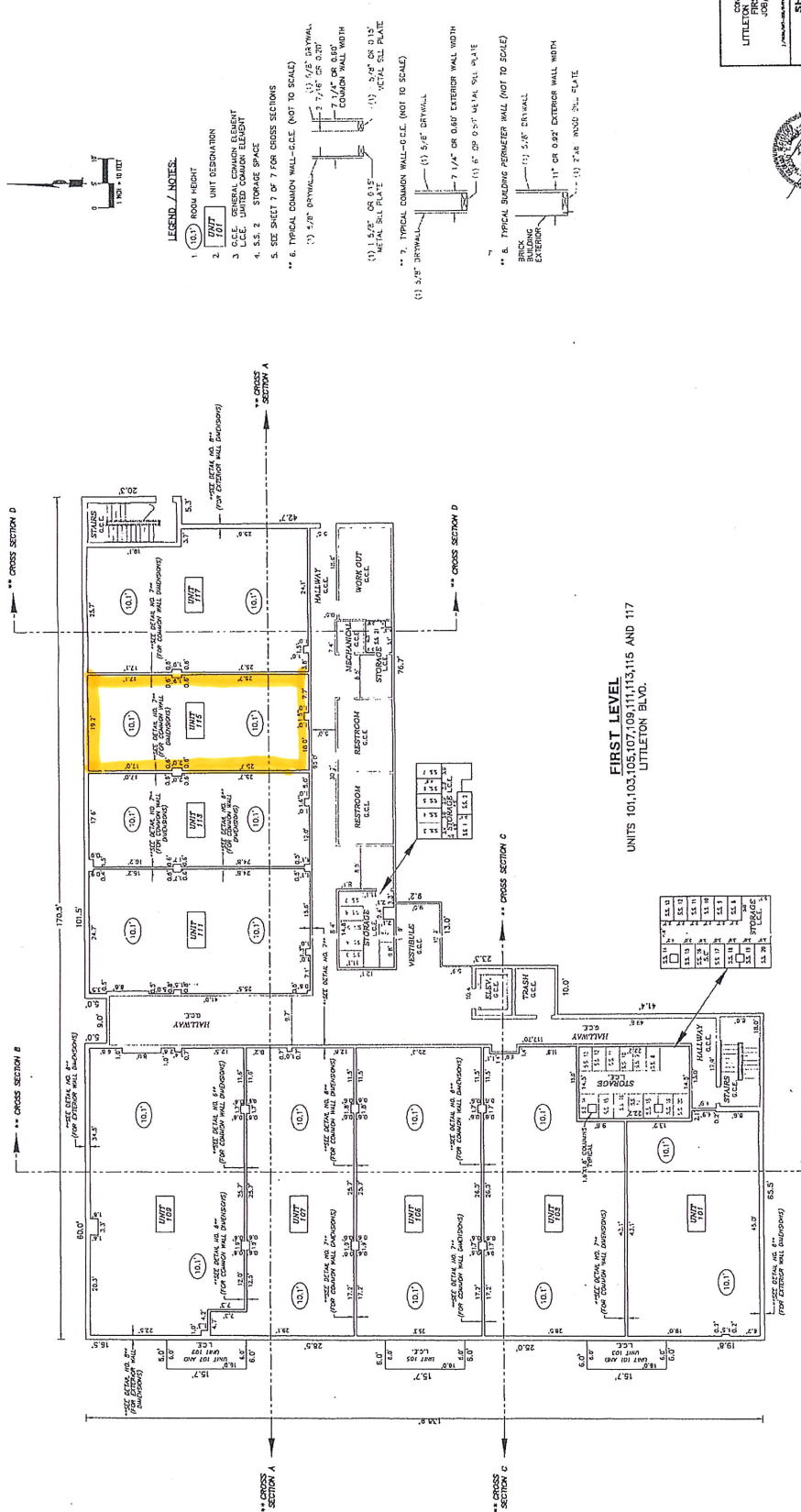

FIRST LEVEL
UNITS 101, 103, 105, 107, 109, 111, 113, 115 AND 117
LITTLETON BLVD.

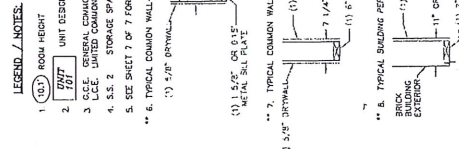

PROJECT INFO:
LITTLETON STATION CONDOMINIUMS
FIRST AMENDMENT
JOB NO. 100-005
DATE: APRIL, 2017



SHEET 2 OF 7

339-41 2017