

For Sale | \$854,000

# ±3,000 SF Light Industrial Condo

2624 Verne Roberts Circle, Suite D10 & D11 | Antioch, CA

## Highlights



Office improvements for a wide range of uses including Showroom, Light Assembly, Processing and R&D



Rear loading with two grade level door



Ample parking in the front and rear



Zoned M-I | Flexible zoning includes: Commercial, Office R&D, Light Industrial, Manufacturing and Warehouse



Excellent freeway access to Highway 4



Located across the street from Costco



Safe and secure Business Park with HOA managing all outside maintenance



Units can be separated



## Contact Brokers

### Bill Hillis

Executive Vice President  
CA License No. 01262007  
bill.hillis@colliers.com  
+1 925 279 5578

### Curt Scheve

Executive Vice President  
CA License No. 00916122  
curt.scheve@colliers.com  
+1 925 785 3000

# Site Plans

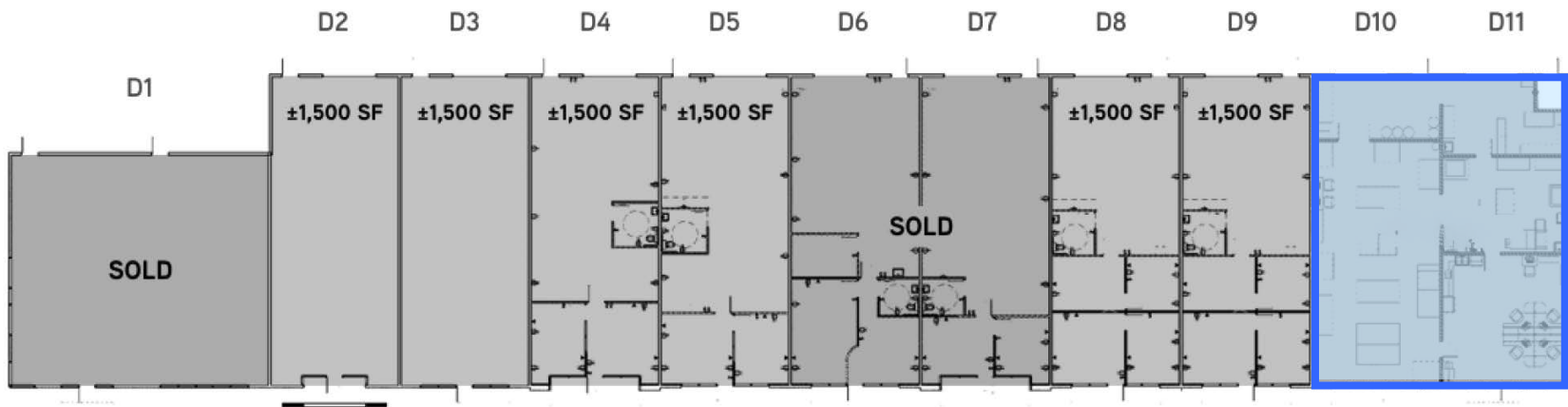
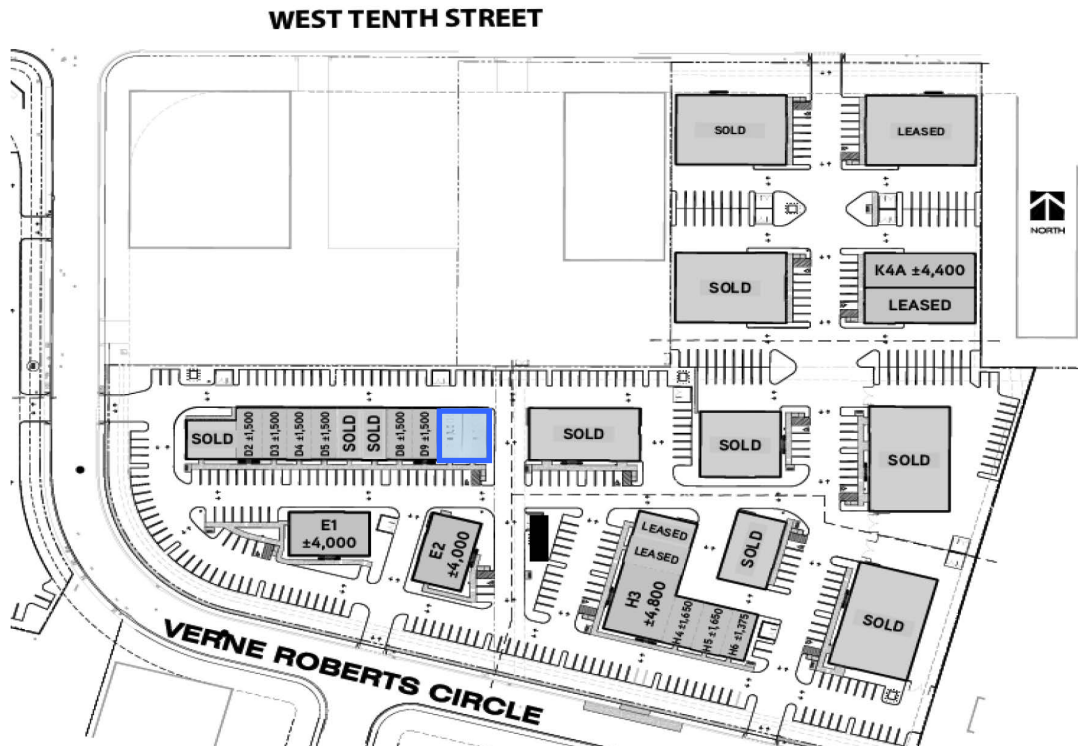

2624 Verne Roberts Circle, Suite D10 & D11 | Antioch, CA

# Floor Plan

±3,000 SF



2624 Verne Roberts Circle, Suite D10 & D11 | Antioch, CA

# Photo Gallery



2624 Verne Roberts Circle, Suite D10 & D11 | Antioch, CA

# Location Overview

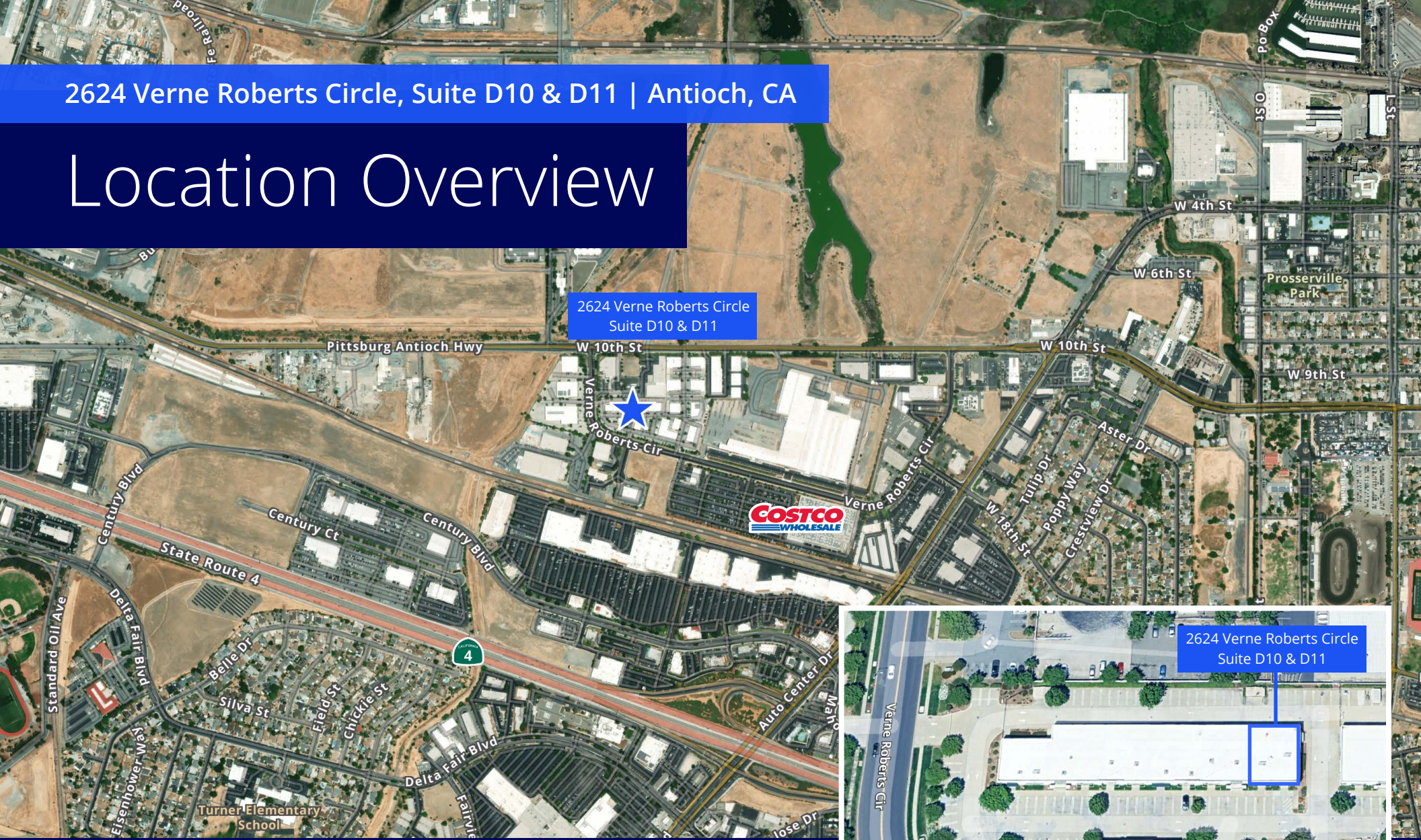

2624 Verne Roberts Circle  
Suite D10 & D11

2624 Verne Roberts Circle  
Suite D10 & D11



## Contact Brokers

### Bill Hillis

Executive Vice President  
CA License No. 01262007  
bill.hillis@colliers.com  
+1 925 279 5578

### Curt Scheve

Executive Vice President  
CA License No. 00916122  
curt.scheve@colliers.com  
+1 925 785 3000