

FOR LEASE | 16,193 - 36,072 SF



3471 ATLANTA INDUSTRIAL PKWY | ATLANTA, GA 30331

All information regarding property for sale, rental or financing is from sources deemed reliable, but no warranty or representation is made to the accuracy thereof and same is submitted to errors, omissions, change of price, rental or other conditions prior to sale, lease or financing or withdrawal without notice. No liability of any kind is to be imposed on the broker herein.



FOR MORE
INFORMATION:

CONNOR WINKLER, SIOR

Executive VP / Principal
cwinkler@lee-associates.com
O: 404.442.2803
C: 318.393.8248



OWNED AND MANAGED BY

Faropoint



**LEE &
ASSOCIATES**

COMMERCIAL REAL ESTATE SERVICES

Property Summary

PROPERTY SIZE

- 36,072 SF total
- Option A: 36,072 SF | 5,323 SF Office
- Option B: 18,613 SF | 3,054 SF Office
- Option C: 16,193 SF | 2,102 SF Office

POWER

- Suite 100: 800-amp, 600V, 3-pole
- Suite 200: 400-amp, 600V, 3-pole

COLUMN SPACING

40' x 40'

CLEAR HEIGHT

20'-22'

CONFIGURATION

Rear Load

YEAR BUILT

1987

DOCK HIGH DOORS

- 1 dock high door (12'W x 14'H)
- 3 dock high doors (8'W x 10'H)(1 pit leveler, 1 EOD)
- 2 dock high doors(10'W x 12'H)

DRIVE IN DOORS

- 1 grade level door (12'W x 14'H)

ZONING

I-2 (Heavy Industrial)

PARKING

34 striped auto spaces

SPRINKLER

Yes

COMMENTS

Secure Truck Court



FOR MORE INFORMATION:

CONNOR WINKLER, SIOR
 Executive VP / Principal
 cwinkler@lee-associates.com
 O: 404.442.2803
 C: 318.393.8248

CLICK HERE FOR ADDITIONAL PHOTOS



Floor Plan

● Location Highlights

● Floor Plan

● Property Summary

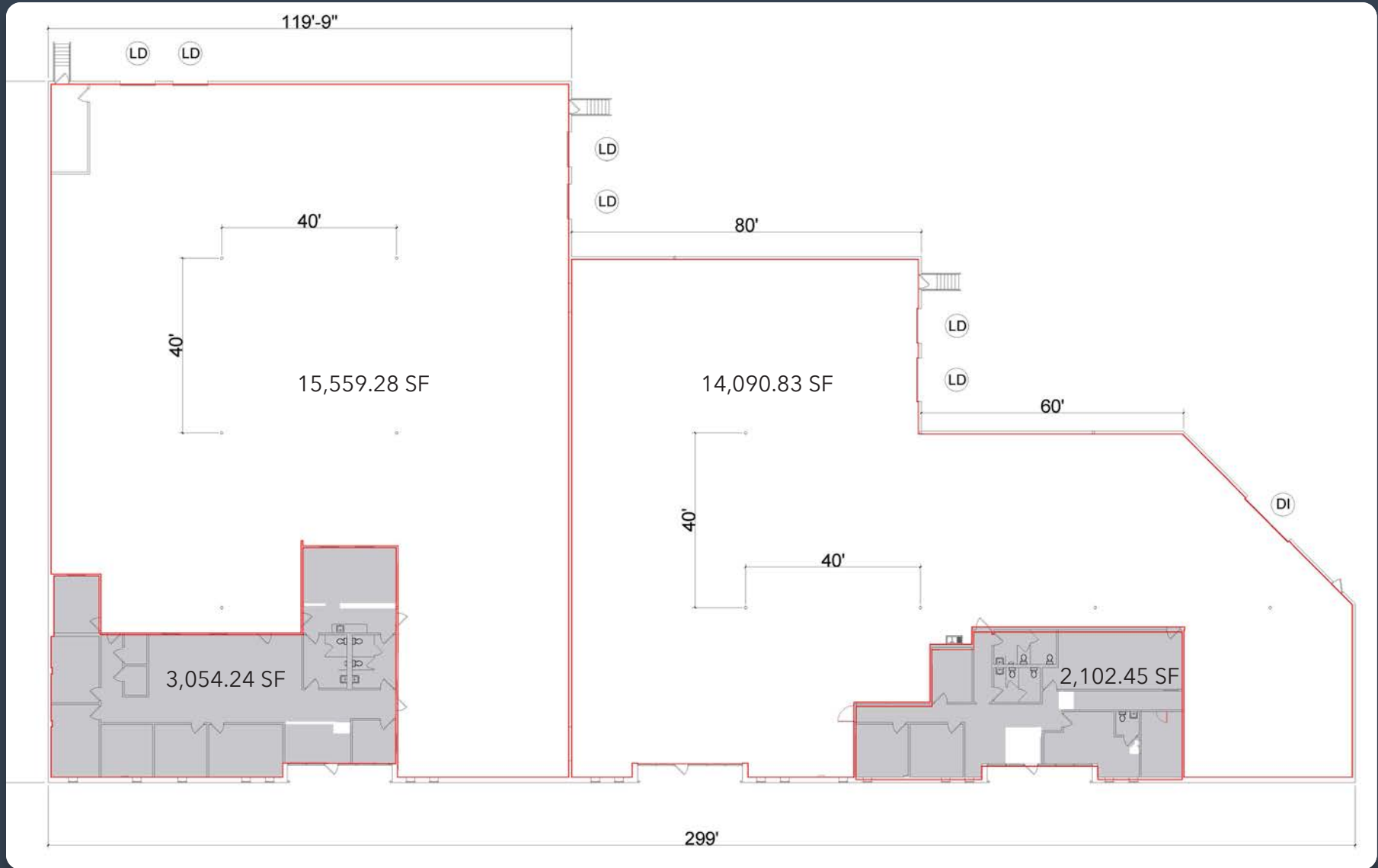





FOR MORE
INFORMATION:

CONNOR WINKLER, SIOR
Executive VP / Principal
cwinkler@lee-associates.com
O: 404.442.2803
C: 318.393.8248



Location Highlights

KEY DISTANCES

-  0.4 miles
-  0.7 miles
-  2.5 miles (via I-285)
-  9 miles (via I-20)
-  17.9 miles

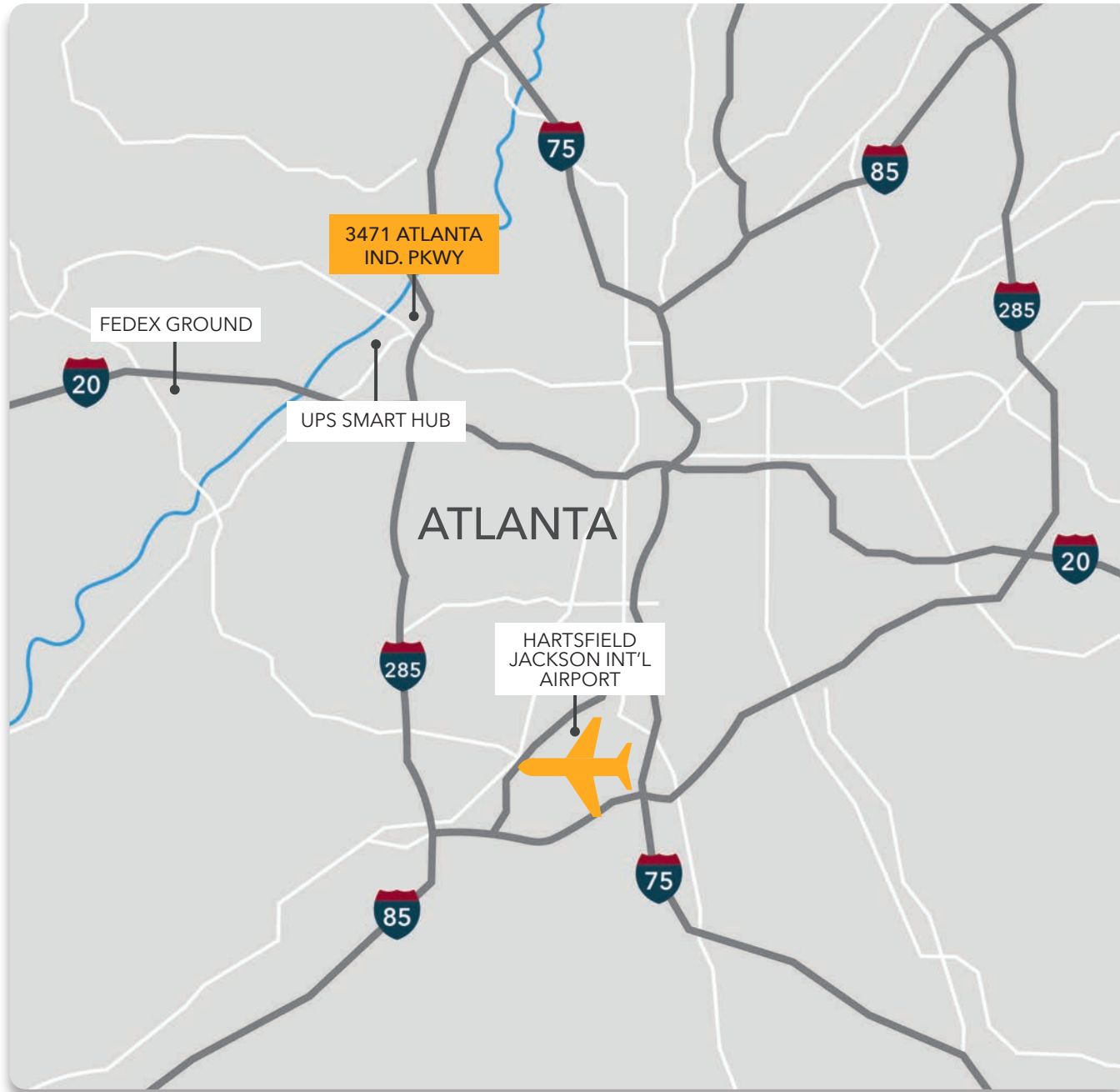
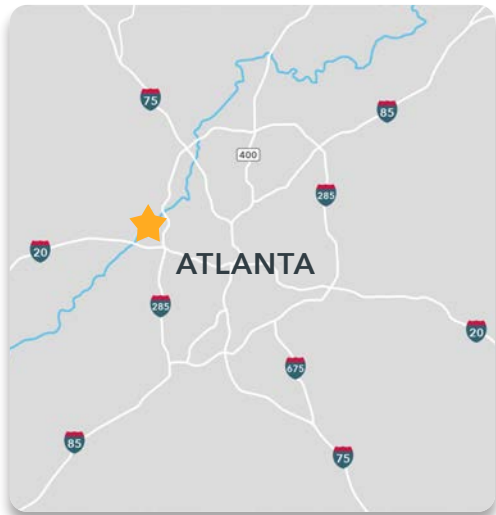

FOR MORE INFORMATION:

CONNOR WINKLER, SIOR
Executive VP / Principal
cwinkler@lee-associates.com
O: 404.442.2803
C: 318.393.8248

