

FOR LEASE

Owned and Operated by 

7142 AMBASSADOR RD

WINDSOR MILL, MD 21244

50,595 SF



PROPERTY VITALS

Availability:	50,595
Office:	2,979
Column Spacing:	32'w x 32'd
Loading:	15 dock doors
Truck Court:	70'
Zoning:	ML-IM

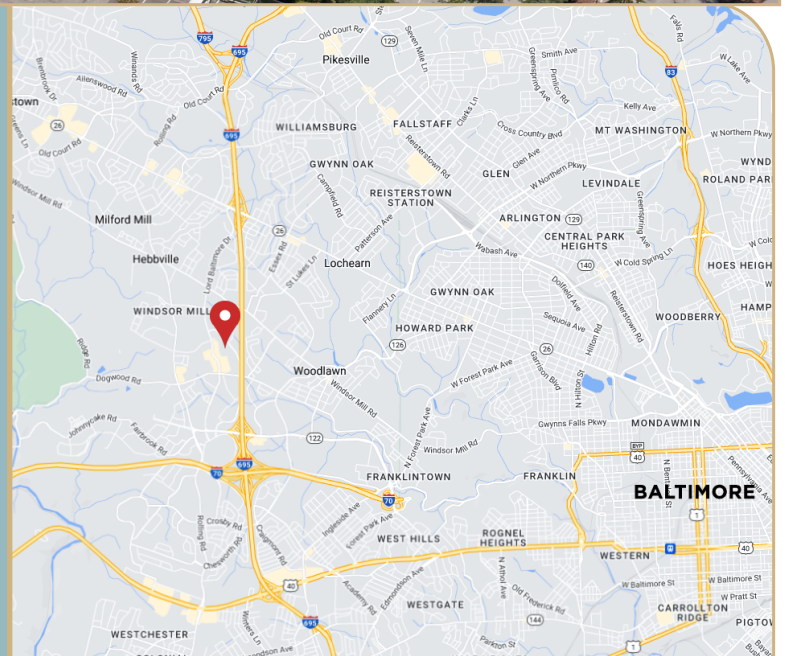

LEASING INFO & CONTACT

Brian Kruger
Thomas Hinder
Erik Evans

(410) 625-4211 / brian.kruger@nmrk.com
(410) 844-4010 / thomas.hinder@nmrk.com
(410) 844-4003 / erik.evans@nmrk.com

NEWMARK

This is not an offer or acceptance of an offer to lease space. A lease will only be offered or made in a written agreement signed by landlord. No representation or warranty of any kind is made by landlord unless set forth in a written definitive lease executed by the landlord.

FOR LEASE

7142 AMBASSADOR RD

Woddlawn, MD 21244

50,595 SF

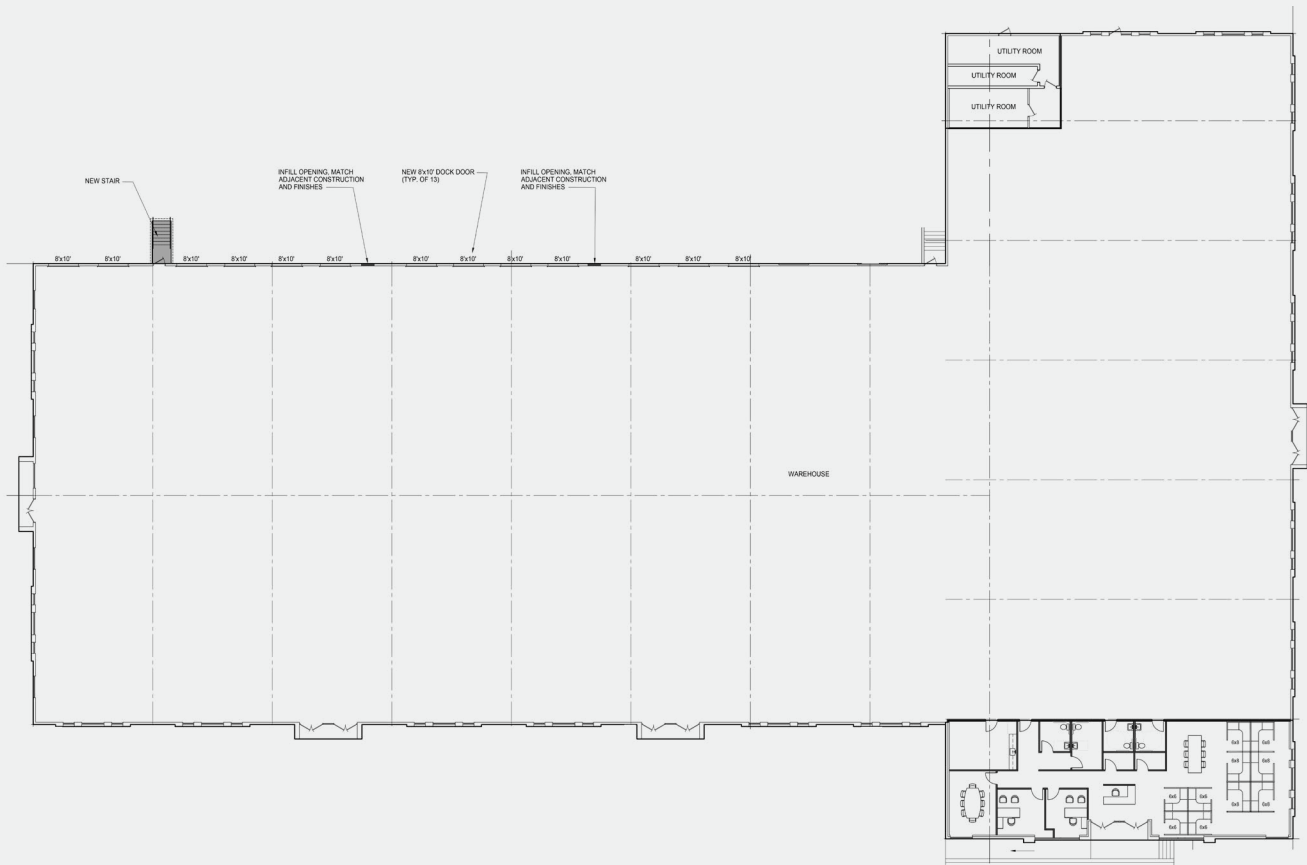

LEASING INFO & CONTACT

Brian Kruger	(410) 625-4211 / brian.kruger@nmrk.com
Thomas Hinder	(410) 844-4010 / thomas.hinder@nmrk.com
Erik Evans	(410) 844-4003 / erik.evans@nmrk.com

NEWMARK