

New Construction Warehouse Condos

EXCLUSIVELY OFFERED BY
WILSON HUTCHISON REALTY, LLC



WILSON HUTCHISON
REALTY, LLC



Industrial and Personal Small-Bay Warehouse Condominiums

**3770 Francis Circle
Alpharetta, GA 30004**

**Units 215 & 216
For Sale at
\$355,000.00 each**

**Each unit is +/- 1,250 SF
Can Combine Units**

Artistic rendering

**Robert Wilson
770-318-9439 – Cell
Or
Robert@wilsonhutch.com**

Industrial / Personal Use • Warehouse / Manufacturing / Hobby

The information has been secured from sources we believe to be reliable, but we make no representations or warranties, expressed or implied, as to the accuracy of the information.

5755 North Point Parkway, Suite 44, Alpharetta, GA 30022 Tel: 770-242-7917 Fax: 678-325-4824 | www.wilsonhutch.com

**3770 Francis Circle
Alpharetta, GA 30004
Forsyth County**

**EXCLUSIVELY OFFERED BY
WILSON HUTCHISON REALTY, LLC**



- Zoned: M1
- 12' x 14' insulated sectional, high-rise overhead door
- 20' tall ceilings
- Insulated walls and ceilings
- Air conditioning and heat
- ADA Half Bath with tankless water heater
- High Bay LED light fixtures
- Laundry sink
- Sprinkler System
- Drywall and painted ceilings
- Drywall walls
- Concrete Floor
- Hose bib at interior of overhead door
- 110v receptacle at front and rear wall and each sink
- Condominium Association
- Protective Covenants
- 2 assigned parking spaces per Suite with additional overflow parking

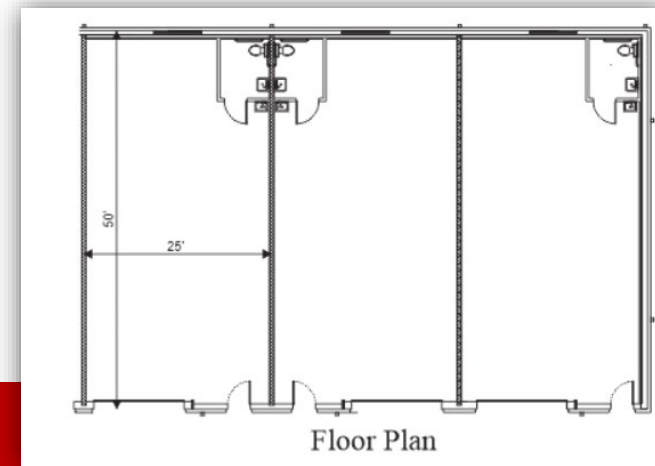

**Robert Wilson
770-318-9439 – Cell
Or
Robert@wilsonhutch.com**

The information has been secured from sources we believe to be reliable, but we make no representations or warranties, expressed or implied, as to the accuracy of the information.

5755 North Point Parkway, Suite 44, Alpharetta, GA 30022 Tel: 770-242-7917 Fax: 678-325-4824 | www.wilsonhutch.com

3770 Francis Circle
Alpharetta, GA 30004
Forsyth County

EXCLUSIVELY OFFERED BY
WILSON HUTCHISON REALTY, LLC



WILSON HUTCHISON
REALTY, LLC

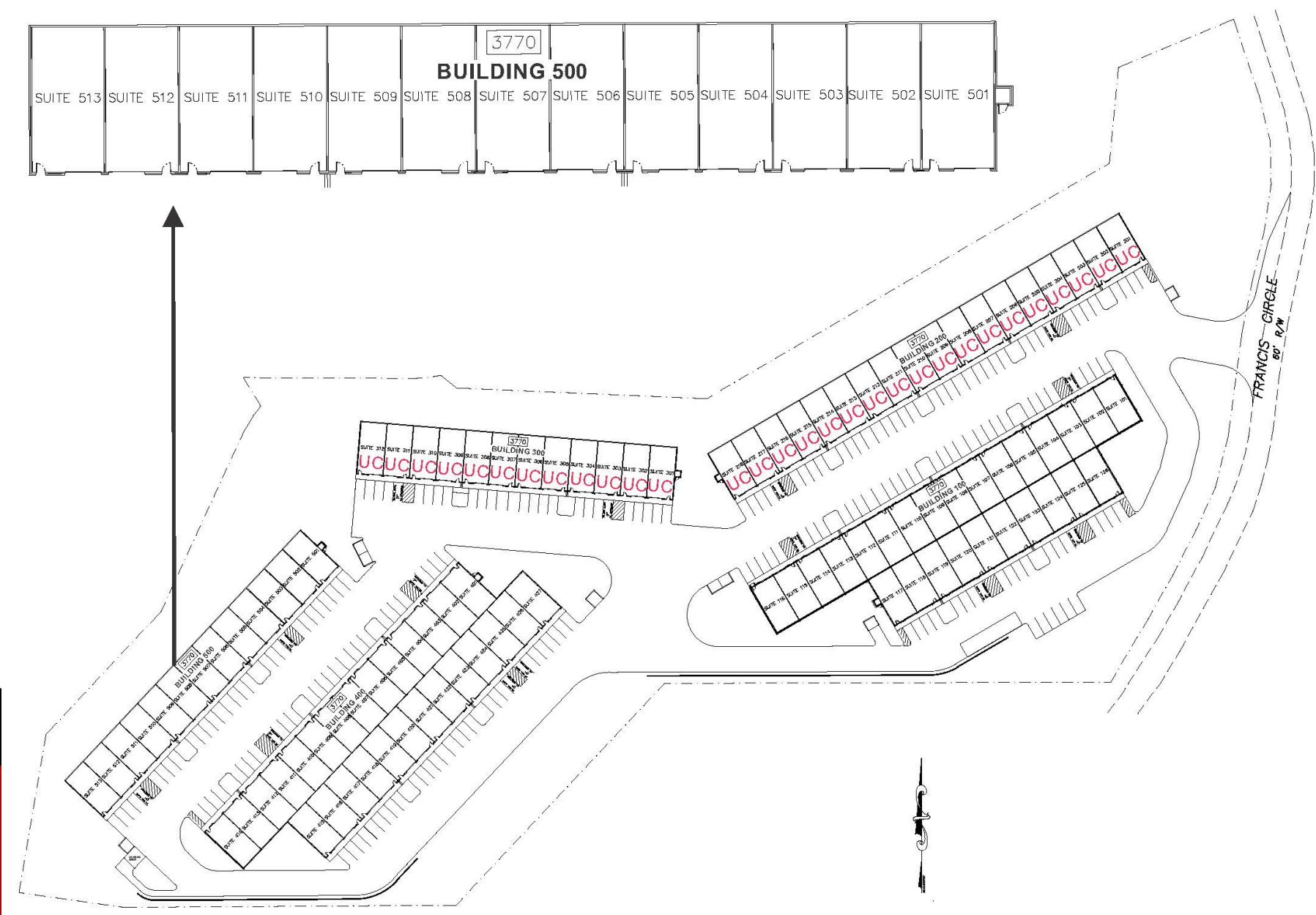

The information has been secured from sources we believe to be reliable, but we make no representations or warranties, expressed or implied, as to the accuracy of the information.

5755 North Point Parkway, Suite 44, Alpharetta, GA 30022 Tel: 770-242-7917 Fax: 678-325-4824 | www.wilsonhutch.com

**3770 Francis Circle
Alpharetta, GA 30004
Forsyth County**

**EXCLUSIVELY OFFERED BY
WILSON HUTCHISON REALTY, LLC**



**WILSON HUTCHISON
REALTY, LLC**

Partial Floorplan

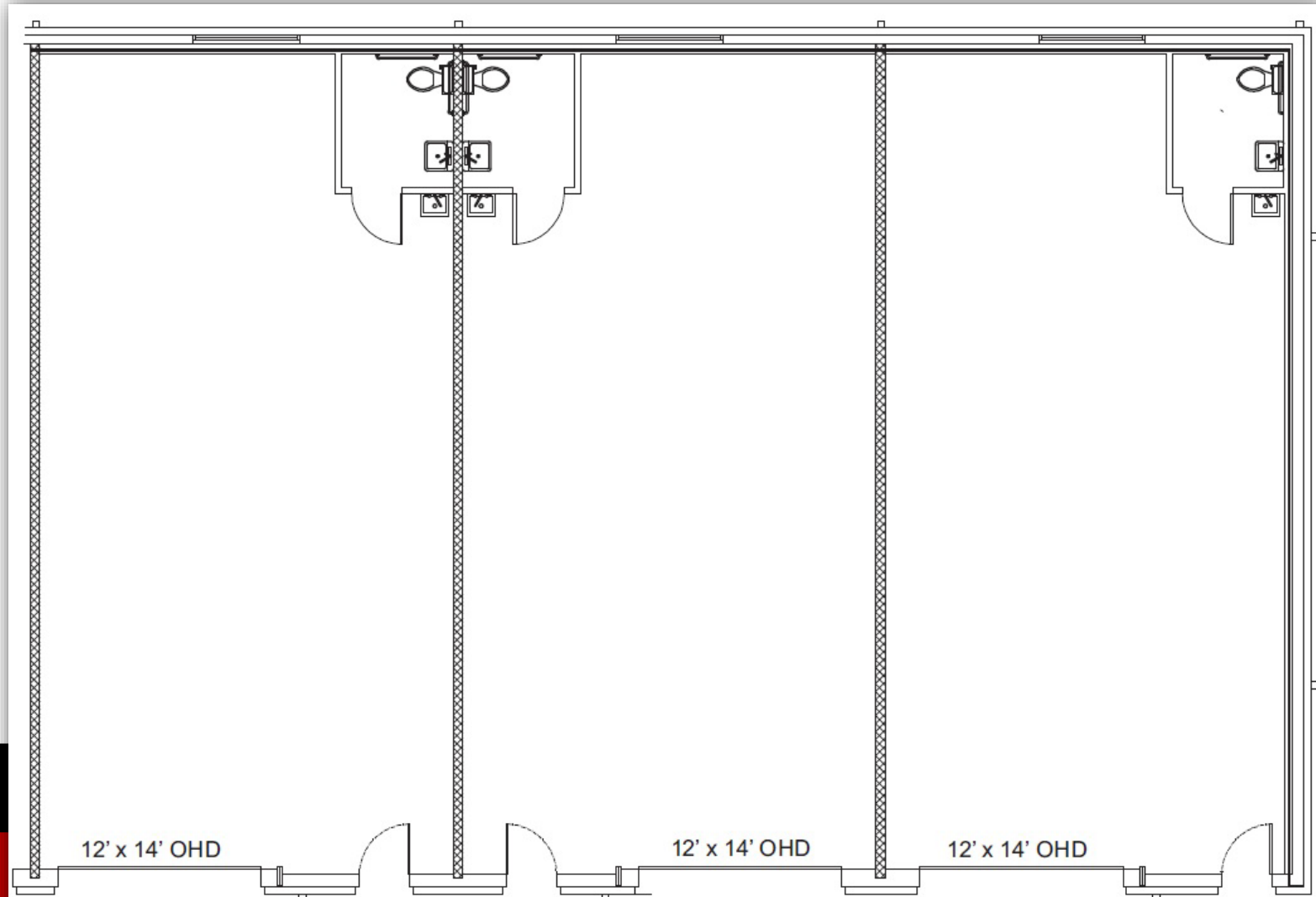

Typical Unit 25' wide x 50' deep x 20' tall

The information has been secured from sources we believe to be reliable, but we make no representations or warranties, expressed or implied, as to the accuracy of the information.

5755 North Point Parkway, Suite 44, Alpharetta, GA 30022 Tel: 770-242-7917 Fax: 678-325-4824 | www.wilsonhutch.com