



**MARTIN
COMMERCIAL
GROUP**
Commercial Real Estate Services



AVAILABLE FOR LEASE

OFFICE/WAREHOUSE SUITES FROM 1,200 - 2,400 Sq. Ft.



1218 - 1240 S. LYON STREET ~ SANTA ANA

Features:

- Units From 1,200 - 2,400 Sq. Ft.
- 10'x10' GL Loading Doors
- 12' Clear Height
- 100 - 200A 3P 120/208V (Verify)
- Easy Access to the 5, 55, 405, 22 & 73 Freeways
- Professionally Managed Business Park

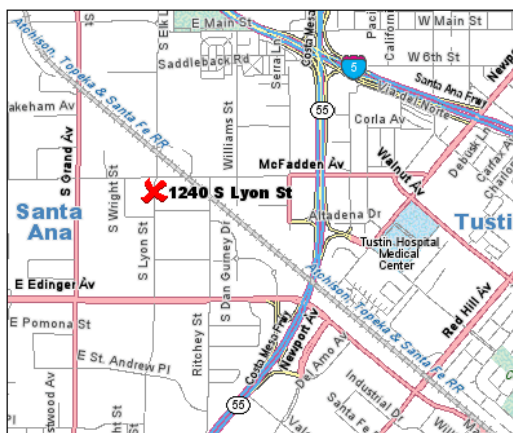

**For More Information
Please Contact:**

SAM GREEK
sgreek@mcgre.com
DRE # 01240614

LORI MCAMIS
lmcamis@mcgre.com
DRE # 01873441

714.241.1141

1495 E. Warner Avenue
Santa Ana, CA 92705

*Since 1953...
Orange County ~ Inland Empire*

The information contained herein has been obtained from sources we deem reliable. While we have no reason to doubt its accuracy, we do not guarantee it.



MARTIN COMMERCIAL GROUP

Commercial Real Estate Services



For More Information
Please Contact:

SAM GREEK

sgreek@mcgre.com
DRE # 01240614

LORI MCAMIS

lmcamis@mcgre.com
DRE # 01873441

714.241.1141

1495 E. Warner Avenue
Santa Ana, CA 92705

*Since 1953...
Orange County ~ Inland Empire*

1218 - 1240 S. Lyon Street Office/Warehouse Suites From 1,200 - 2,400 Sq. Ft.

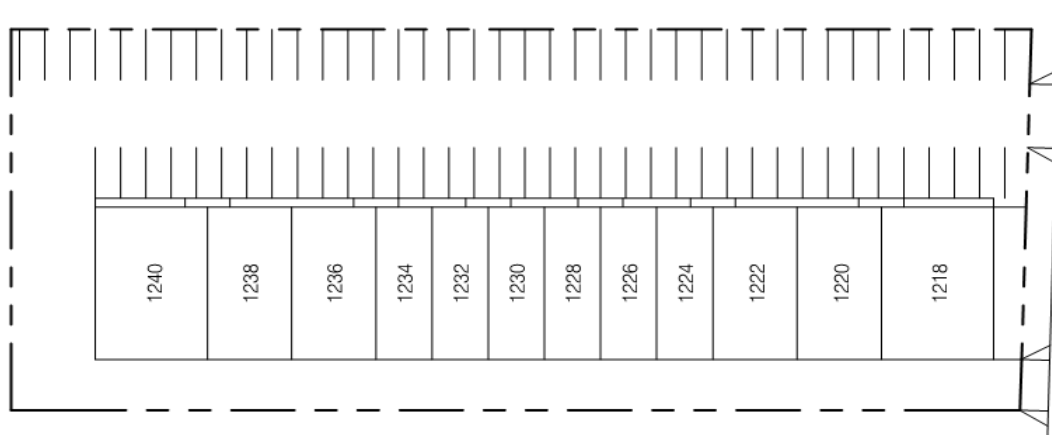
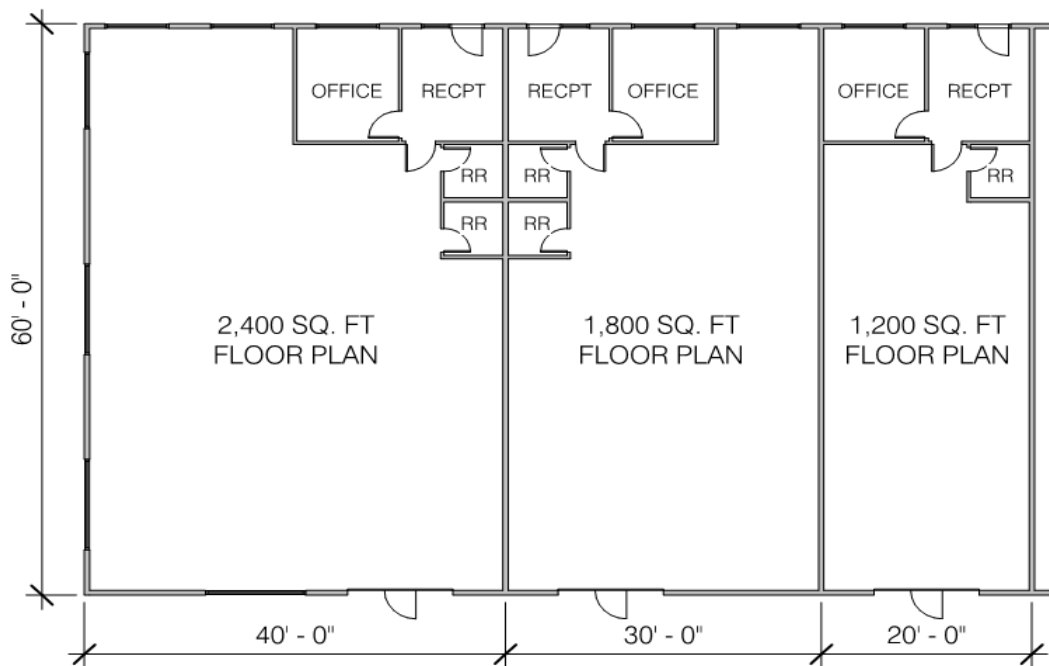

WWW.MCGRE.COM