

OMNI BUSINESS PARK 7303 BURLESON RD.

SUITE 0901 FLOOR PLAN
Asking Rent: \$0.90 / SF

Drawing for:
L.H. LAYNE COMPANY
404 W. Powell, Ste. 202
Austin, Texas 78753
Ph: 252-9900 Fax: 252-9902

SUITE 901/906
OMNI BUSINESS PARK
7303 Burleson Rd.
RENTABLE AREA: 14,120 S.F.

THE ACQUISITION, AND
CONSTRUCTION OF
SUITES 901, 906 AND
SUITES 7004, 7005, 7006
AND SUITES 7007, 7008
AND SUITES 7009, 7010
ASSIGNED TO BK 57100.
Project No.: 20206.03
Rev. Date: June 14, 2019
©2019

DIMENSIONS
FLOOR PLANS
Austin, Texas
dimensions@lplp.com
Phone: (512) 252-9914

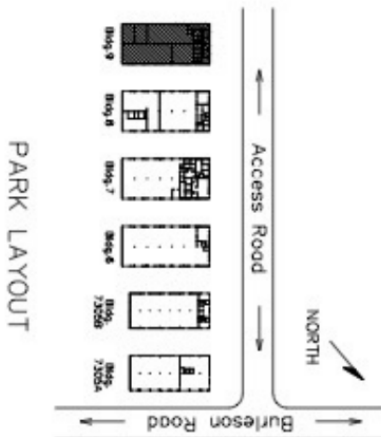
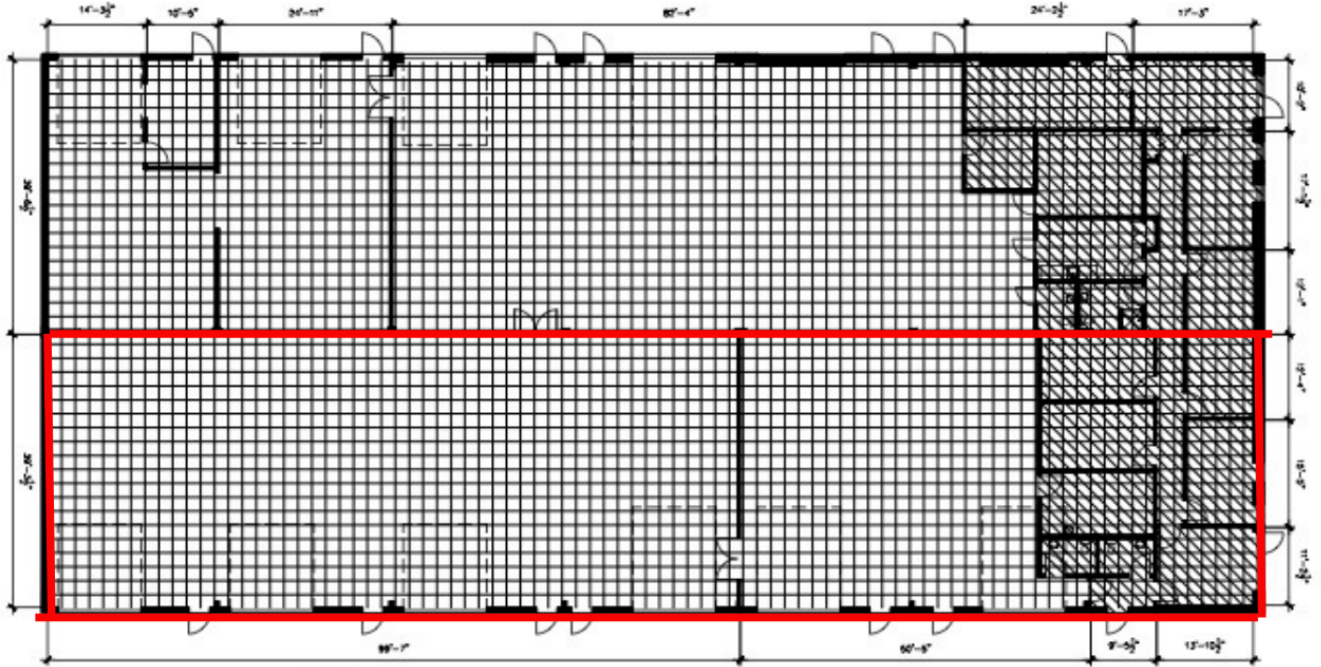

NOTE:
Overlying grid is 2' x 2'
Not to scale.

 Air Conditioned Area

98
22
20

Contact Information:

(512) 252-9900
404 W Powell Lane, Suite 202, Austin, TX 78753
laynecompany.com

