

# FOR SALE

## 24524 W 11 MILE



## 24524 W 11 MILE SOUTHFIELD, MI 48034

### PROPERTY HIGHLIGHTS:

- 38,161 SF Industrial on 2.8 Acres For Sale
- 33,920 SF Warehouse including Vehicle Repair Shop with Lift and Storage/Delivery room
- 4,241 SF 2-story Office
- (4) 12' x 12' Grade Level Doors and (1) 10' x 10' Grade Level Door
- 14'6" Clear Height
- Repair Shop, Storage/Delivery Room and 2-story Office has Rooftop HVAC Units
- Warehouse has Gas Unit Heaters throughout
- Rare 2.8 Acre site with room for additional development
- Excellent location on 11 Mile Rd with immediate access to Telegraph, M-10 and I-696
- Sale Price: \$3,350,000

The information provided herein along with any attachment(s) was obtained from sources believed to be reliable, however, Friedman Real Estate makes no guarantees, warranties, or representations as to the completeness or accuracy of such information and legal counsel is advised. All information provided is subject to verification and no liability for reliance on such information or errors or omissions is assumed. The presentation of this property is submitted subject to errors, omissions, change of price or conditions, prior sale or lease, or withdrawal without notice. Copyright © 2026 Friedman Real Estate. All rights reserved.

FOR MORE INFORMATION PLEASE CONTACT:



**ZACH CUMMINGS**  
zach.cummings@freg.com

**248.848.1253**

**eCODE 106**

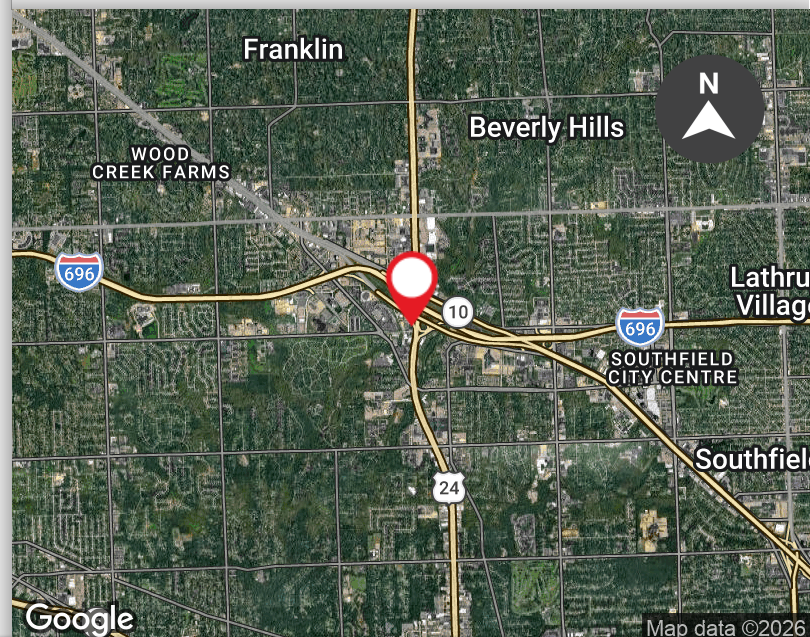

# 24524 W 11 MILE

## PROPERTY **INFORMATION**

### HIGHLIGHTS

Building SF:	38,161 SF
Office SF:	4,241 SF
County:	Oakland

### SITE

Land (acres):	2.8
Parcel Number:	24-17-451-013
Zoning:	ERO

### PRICING & AVAILABILITY

Asking Price	\$3,350,000
Taxes	\$61,409.58
Occupancy:	Single

### BUILDING INFORMATION

Type:	Industrial
Year Built:	1974
# Grade Level Doors:	(4) 12' x 12' & (1) 10' x 10'



FOR MORE INFORMATION **PLEASE CONTACT:**



**ZACH CUMMINGS**  
zach.cummings@freg.com

24524 W 11 MILE  
PROPERTY **FIRST FLOORPLAN**

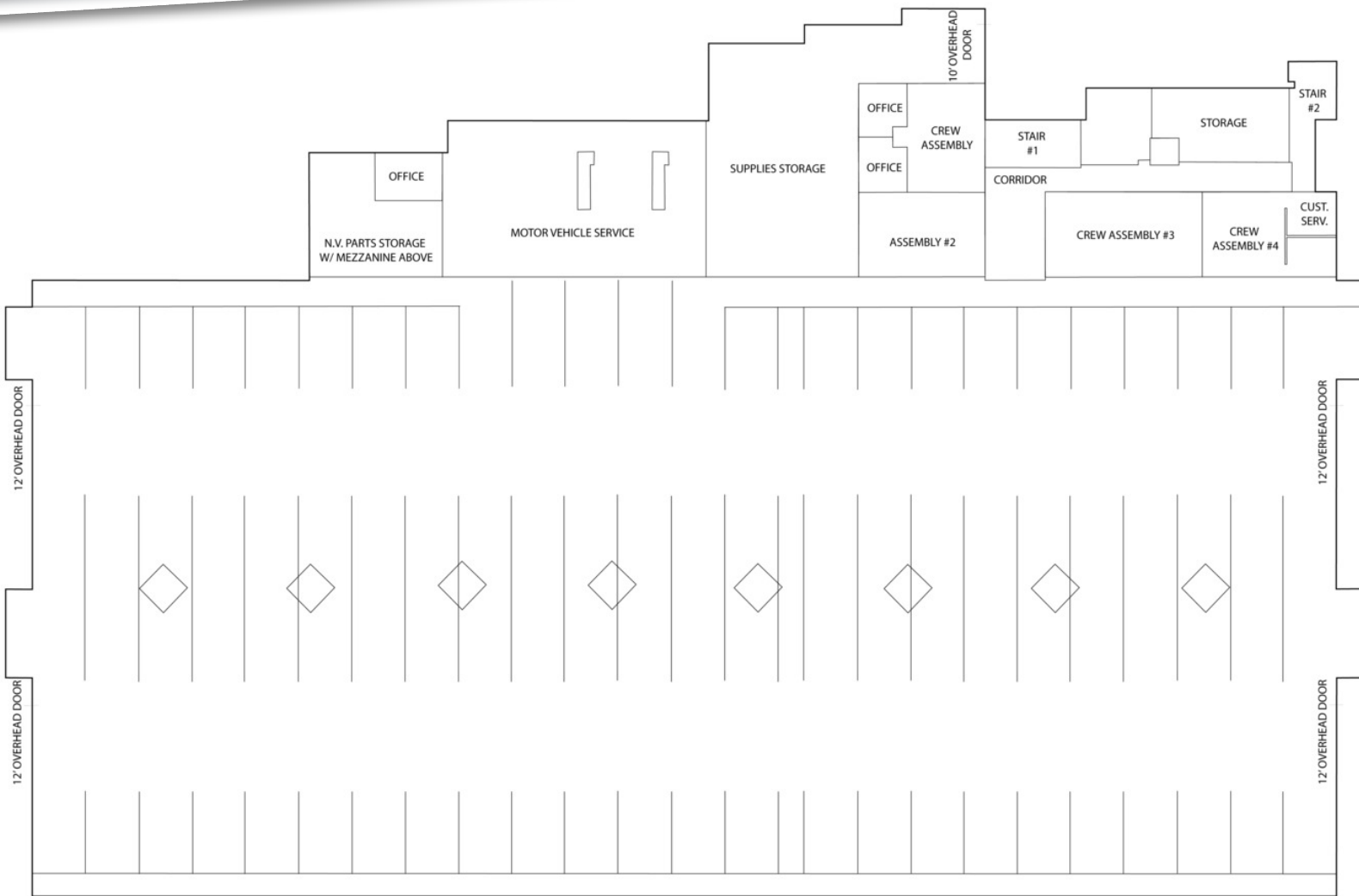

FIRST FLOOR PLAN