

GARDENSWARTZ SHOPPING CENTER



FOR LEASE

Retail Space Available

AVAILABLE

- Unit B1: ±11,372 SF
\$11.00/SF + NNN
- Unit B2: ±1,230 SF
- Unit C3: ±5,738 SF
\$16.00/SF + NNN

ZONING

C-2 | General Commercial

HIGHLIGHTS

- Establish shopping center – great for new business
- Shopping center anchored by Big 5 Sporting Goods
- Ample customer parking
- Adjacent to the iconic Jackalope store & CVS Pharmacy
- Tremendous visibility on Cerrillos Rd. to more than 43,000 cars per day
- Spaces available along a busy retail corridor

2860 Cerrillos Rd. Santa Fe, NM 87507



505.473.3434 | www.garsagroup.com
418 Cerrillos Rd. | Suite 11 | Santa Fe, NM 87501

Carlos Garcia
505.670.3181
carlos@garsagroup.com

Joel Cumplido
505.670.3328
joel@garsagroup.com

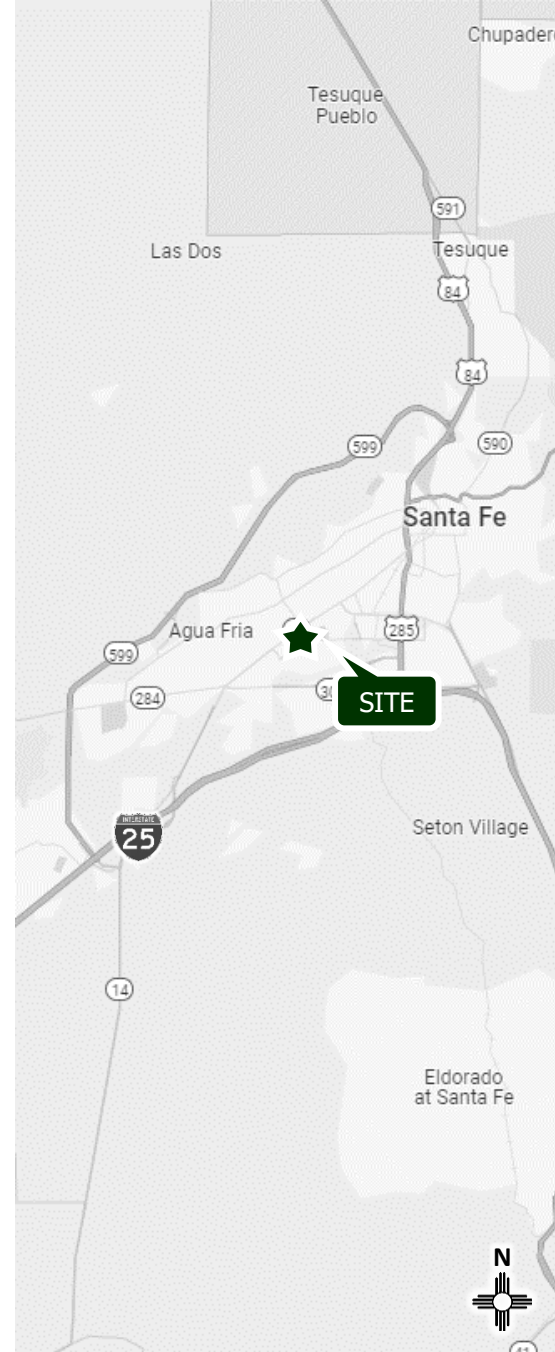
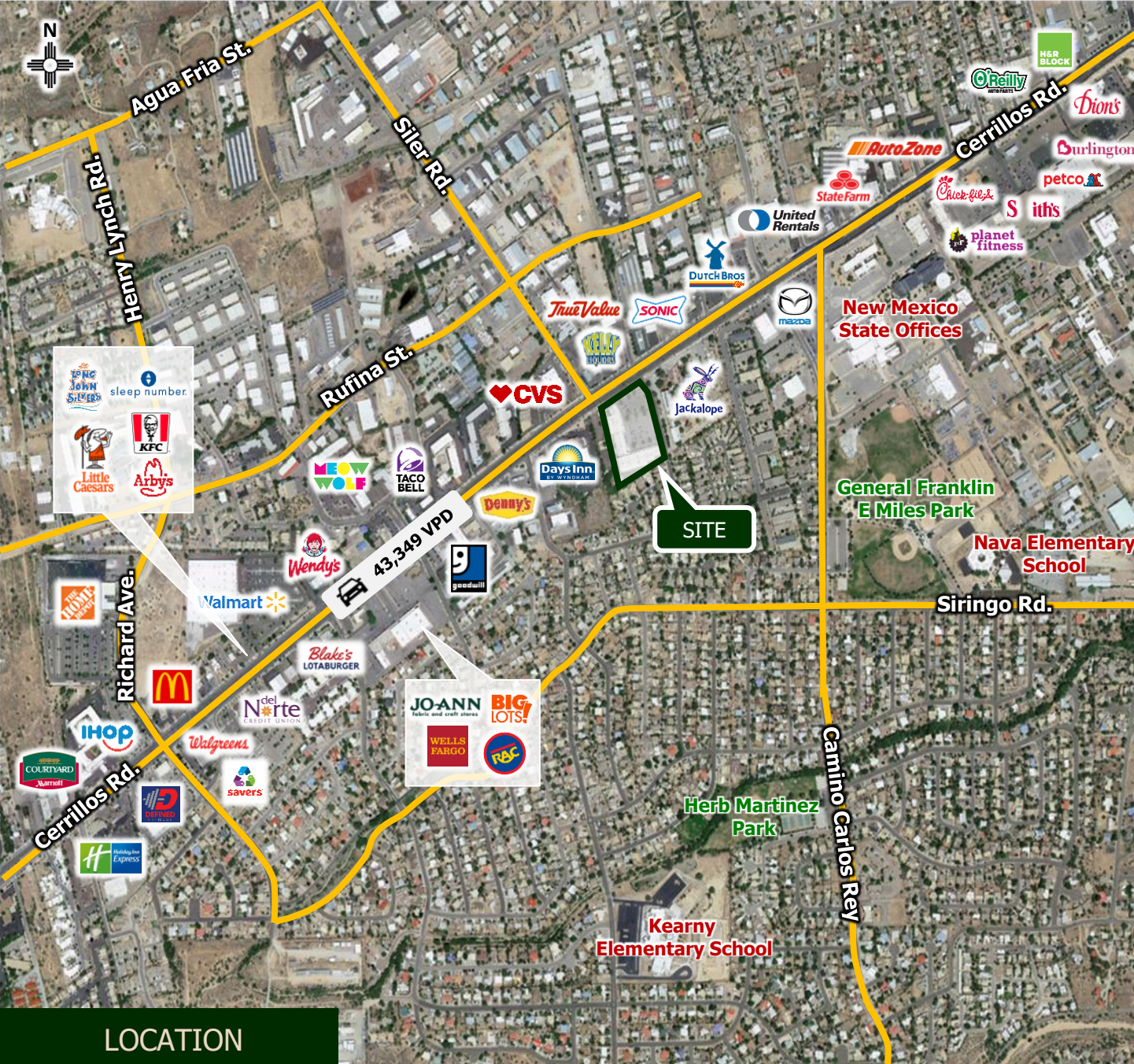

LOCATION

FOR LEASE

Retail Space Available
 2860 Cerrillos Rd. Santa Fe, NM 87507

Carlos Garcia Joel Cumplido
 505.670.3181 505.670.3328
 carlos@garsagroup.com joel@garsagroup.com



Unit C3
±5,738 SF

Unit B2
±1,230 SF

Unit B1
±11,372 SF

LOCATION

FOR LEASE

Retail Space Available
2860 Cerrillos Rd. Santa Fe, NM 87507

Carlos Garcia 505.670.3181 carlos@garsagroup.com
Joel Cumplido 505.670.3328 joel@garsagroup.com

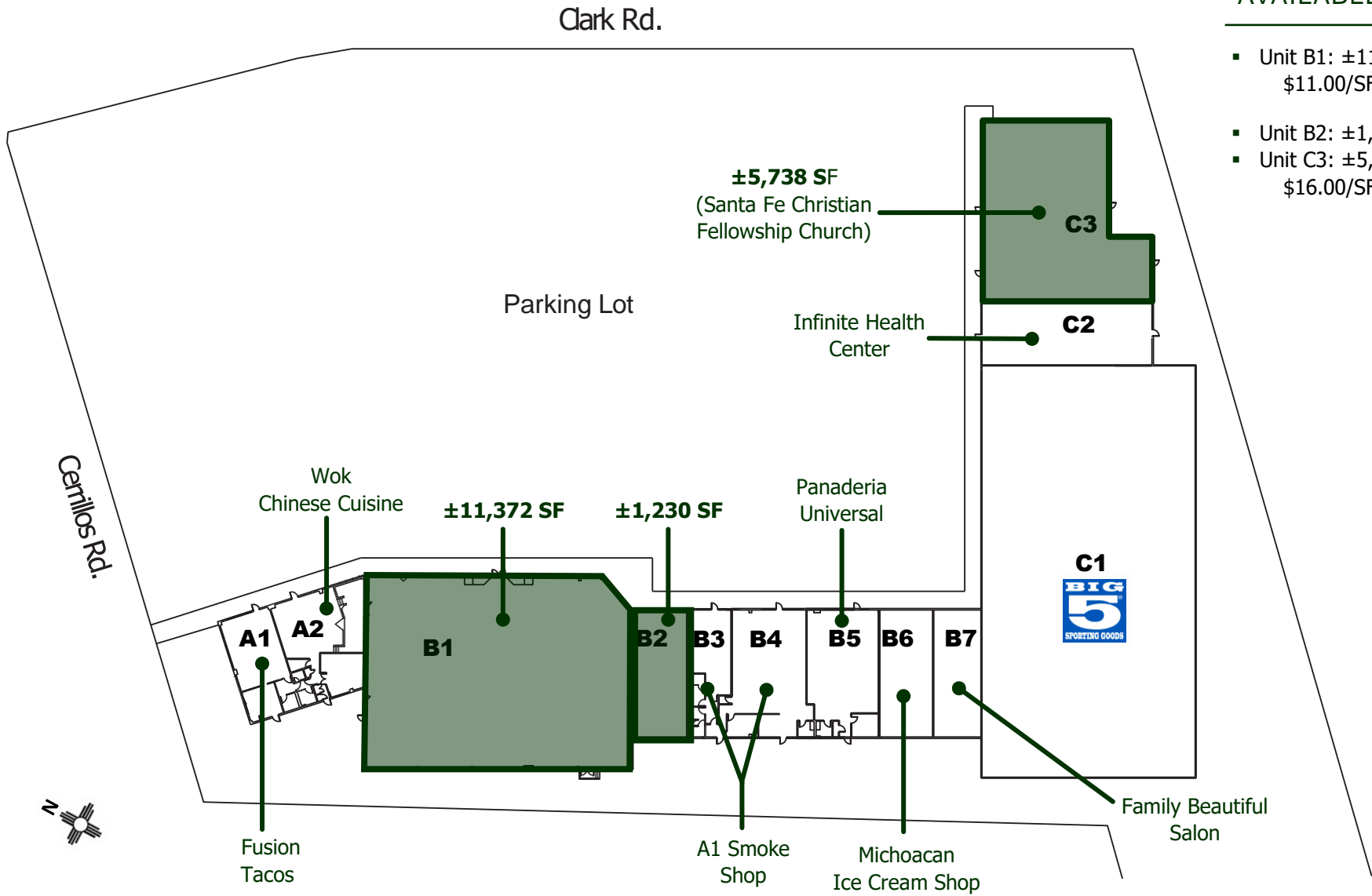

AVAILABLE

- Unit B1: ±11,372 SF
\$11.00/SF + NNN
- Unit B2: ±1,230 SF
- Unit C3: ±5,738 SF
\$16.00/SF + NNN

SITE PLAN

FOR LEASE

Retail Space Available
2860 Cerrillos Rd. Santa Fe, NM 87507

Carlos Garcia 505.670.3181 carlos@garsagroup.com
Joel Cumplido 505.670.3328 joel@garsagroup.com



PHOTOS

FOR LEASE

Retail Space Available
2860 Cerrillos Rd. Santa Fe, NM 87507

Carlos Garcia
505.670.3181
carlos@garsagroup.com

Joel Cumplido
505.670.3328
joel@garsagroup.com

2024 Forecasted by ESRI	1 Mile	3 Mile	5 Mile
Population	9,726	61,775	100,484
Households	4,425	28,638	45,933
Families	2,201	14,145	23,949
Average Households Size	2.16	2.12	2.18
Median Age	45.4	45.4	46.5
Media HH Income	\$56,313	\$69,304	\$76,587
Average HH Income	\$77,201	\$92,801	\$107,220
Total Business	874	4,225	6,818
Total Employees	8,127	82	80

HH Income – 1 mile radius

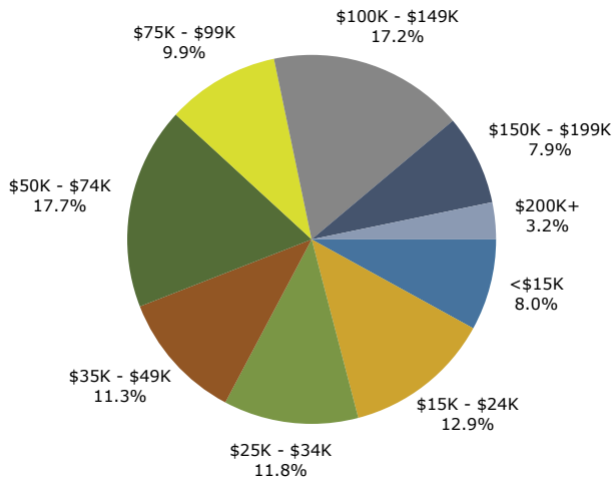

Population by Race – 1 mile radius

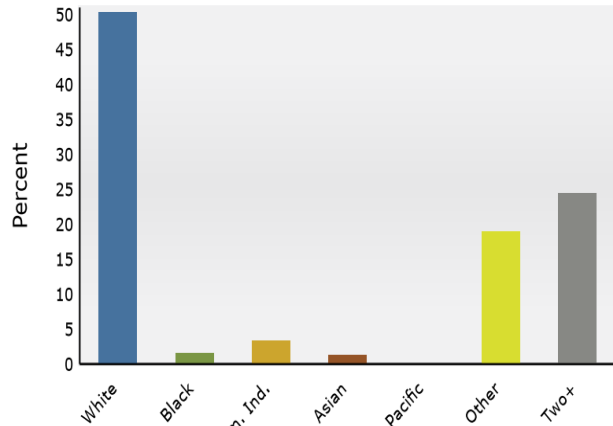

2024 Percent Hispanic Origin: 59.7%



The information contained in this flyer is believed reliable. While we do not doubt the accuracy, we have not verified it and make no guarantee, warranty or representation about it. It is your responsibility to independently confirm its accuracy and completeness. Any projection, opinion, assumption or estimated uses are for example only and do not represent the current or future performance of the property. The value of this transaction to you depends on many factors which should be evaluated by your tax, financial, and legal counsel. You and your counsel should conduct a careful independent investigation of the property to determine that it is suitable to your needs.

DEMOGRAPHICS

FOR LEASE

Retail Space Available
2860 Cerrillos Rd. Santa Fe, NM 87507

Carlos Garcia 505.670.3181 carlos@garsagroup.com
Joel Cumplido 505.670.3328 joel@garsagroup.com