

# 4800 EAST RIVER ROAD

FRIDLEY  
MINNEAPOLIS

4800 East River Road NE  
Fridley, MN



FOR LEASE

±585,225 SF



LEASED BY



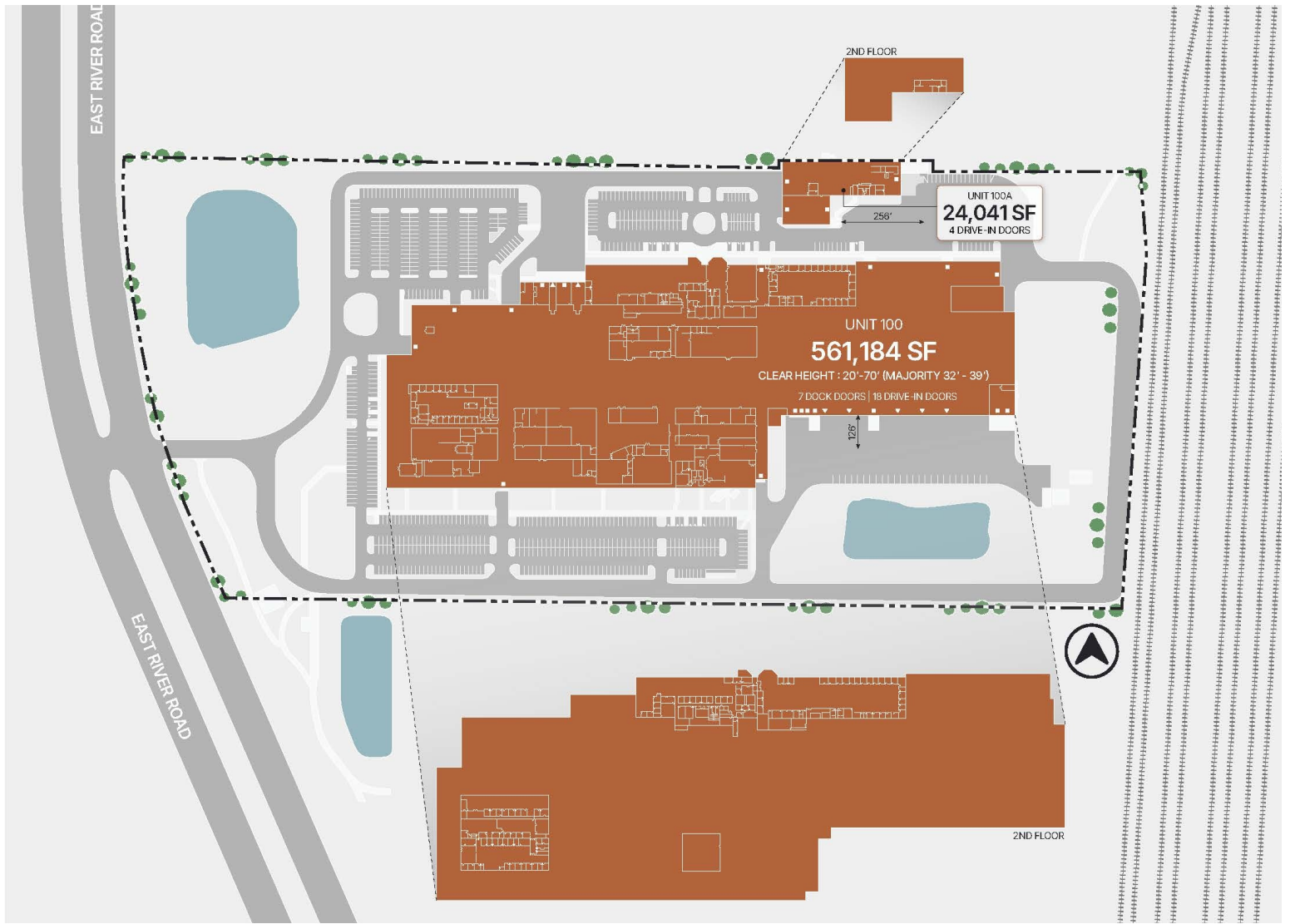

## PROPERTY OVERVIEW

4800 East River Road is a 585,225 SF Infill Industrial Facility offering redundant heavy power, high clear height, multiple loading options, and rail potential. The property is centrally and conveniently located in Fridley, minutes away from the Minneapolis CBD, with excellent access to I-94 and I-694, and Highway 100.

- > Building Renovated in 2015
- > Loading: 7 Docks (Ability to add additional), 18 Drive-in doors
- > Multiple cranes in place (10-ton to 30-ton)
- > BNSF Rail accessibility; internal spur possible
- > Fiber connectivity
- > Excellent access to I-94 and I-694, and Highway 100
- > Clear Height: 20' - 70', Majority 32' - 39'
- > Heavy Power: 17,000 Amps, 480 Volts, 3-phase, 4.8MW, Dual substations with 4.8MW
- > Parking: 682 stalls

## BUILDING SPECIFICATIONS

Available SF	Main Building: 561,184 SF North Building: 24,041 SF
Warehouse SF	Main Building: 390,294 SF North Building: 17,421 SF
Office SF	Main Building: 170,890 SF North Building: 6,620 SF
Loading	Main Building: Seven (7) dock doors, 18 drive-in doors North Building: Four (4) drive-in doors
Clear Height	20' - 70', Majority 32' - 39'
Lease Rate/Sale Price	Negotiable
2026 RE Tax & CAM	\$1.42 PSF



# FLOOR PLANS

NORTH BUILDING - AREA SCHEDULE			
SUITE		AREA	
NO.	ROOM		
LEVEL 01			
	OFFICE	4,935	SF
	WAREHOUSE	17,421	SF
LEVEL 02			
	OFFICE	1,685	SF
TOTAL		24,041	SF

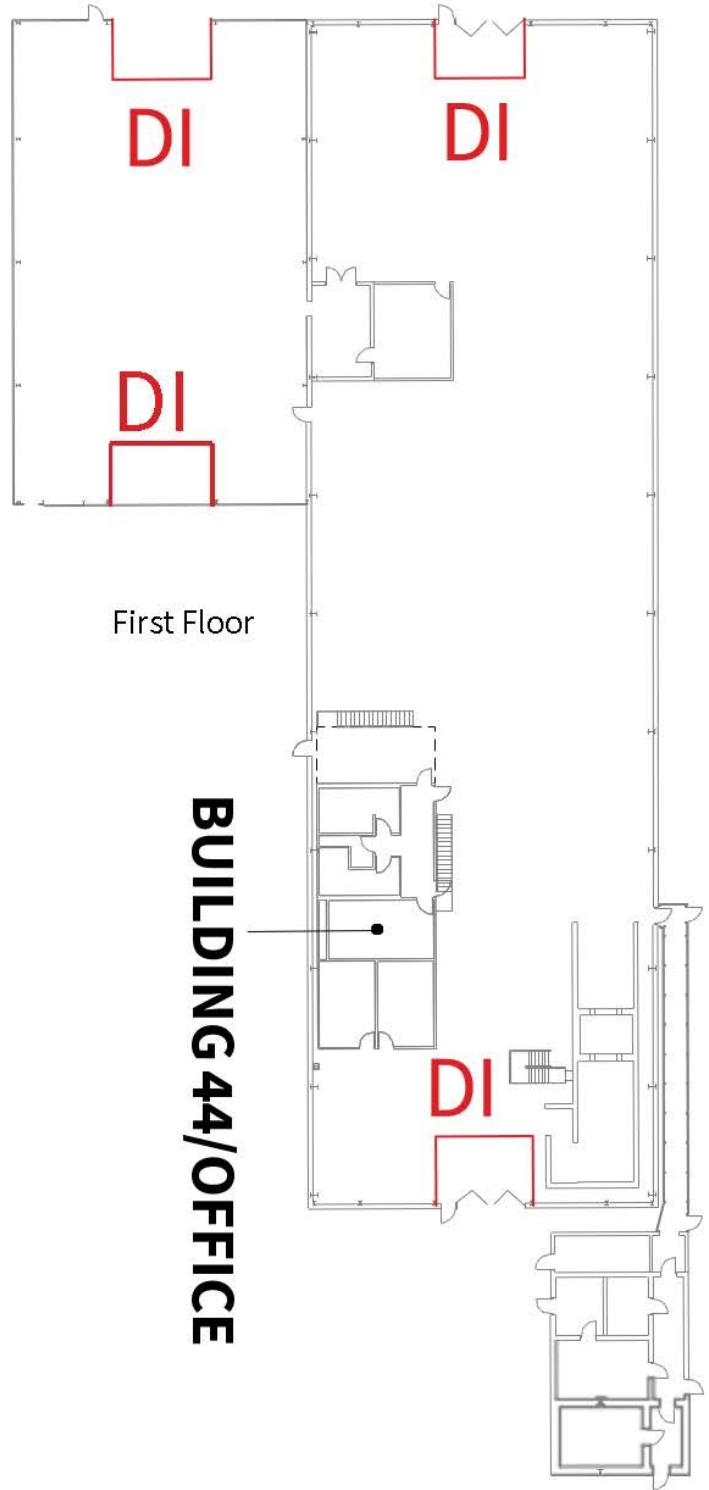

First Floor

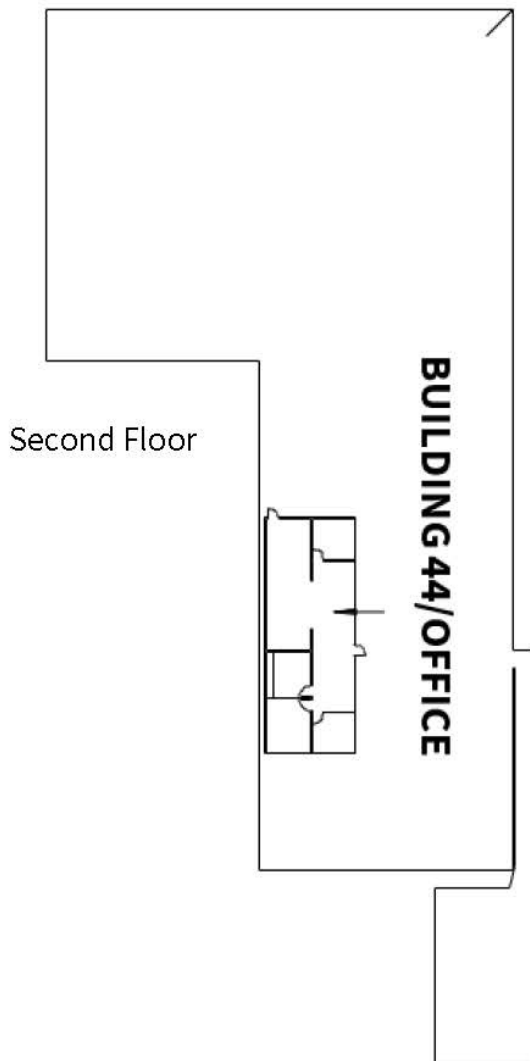

Second Floor

**BUILDING 44/OFFICE**







# Committed to Driving Value for Our Customers

## Properties with a Competitive Edge

Our scale, proprietary data and local relationships allow our 1,200+ skilled team members to help customers stay ahead of market trends.

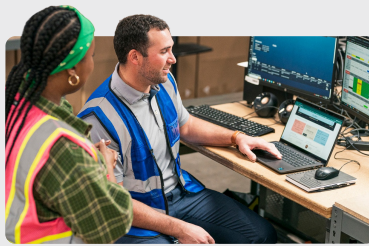

## Best-in-Class Customer Service

Our on-the-ground regional teams provide you with local expertise, leveraging data-driven insights to find the right solutions for your business.

## Link+

Our digital customer experience platform provides easy access to your property management teams, lease documents, billing and service requests. Sign up today!

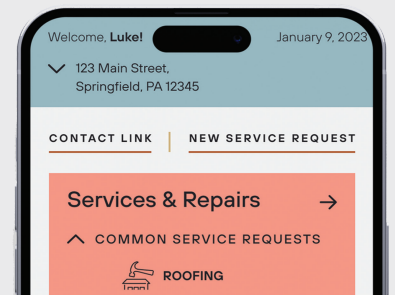

500 Million Square Foot Portfolio

## Energy Solutions

Link Logistics' award-winning utility management program helps customers save time and money while unlocking energy efficiency opportunities. Enroll today through Link+.

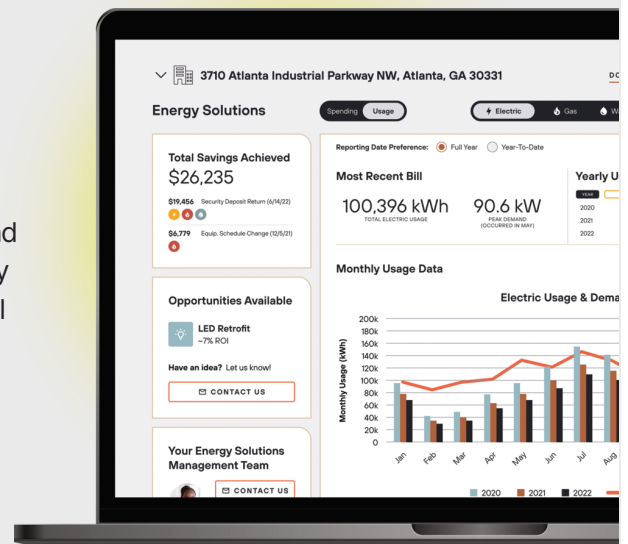

# CONTACT INFORMATION

4800 East River Rd NE  
Fridley, MN

**Eric Batiza, SIOR**

eric.batiza@jll.com  
(612) 217-5123

**Dan Larew, CCIM SIOR**

dan.larew@jll.com  
(612) 217-6726

This document is for informational purposes only and does not constitute an offer or acceptance of a lease. Any lease agreement must be in writing and signed by the landlord. No representations or warranties are made except as expressly stated in a signed lease. Information is provided "as is" and may be subject to errors or change without notice.



LEASED BY

