

# District 36 - 2751 (First Floor)

2751 36th Ave NW Norman, OK 73072

405-701-8881

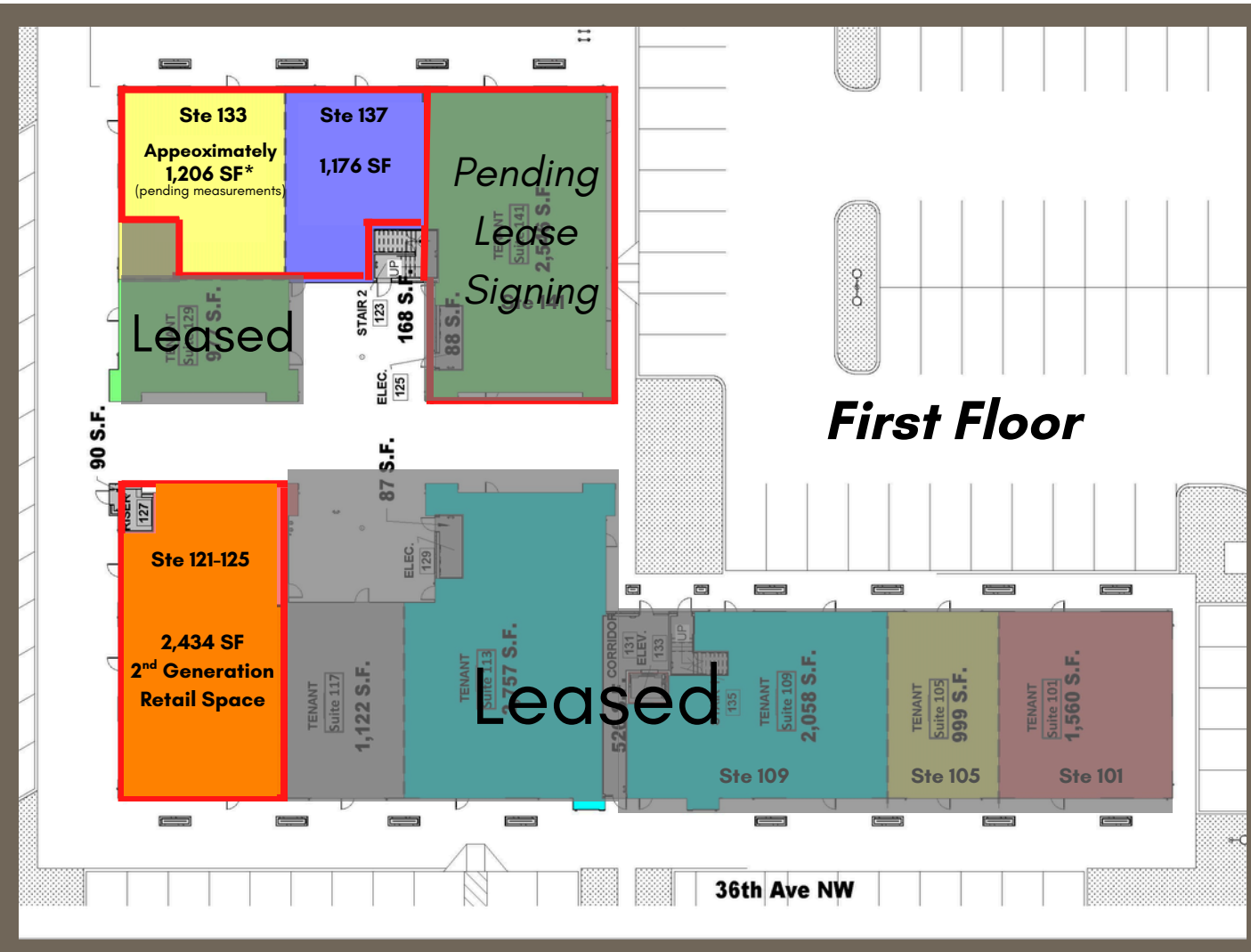

**First Floor**

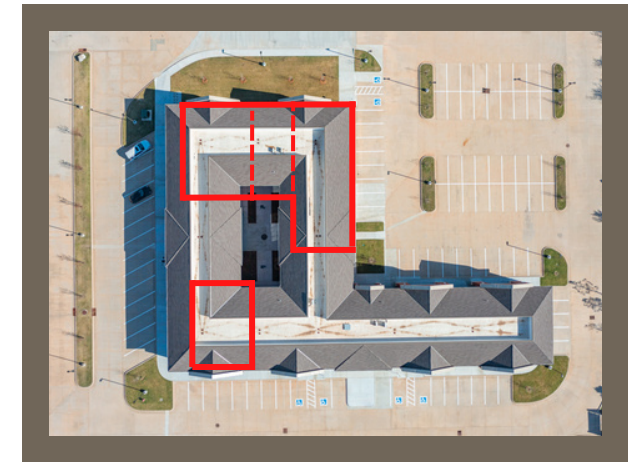

## Property Detail:

(Downstairs Availability)

### Suite Square Footage

- Suites 121-125: 2,434
- Suite 133: 1,206 SF\*
- Suite 137: 1,176
- Suite 141: 2,546 (pending lease)

\*Pending measurements

**Rental rate: \$20-22/SF + CAM**

# District 36 - 2751 (First Floor)

2751 36th Ave NW Norman, OK 73072

405-701-8881

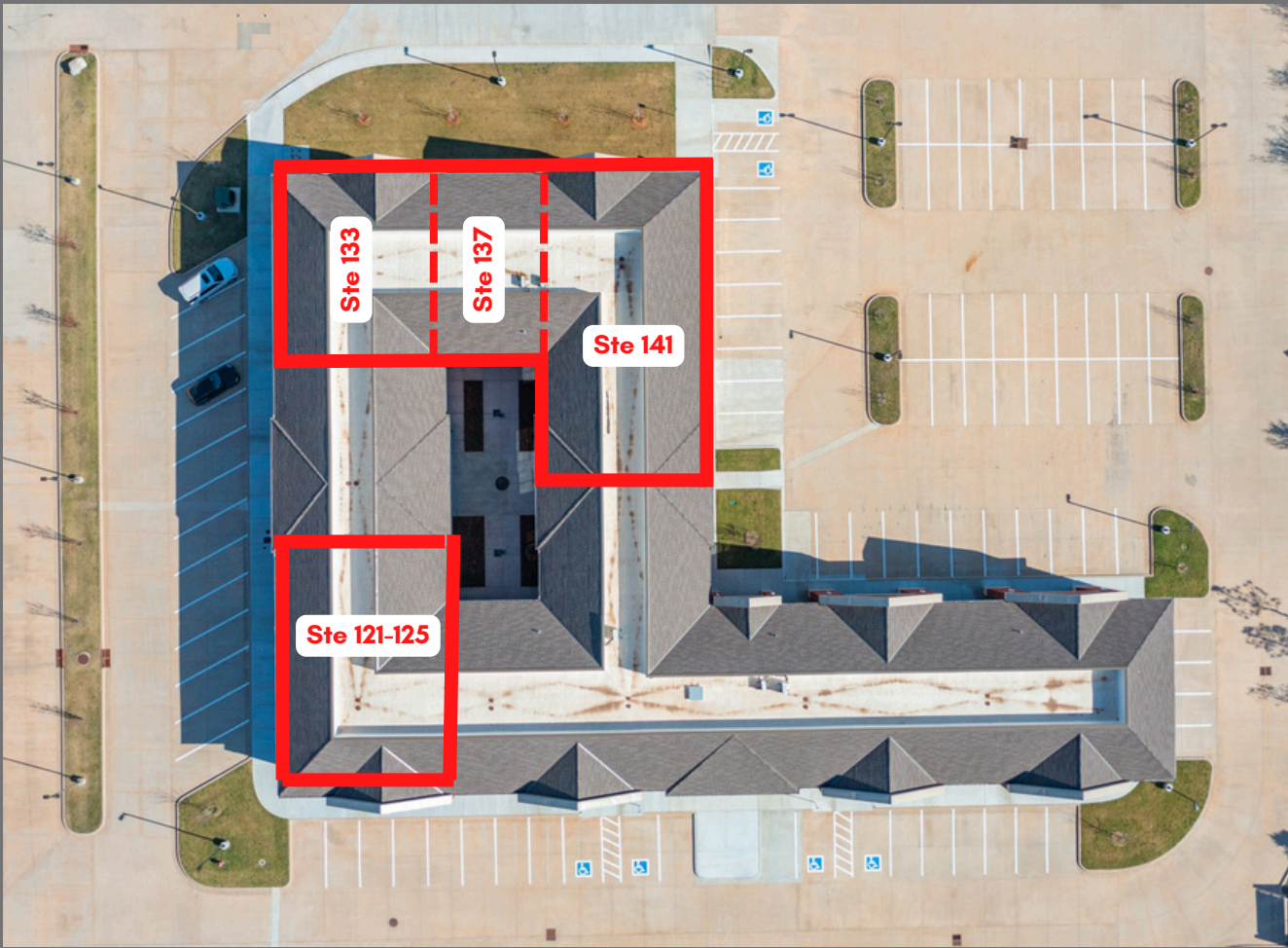

## Property Detail:

(Downstairs Availability)

### Suite Square Footage\*

- Suites 121-125: 2,434
- Suite 133: 1,206 (approx)
- Suite 137: 1,176
- Suite 141: 2,546 (lease pending)

*\*Adjacent suites can be combined for increased square footage*

**Rental rate:** \$20 - \$22/SF + CAM