



AVAILABLE	SIZE	RATE/MONTHLY
Office A	±12' x 13.5'	\$2,000
Office B	±18' x 13.5'	\$2,700
Office C	±13.5' x 16.5'	\$2,400
Office D	±13.5' x 11'	\$1,500
Four (4) Workstations		\$500 each
Entire 3,340 SF Suite is potentially available for \$4.35/Mo, FSG		

**TERM**

Through September 20, 2026

**FEATURES:**

- Plug N Play
- Furniture Included
- Receptionist Included
- Conference Room, Copier, Kitchen Available



AVAILABLE	SIZE	RATE/MONTHLY
Office A	±12' x 13.5'	\$2,000
Office B	±18' x 13.5'	\$2,700
Office C	±13.5' x 16.5'	\$2,400
Office D	±13.5' x 11'	\$1,500
Four (4) Workstations		\$500 each
Entire 3,340 SF Suite is potentially available for \$4.35/Mo, FSG		

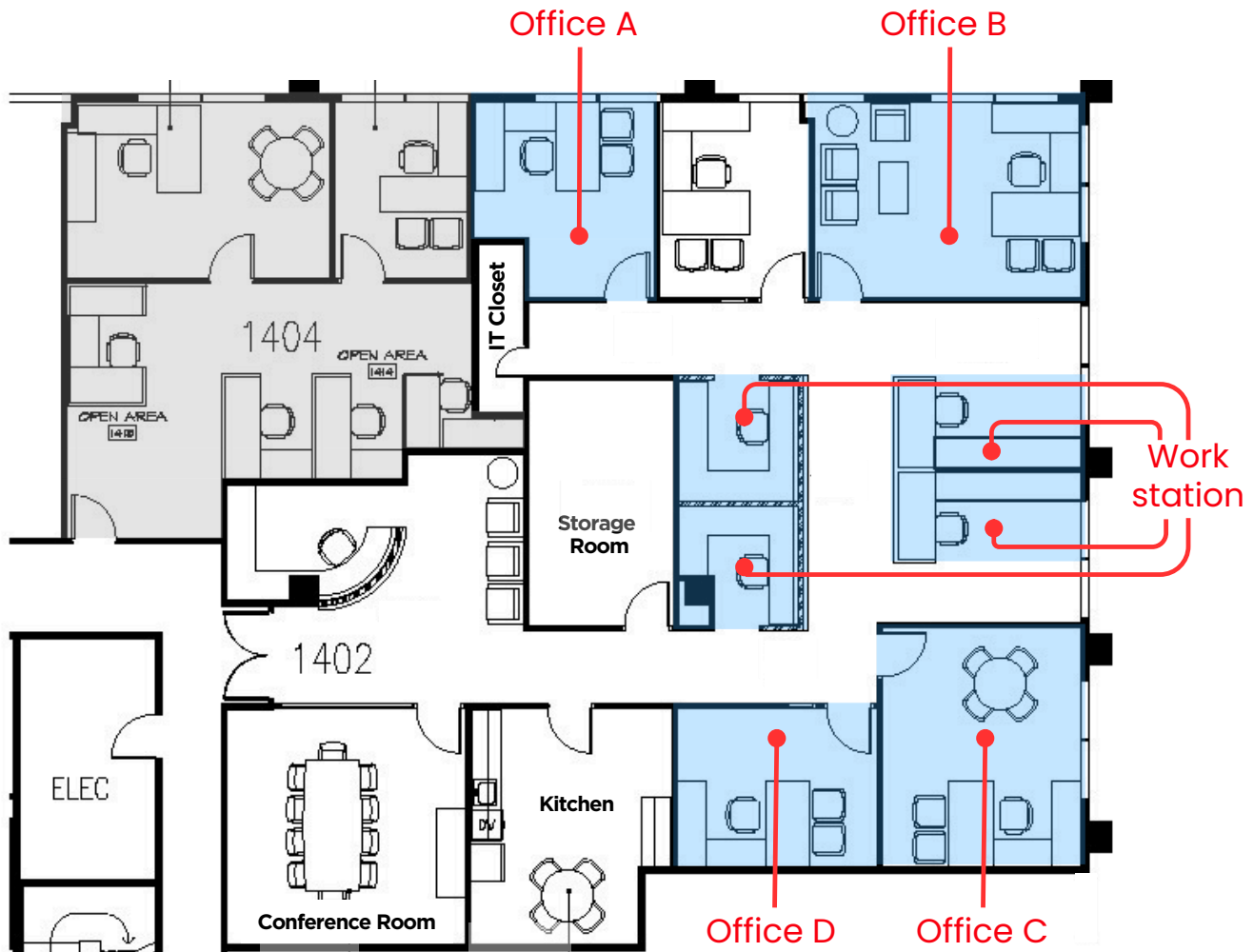

**Jeff Lipson**  
 310.202.9008 x 113  
[jlipson@wilshireag.com](mailto:jlipson@wilshireag.com)  
 DRE# 01196852



**Kiersten Echon**  
 310.202.9008 x 136  
[kiersten@wilshireag.com](mailto:kiersten@wilshireag.com)  
 DRE# 02339219