

AVAILABLE FOR SALE

±1,960 SF TO ±7,476 SF OFFICE CONDOS

**8300 UTICA AVENUE
CONDOS 200, 245 & 250**
RANCHO CUCAMONGA, CALIFORNIA



JEFF BISCHOFBERGER
SENIOR VICE PRESIDENT/PRINCIPAL
909.373.2708
jbischof@lee-assoc.com
DRE #01512151

GREG MARTIN
SENIOR VICE PRESIDENT/PRINCIPAL
909.373.2904
gmartin@lee-assoc.com
DRE #01001749

LEE & ASSOCIATES - ONTARIO
3535 Inland Empire Boulevard
Ontario, California 91764
(909) 989-7771 | lee-associates.com

LEE & ASSOCIATES
COMMERCIAL REAL ESTATE SERVICES
ONTARIO
CORPORATE ID #00976995

**±1,960 SF TO ±7,476 SF AVAILABLE
FOR SALE**

**8300 UTICA AVENUE
CONDOS 200, 245 & 250
RANCHO CUCAMONGA, CALIFORNIA**

PROPERTY & CONDO FEATURES

- ±35,150 SQUARE FOOT MEDICAL / OFFICE CONDOS
- ±1,960 SQUARE FEET TO ±7,476 SQUARE FEET
- COMMON AREA CONFERENCE ROOM ON FIRST FLOOR
- ELEVATOR SERVED
- ADJACENT TO RANCHO CUCAMONGA CITY HALL
- ADJACENT TO THE SAN BERNARDINO COUNTY COURT HOUSE
- EXCELLENT RANCHO CUCAMONGA CIVIC CENTER LOCATION
- PROFESSIONALLY MANAGED
- WALKING DISTANCE TO THE NEW HAVEN CITY MARKET PLACE
- MINUTES AWAY FROM ROUTE 66 + RESTAURANTS AND RETAIL SHOPS
- EXCELLENT ACCESS TO THE I-10 & CA-210 FREEWAYS VIA HAVEN AVENUE
- ACCESS TO THE I-15 FREEWAY VIA FOOTHILL BOULEVARD
- LOCATED IN THE HEART OF THE INLAND EMPIRE



JEFF BISCHOFBERGER
SENIOR VICE PRESIDENT/PRINCIPAL
909.373.2708
jbischof@lee-assoc.com
DRE #01512151

GREG MARTIN
SENIOR VICE PRESIDENT/PRINCIPAL
909.373.2904
gmartin@lee-assoc.com
DRE #01001749

LEE & ASSOCIATES - ONTARIO
3535 Inland Empire Boulevard
Ontario, California 91764
(909) 989-7771 | lee-associates.com

LEE & ASSOCIATES
COMMERCIAL REAL ESTATE SERVICES
ONTARIO
CORPORATE ID #00976995

**±1,960 SF TO ±7,476 SF AVAILABLE
FOR SALE**

**8300 UTICA AVENUE
CONDOS 200, 245 & 250
RANCHO CUCAMONGA, CALIFORNIA**

CONDOS
200, 245 & 250
FLOOR PLANS

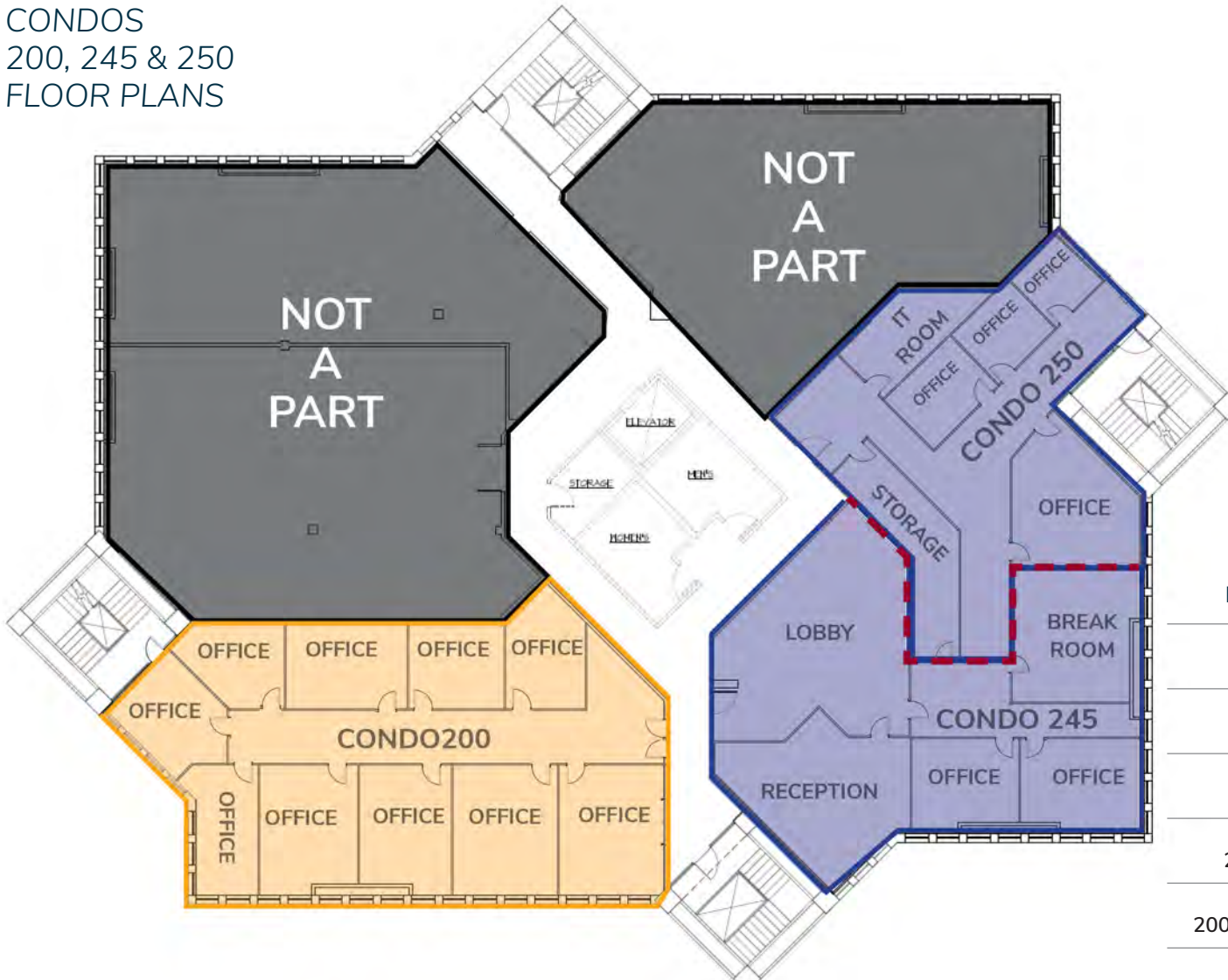

SUITE NUMBER	SQUARE FOOTAGE	PRICE PER SF	SALE PRICE
200	±3,067 RSF	\$435.00	\$1,334,145.00
245	±2,453 SF	\$440.00	\$1,079,320.00
250	±1,960 SF	\$450.00	\$882,000.00
245 + 250	±4,409 SF	\$430.00	\$1,895,870.00
200 + 245 + 250	±7,476 SF	\$415.00	\$3,102,540.00

JEFF BISCHOFBERGER
SENIOR VICE PRESIDENT/PRINCIPAL
909.373.2708
jbischof@lee-assoc.com
DRE #01512151

GREG MARTIN
SENIOR VICE PRESIDENT/PRINCIPAL
909.373.2904
gmartin@lee-assoc.com
DRE #01001749

LEE & ASSOCIATES - ONTARIO
3535 Inland Empire Boulevard
Ontario, California 91764
(909) 989-7771 | lee-associates.com

LEE & ASSOCIATES
COMMERCIAL REAL ESTATE SERVICES
ONTARIO
CORPORATE ID #00976995

**±1,960 SF TO ±7,476 SF AVAILABLE
FOR SALE**

**8300 UTICA AVENUE
CONDOS 200, 245 & 250
RANCHO CUCAMONGA, CALIFORNIA**



JEFF BISCHOFBERGER
SENIOR VICE PRESIDENT/PRINCIPAL
909.373.2708
jbischof@lee-assoc.com
DRE #01512151

GREG MARTIN
SENIOR VICE PRESIDENT/PRINCIPAL
909.373.2904
gmartin@lee-assoc.com
DRE #01001749

LEE & ASSOCIATES - ONTARIO
3535 Inland Empire Boulevard
Ontario, California 91764
(909) 989-7771 | lee-associates.com

LEE & ASSOCIATES
COMMERCIAL REAL ESTATE SERVICES
ONTARIO
CORPORATE ID #00976995

All information furnished regarding property for sale, rental or financing is from sources deemed reliable, but no warranty or representation is made to the accuracy thereof and same is submitted to errors, omissions, change of price, rental or other conditions prior to sale, lease or financing or withdrawal without notice. No liability of any kind is to be imposed on the broker herein.

**±1,960 SF TO ±7,476 SF AVAILABLE
FOR SALE**

**8300 UTICA AVENUE
CONDOS 200, 245 & 250
RANCHO CUCAMONGA, CALIFORNIA**



JEFF BISCHOFBERGER
SENIOR VICE PRESIDENT/PRINCIPAL
909.373.2708
jbischof@lee-assoc.com
DRE #01512151

GREG MARTIN
SENIOR VICE PRESIDENT/PRINCIPAL
909.373.2904
gmartin@lee-assoc.com
DRE #01001749

LEE & ASSOCIATES - ONTARIO
3535 Inland Empire Boulevard
Ontario, California 91764
(909) 989-7771 | lee-associates.com

LEE & ASSOCIATES
COMMERCIAL REAL ESTATE SERVICES
ONTARIO
CORPORATE ID #00976995

**±1,960 SF TO ±7,476 SF AVAILABLE
FOR SALE**

**8300 UTICA AVENUE
CONDOS 200, 245 & 250
RANCHO CUCAMONGA, CALIFORNIA**

**LOCATION
MAP**

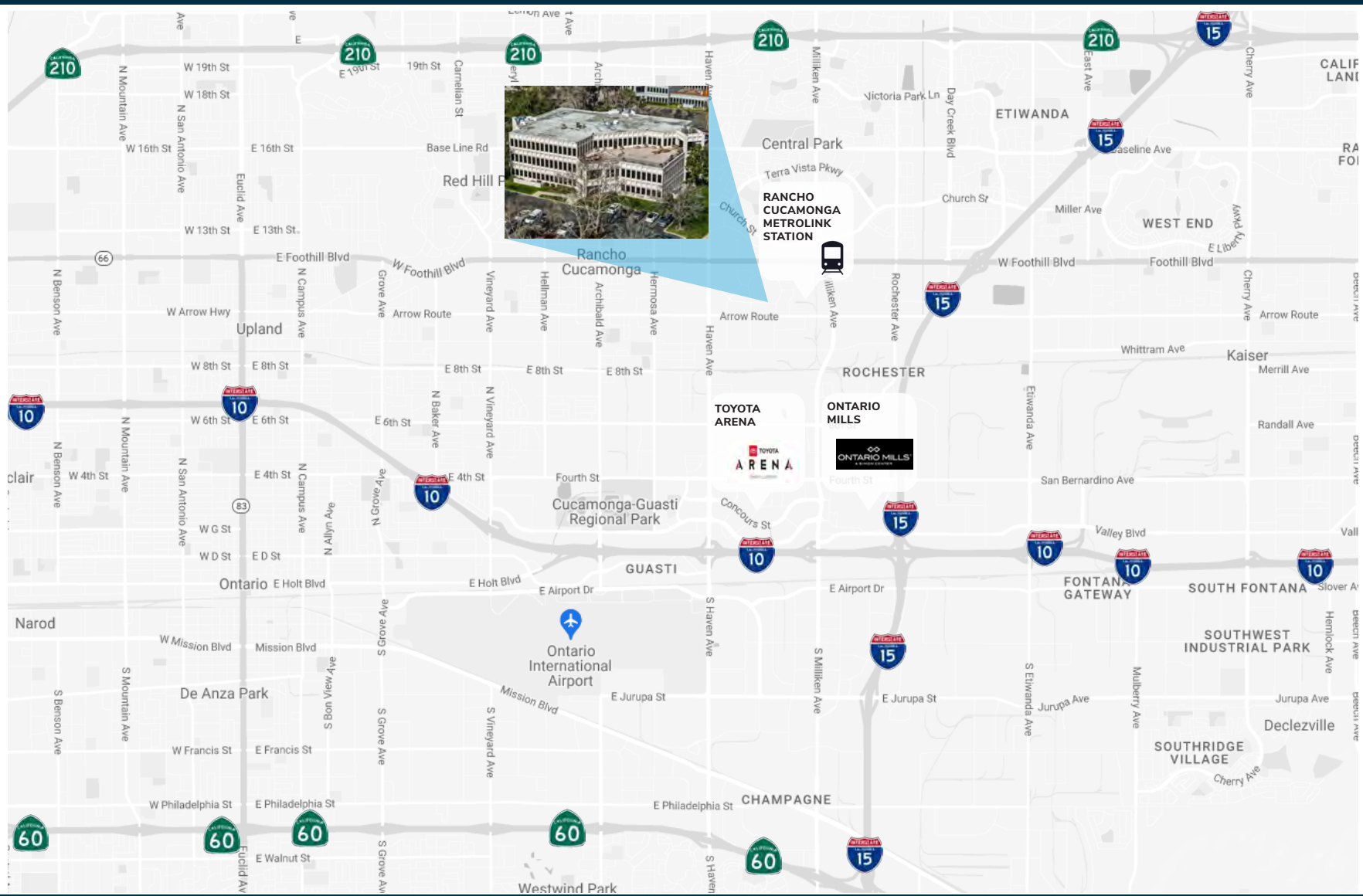

JEFF BISCHOFBERGER
SENIOR VICE PRESIDENT/PRINCIPAL
909.373.2708
jbischof@lee-assoc.com
DRE #01512151

GREG MARTIN
SENIOR VICE PRESIDENT/PRINCIPAL
909.373.2904
gmartin@lee-assoc.com
DRE #01001749

LEE & ASSOCIATES - ONTARIO
3535 Inland Empire Boulevard
Ontario, California 91764
(909) 989-7771 | lee-associates.com



CORPORATE ID #00976995

All information furnished regarding property for sale, rental or financing is from sources deemed reliable, but no warranty or representation is made to the accuracy thereof and same is submitted to errors, omissions, change of price, rental or other conditions prior to sale, lease or financing or withdrawal without notice. No liability of any kind is to be imposed on the broker herein.

8300 UTICA AVENUE CONDOS 200, 245 & 250

RANCHO CUCAMONGA, CALIFORNIA

FOR MORE INFORMATION, PLEASE CONTACT:

JEFF BISCHOFBERGER

SENIOR VICE PRESIDENT/PRINCIPAL

909.373.2708

jbischof@lee-assoc.com

DRE #01512151

GREG MARTIN

SENIOR VICE PRESIDENT/PRINCIPAL

909.373.2904

gmartin@lee-assoc.com

DRE #01001749

LEE & ASSOCIATES - ONTARIO

3535 Inland Empire Boulevard | Ontario, California 91764

(909) 989-7771 | lee-assoc.com

Corporate ID: 00976995



COMMERCIAL REAL ESTATE SERVICES
ONTARIO