

Pompano Business Center



FOR LEASE

Suite 2036

BROWARD COUNTY
POMPAÑO BEACH ±14,683 SF



2036 NW 25TH AVENUE
POMPANO BEACH, FL



BUILDING HIGHLIGHTS

SF AVAILABLE	±14,683 SF
OFFICE SF	±1,832 SF
DOCK HIGH DOORS	5
CLEAR HEIGHT	24'
SPRINKLERS	ESFR
LOCATION	LESS THAN 1 MILE FROM FLORIDA'S TURNPIKE AND I-95
AVAILABILITY	August 1, 2026

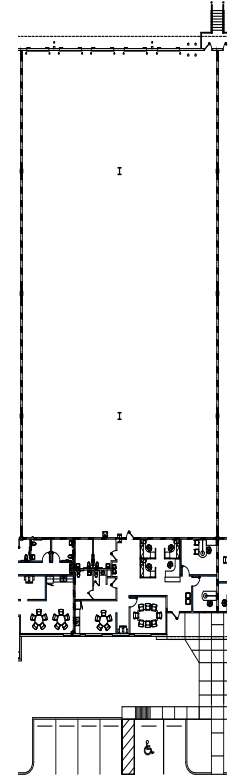

Michael Oretsky
michael.oretzky@cbre.com
(954) 798-4284

Tom O'Loughlin
tom.oloughlin@cbre.com
(954) 817-3919