



6345  
Baywood  
Orthopedic  
Clinic

FOR LEASE | MEDICAL OFFICE

# BAYWOOD MEDICAL OFFICE

6345 E BAYwood Ave, Mesa, AZ 85206

Steve Beck President & Associate Broker / 480.610.2400 / steve@coberealestate.com

Preston Beck Advisor / 480.610.2400 / preston@coberealestate.com



[coberealestate.com](http://coberealestate.com)

FOR LEASE | MEDICAL OFFICE

# Baywood Medical Office

6345 E Baywood Ave, Mesa, AZ 85206



## PROPERTY SUMMARY

Available SF:	1,750 SF
Lease Rate:	\$25 SF/yr (NNN)
Building Size:	3,500 SF
Zoning:	OC
Suites Available:	4 Suites Available 5 Days/Week

## DISTANCE TO:

Banner Health	2 Miles
US-60	.5 Miles
WinCo, Walmart, & Other Shopping	2 Miles

## VIRTUAL TOUR

## PROPERTY OVERVIEW

Strategically positioned in Mesa's established Baywood medical corridor, directly adjacent to Banner Baywood Medical Center in the heart of the East Valley's premier healthcare district. This lease includes access to shared medical office facilities featuring multiple exam rooms and a doctor's office. Tenants will also benefit from common areas including a shared reception area, break room, and restrooms. Regular dates for access are outlined below.

## PROPERTY HIGHLIGHTS

- Great location with easy access and parking for patients and staff
- Updated interior with modern finishes
- Shared Staff Areas: Reception, Break Room, Restrooms, & Doctor's Office
- Space Availability: Daily access to staff areas | Access to 4 exam rooms Monday-Friday

Steve Beck | President & Associate Broker

O: 480.610.2400 C: 480.251.1505

steve@coberealestate.com

www.coberealestate.com

Preston Beck | Advisor

O: 480.610.2400 C: 480.650.2029

preston@coberealestate.com

www.coberealestate.com



FOR LEASE | MEDICAL OFFICE

# Baywood Medical Office

6345 E Baywood Ave, Mesa, AZ 85206



Steve Beck | President & Associate Broker  
O: 480.610.2400 C: 480.251.1505  
steve@coberealestate.com  
www.coberealestate.com

Preston Beck | Advisor  
O: 480.610.2400 C: 480.650.2029  
preston@coberealestate.com  
www.coberealestate.com



FOR LEASE | MEDICAL OFFICE

# Baywood Medical Office

6345 E Baywood Ave, Mesa, AZ 85206

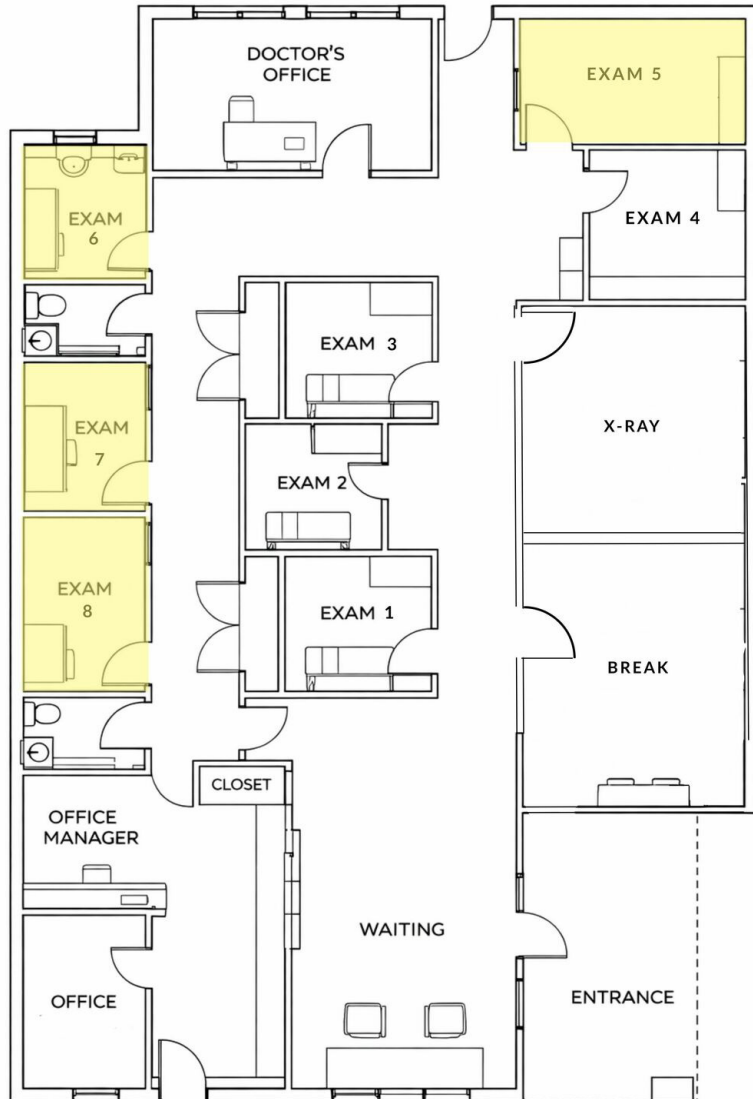

Steve Beck | President & Associate Broker  
O: 480.610.2400 C: 480.251.1505  
steve@coberealestate.com  
www.coberealestate.com

Preston Beck | Advisor  
O: 480.610.2400 C: 480.650.2029  
preston@coberealestate.com  
www.coberealestate.com



FOR LEASE | MEDICAL OFFICE

# Baywood Medical Office

6345 E Baywood Ave, Mesa, AZ 85206

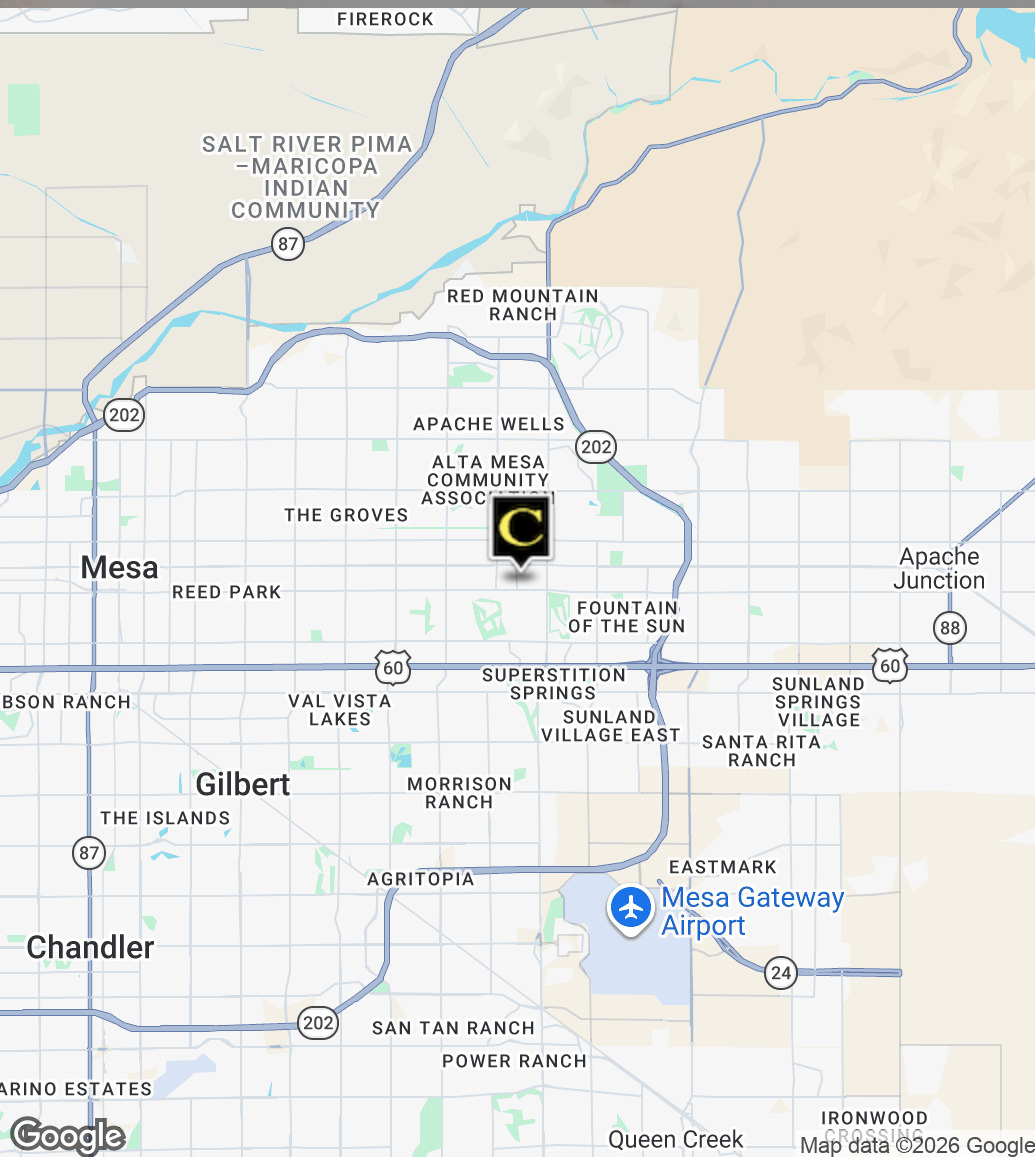

Steve Beck | President & Associate Broker  
O: 480.610.2400 C: 480.251.1505  
steve@coberealestate.com  
www.coberealestate.com

Preston Beck | Advisor  
O: 480.610.2400 C: 480.650.2029  
preston@coberealestate.com  
www.coberealestate.com



# Baywood Medical Office

6345 E Baywood Ave, Mesa, AZ 85206

## POPULATION

	1 MILE	2 MILES	3 MILES
Total Population	11,042	47,043	115,979
Average Age	59	52	47
Average Age (Male)	57	50	46
Average Age (Female)	60	54	49

## HOUSEHOLDS & INCOME

	1 MILE	2 MILES	3 MILES
Total Households	5,479	21,843	50,513
# of Persons per HH	2	2.2	2.3
Average HH Income	\$79,003	\$82,417	\$92,607
Average House Value	\$282,361	\$334,197	\$377,017

2020 American Community Survey (ACS)

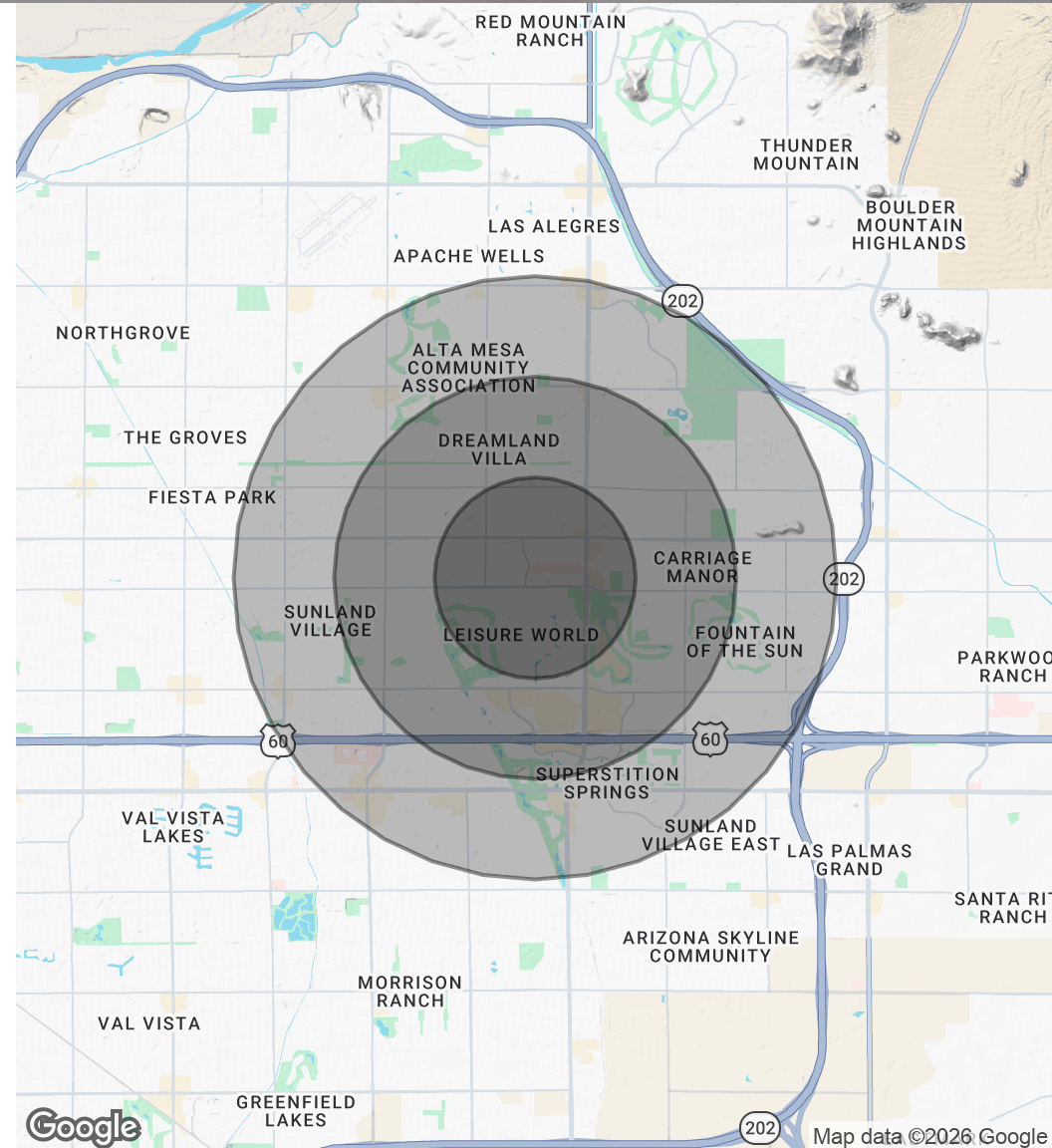

Steve Beck | President & Associate Broker  
 O: 480.610.2400 C: 480.251.1505  
 steve@coberealestate.com  
 www.coberealestate.com

Preston Beck | Advisor  
 O: 480.610.2400 C: 480.650.2029  
 preston@coberealestate.com  
 www.coberealestate.com

