

POTOMAC MEDICAL PLAZA SPEC SUITE 315 | 1,721 RSF

1550 SOUTH POTOMAC STREET
AURORA, CO 80012



SCAN TO LEARN MORE ABOUT THIS LISTING

Seafoam



IMAGE IS A REPRESENTATION. ACTUAL SUITE MAY DIFFER.

LEASE THIS MODERN, MOVE-IN READY MEDICAL SUITE

COMING SOON!

Pre-Lease Your Move-In Ready SPEC Suite Today

Our SPEC suites combine convenience and quality in one perfect package. With sleek, modern finishes already in place, these suites are designed to be fully operational as soon as you move in. **Skip the hassle and delays of construction and permitting**—just move in and start seeing patients!



FOR LEASING INFORMATION, CONTACT:

REGIONAL LEASING DIRECTOR: Jack Schuber | jack.schuber@lillibridge.com / 720.357.1719

SPEC SUITE - SEAFOAM FINISH PALETTE

SUITE 315 | 1,721 RSF
POTOMAC MEDICAL PLAZA



LUXURY VINYL TILE

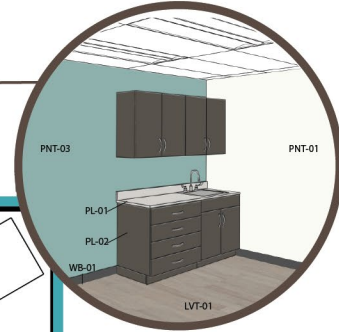

FINISH RENDERING



RECEPTION / WAITING ROOM



BATHROOM FLOOR TILE & WALL BASE



LAMINATE COUNTERTOP



PLASTIC LAMINATE CABINETS

BATHROOM WALL TILE



HARDWARE / METAL FINISH

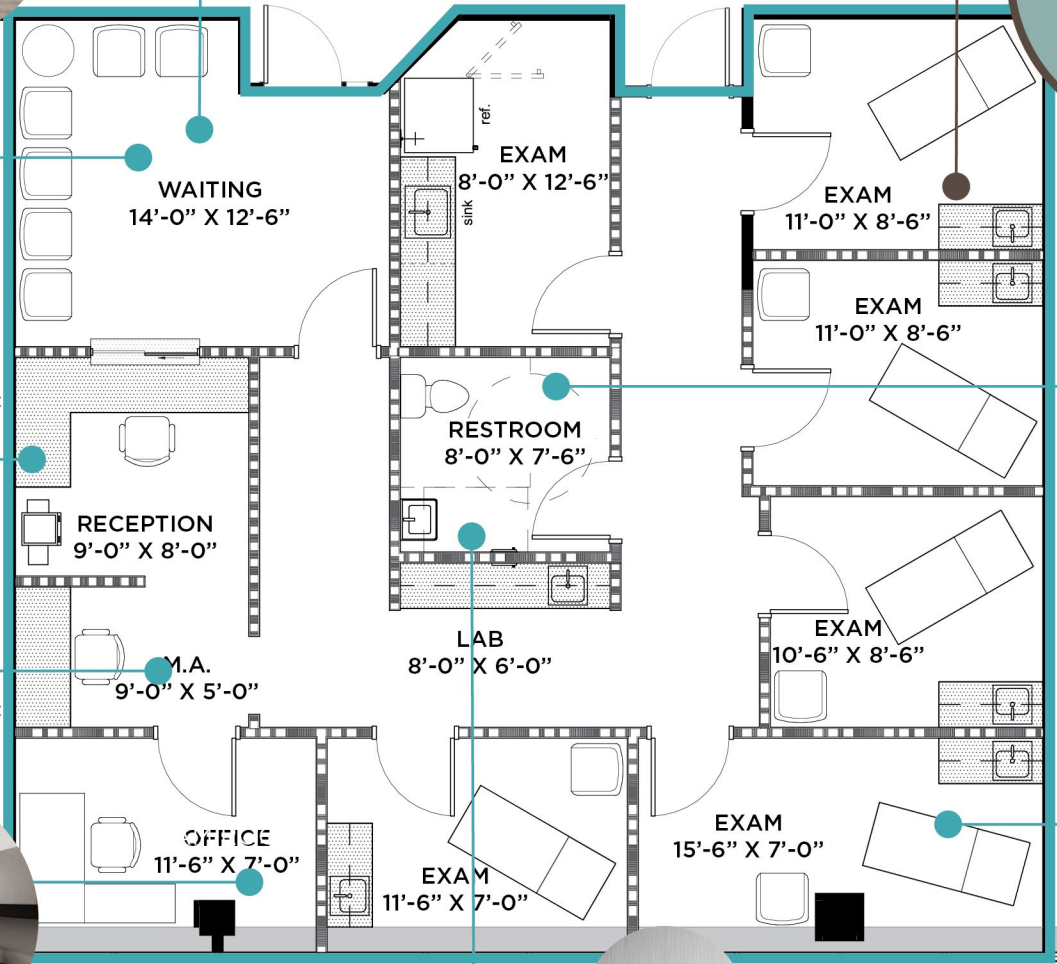

SEAFOAM COLOR PALETTE

PNT-01:
OVERALL PAINT

PNT-02:
ACCENT PAINT - OFFICE

PNT-03:
ACCENT PAINT - PATIENT ROOM

PNT-04:
DOOR FRAME PAINT

PHOTOS AND RENDERINGS DEPICT FINISHES AND COLOR SCHEME, NOT THE ACTUAL SUITE.