

RETAIL

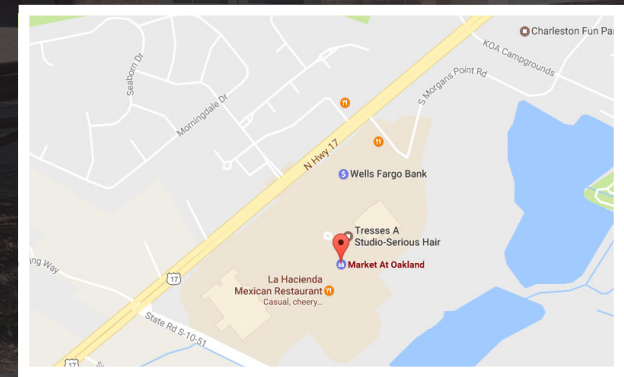

Other Shops include

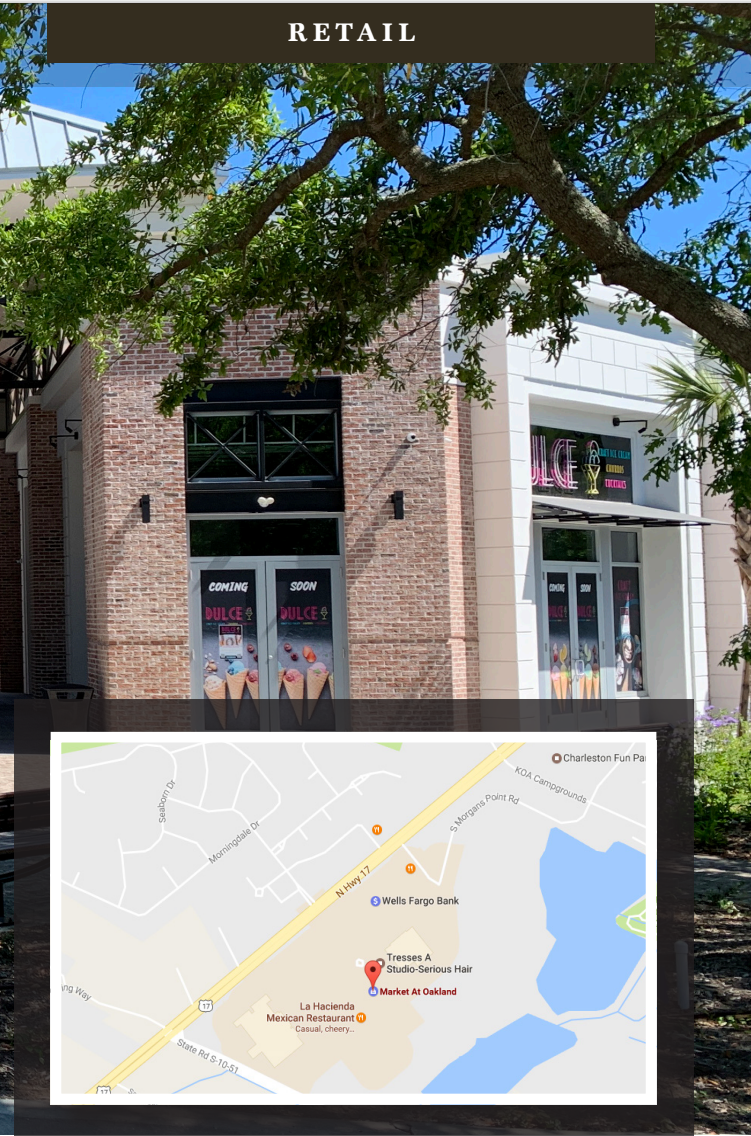

LOCATION

OFFERED BY



(843) 856-4600  
www.belklucy.com

Blair Belk, CCIM  
blair.belk@belklucy.com  
(843) 606-5449 — direct office  
(843) 709-9292 — mobile

AND

Trey Lucy  
trey.lucy@belklucy.com  
(843) 606-5455 — direct office  
(843) 566-2867 — mobile

**PROPERTY INFORMATION**

Belk | Lucy is pleased to present the exclusive listing for Oak Court, which is an approximately 12,000sf shadow anchor building of The Market at Oakland. The 415,000sf Market at Oakland is a attractive shopping center featuring an eclectic mix of national and local retailers and restaurants. Anchored by Walmart and Kohl's, other tenants include Starbucks, Trek, Orangetheory Fitness, East Bay Deli, Pure Barre, La Hacienda and many others. Oak Court features top quality design and construction. With convenient access, high visibility, and surrounding dense population, this is an excellent opportunity to join other highly successful area retailers.

| AVAILABILITIES            |          |                |
|---------------------------|----------|----------------|
| Suite 6                   | 2,066 sf | \$35.00/sf NNN |
| CAM, Taxes, & Ins. (est.) |          | \$7.92/sf      |

| DEMOGRAPHICS (3- MILE) |            |
|------------------------|------------|
| Population             | 33,779     |
| Households             | 13,377     |
| Avg. Household Income  | \$175,916  |
| Traffic Count          | 41,500 VPD |



**AREA DESCRIPTION**

The Town of Mount Pleasant is an affluent South Carolina coastal community which is part of the 850,000-person Charleston, SC Metropolitan Statistical Area. Designated an "All-American City" in 2018, the town is South Carolina's fourth largest municipality. A leader in growth, this flourishing community was recently ranked number one fastest-growing city in the state and number two fast-growing city in the country. Known for its high quality of life, people flock to this charming suburban town for its proximity to area beaches, outdoor activities, shopping and dining amenities, and laid-back atmosphere. Additionally, this dynamic community has proven to be an outstanding location for business, offering a highly desirable lifestyle to attract and retain key employees, while providing an available "highly skilled" regional workforce.

OFFERED BY



(843) 856-4600  
www.belklucy.com

Blair Belk, CCIM  
blair.belk@belklucy.com  
(843) 606-5449 — direct office  
(843) 709-9292 — mobile

AND

Trey Lucy  
trey.lucy@belklucy.com  
(843) 606-5455 — direct office  
(843) 566-2867 — mobile

SITE PLAN

PRODUCED BY AN AUTODESK STUDENT VERSION

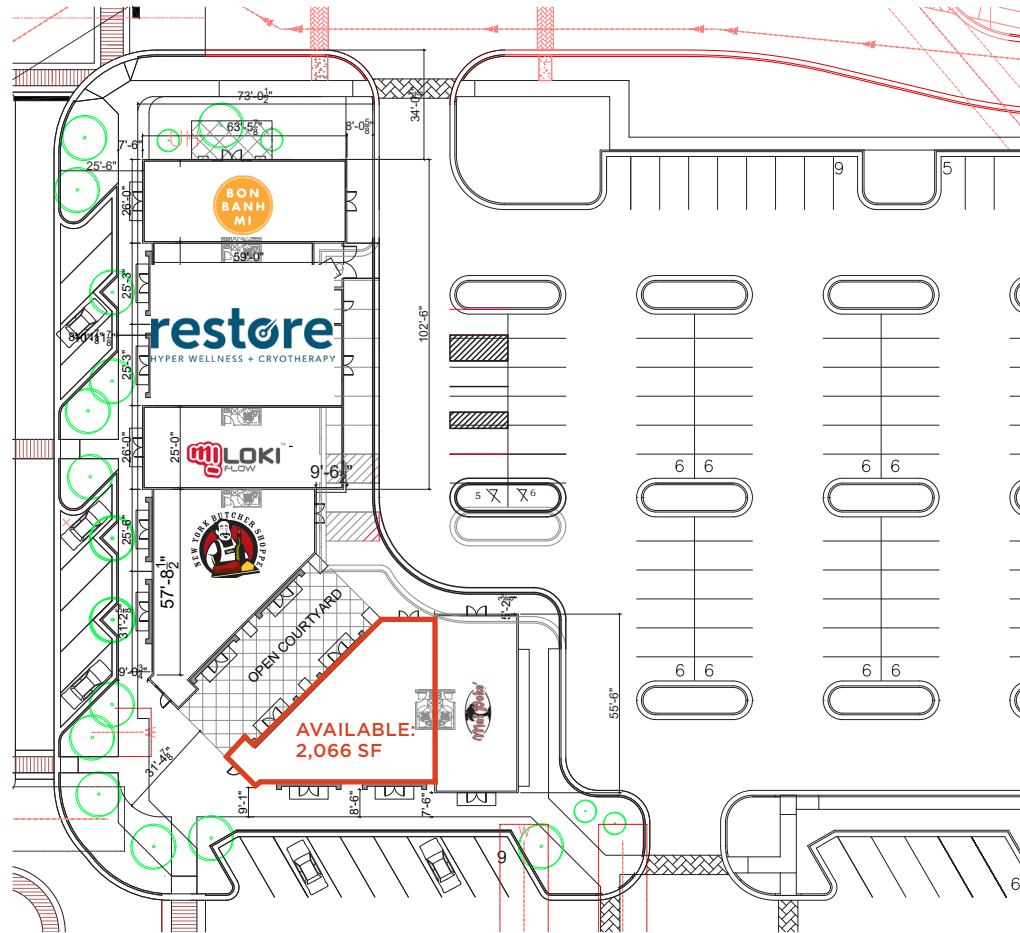

OFFERED BY



(843) 856-4600  
www.belklucy.com

Blair Belk, CCIM  
blair.belk@belklucy.com  
(843) 606-5449 — direct office  
(843) 709-9292 — mobile

AND

Trey Lucy  
trey.lucy@belklucy.com  
(843) 606-5455 — direct office  
(843) 566-2867 — mobile

INTERIOR PHOTOS



OFFERED BY



(843) 856-4600  
www.belklucy.com

Blair Belk, CCIM  
blair.belk@belklucy.com  
(843) 606-5449 — direct office  
(843) 709-9292 — mobile

AND

Trey Lucy  
trey.lucy@belklucy.com  
(843) 606-5455 — direct office  
(843) 566-2867 — mobile

AERIAL VIEW OF CENTER



OFFERED BY



(843) 856-4600  
www.belklucy.com

Blair Belk, CCIM  
blair.belk@belklucy.com  
(843) 606-5449 — direct office  
(843) 709-9292 — mobile

AND

Trey Lucy  
trey.lucy@belklucy.com  
(843) 606-5455 — direct office  
(843) 566-2867 — mobile