

AVAILABLE FOR LEASE
±14,800 SF INDUSTRIAL WAREHOUSE SPACE WITH A LARGE YARD

3040 W. NIELSEN AVE

FRESNO, CA

Proposed
Westgate Industrial Center
800,000 SF

Dashmesh Truck Driving
School & Services

 **Manheim**
by Cox Automotive

 **TOPLINE**
AUTO SERVICES

CALIFORNIA
180

MARKS AVE

YARD SPACE
2.65± AC

BUILDING
14,800 ± SF

 **Station 54**

 **RM KING**

United Tires & Truck Repair

W. NIELSEN AVE

 **Fresno
Economic
Opportunities
Commission**

 **A&M**
HENKELS & MFCOY

For further information, please contact:

Cary Marsella

Direct Line: 831/461.5222

cmarsella@retailassociates.com

DRE License #01121565



COMMERCIAL | RETAIL
ASSOCIATES

7502 North Colonial Avenue, Suite 101 | Fresno, California 93711
www.RetailAssociates.com

All projections, opinions, assumptions or estimates are supplied for example only and may not represent current or future performance of the property. Any and all information pertaining to location, demographics and the site plan is supplied by sources believed to be reliable. We do not guarantee the accuracy of information and make no warranty or representation thereto. All information is presented here with the possibility of errors, omissions, change of price, rental or other conditions, prior sale, lease or financing, or withdrawal without notice. Commercial Retail Associates operates under the corporate Department of Real Estate License #01121565.



AVAILABLE FOR LEASE

±14,800 SF INDUSTRIAL WAREHOUSE SPACE WITH A LARGE YARD

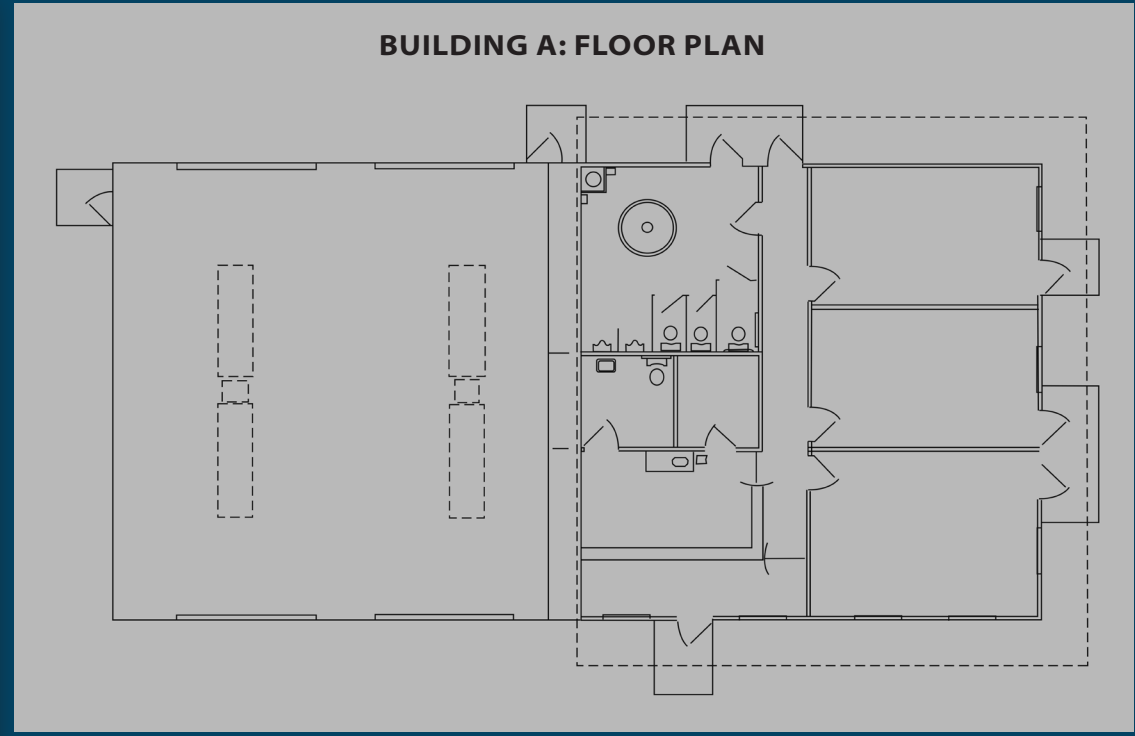
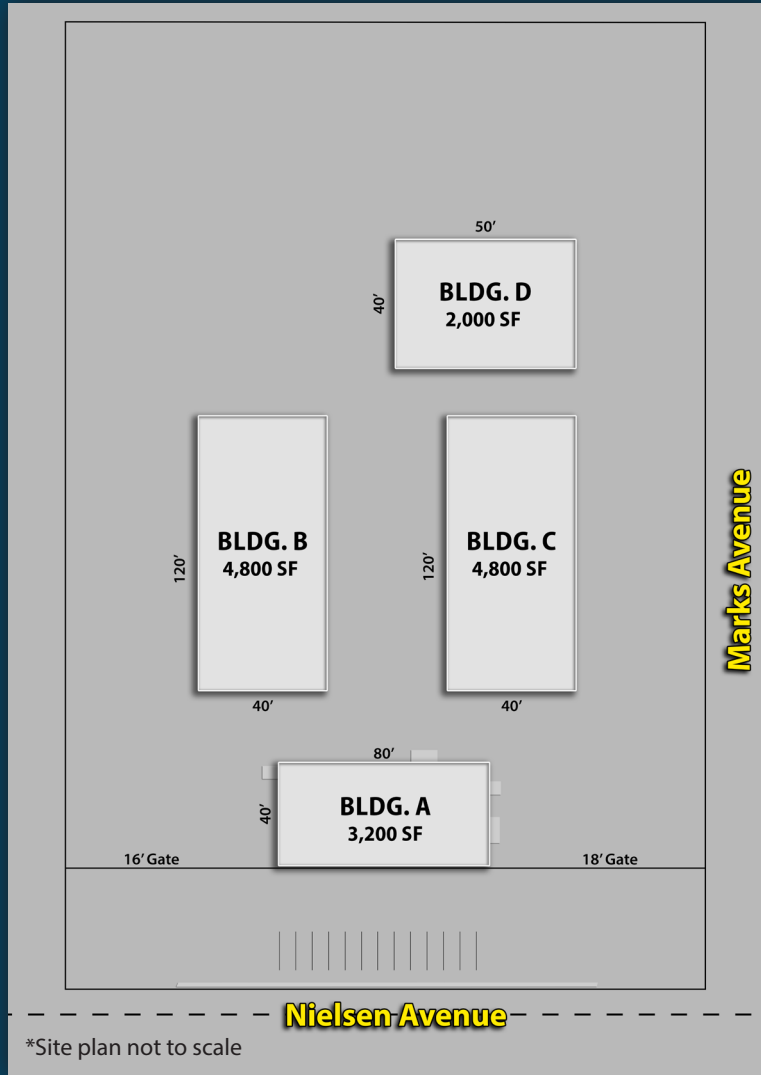

Building Size:	14,800 ± SF	Tenancy:	Single
Warehouse Space:	13,200 ± SF	Ceiling Height:	14-16'
Office Space:	1,600 ± SF	Power:	1,200 amp/480 volt 3 phase
Asking Rent:	\$18,500 (Monthly) NNN	Zoning:	IL (Light Industrial)
Operating Expenses:	NNN (\$2,163)	Gated Yard:	Yes (2.65 ± Acres)
Lot Size:	3 ± Acres		

For further information, please contact:

Cary Marsella

Direct Line: 831/461.5222

cmarsella@retailassociates.com

DRE License #01121565



COMMERCIAL RETAIL ASSOCIATES

7502 North Colonial Avenue, Suite 101 | Fresno, California 93711
www.RetailAssociates.com

All projections, opinions, assumptions or estimates are supplied for example only and may not represent current or future performance of the property. Any and all information pertaining to location, demographics and the site plan is supplied by sources believed to be reliable. We do not guarantee the accuracy of information and make no warranty or representation thereto. All information is presented here with the possibility of errors, omissions, change of price, rental or other conditions, prior sale, lease or financing, or withdrawal without notice. Commercial Retail Associates operates under the corporate Department of Real Estate License #01121565.



