

D&D INDUSTRIAL

18501 COLLIER AVENUE, LAKE ELSINORE, CA 92530

FOR LEASE

±2,894 SF INDUSTRIAL SPACE



FOR MORE INFORMATION, PLEASE CONTACT:

CAREY PASTOR | Senior Vice President
(951) 297-7434 | cpastor@cbcsocalgroup.com
CalDRE License # 01403298

KELLY ADAIR | Senior Associate
(760) 703-2668 | kadair@cbcsocalgroup.com
CalDRE License # 02212071



COLDWELL BANKER
COMMERCIAL
SC

D&D INDUSTRIAL

18501 COLLIER AVENUE, LAKE ELSINORE, CA 92530

FOR LEASE

±2,894 SF INDUSTRIAL SPACE

PROPERTY HIGHLIGHTS

- ±2,894 SF Industrial space available
- 1-12'w x 14'h roll-up door per unit
- 17' clear height
- 200 amp, 3 phase power supply per unit
- Central business location within I-15 corridor
- Retail and restaurant amenities nearby including: Lowe's The Home Depot, Costco, Target, Chili's, Starbucks



D&D INDUSTRIAL

18501 COLLIER AVENUE, LAKE ELSINORE, CA 92530

FOR LEASE

±2,894 SF INDUSTRIAL SPACE

AVAILABILITY

UNIT	UNIT SIZE	MONTHLY LEASE RATE	DESCRIPTION
A-100	±2,894 SF	\$4,196.00 Per month	Reception area, open office, 1 restroom and warehouse with 1 roll up door

SITE PLAN

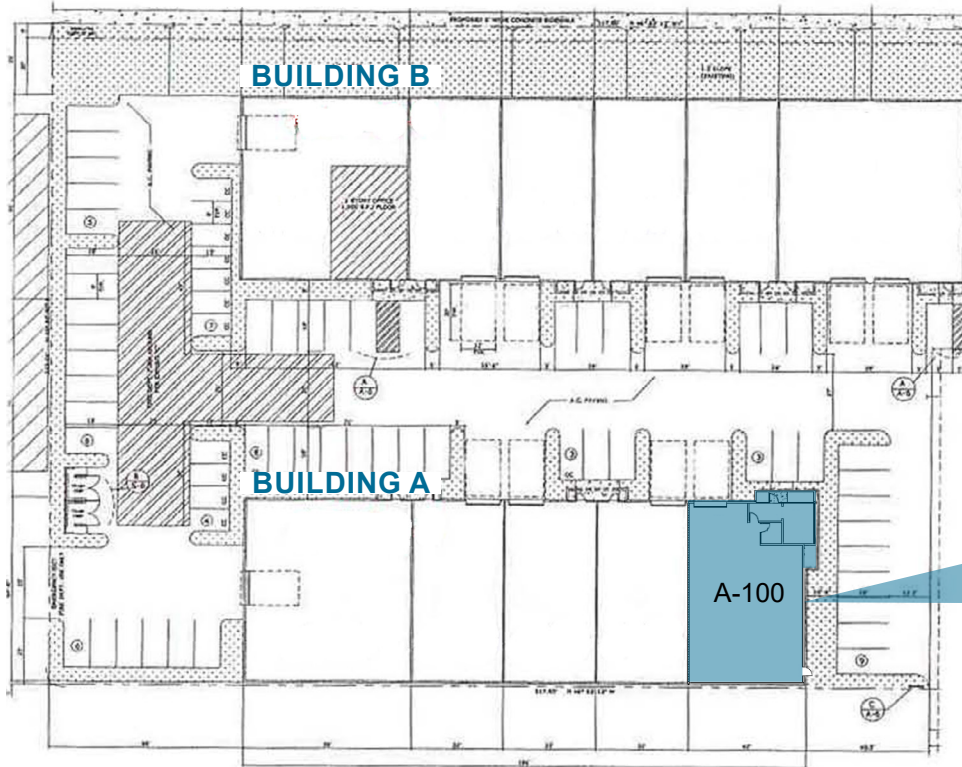

FLOOR PLAN A-100

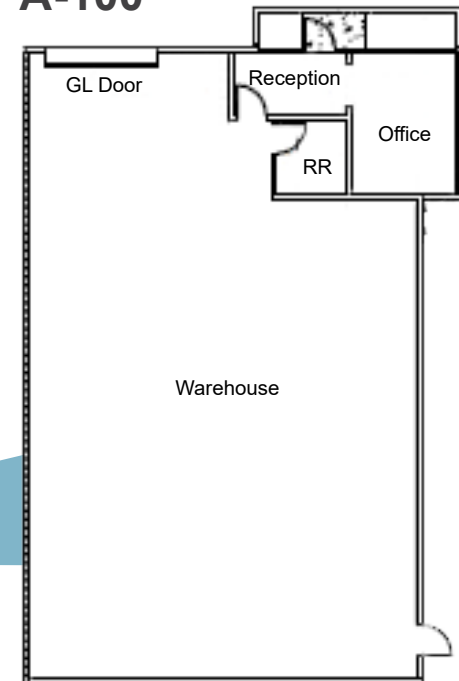

* Not to scale

D&D INDUSTRIAL

18501 COLLIER AVENUE, LAKE ELSINORE, CA 92530

FOR LEASE

±2,894 SF INDUSTRIAL SPACE

PROPERTY PHOTOS & VIDEOS

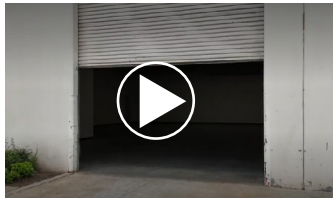

[Click Here to View Video of Warehouse](#)



[Click Here to View Video of Office](#)

D&D INDUSTRIAL

18501 COLLIER AVENUE, LAKE ELSINORE, CA 92530

FOR LEASE

±2,894 SF INDUSTRIAL SPACE



D&D INDUSTRIAL

18501 COLLIER AVENUE, LAKE ELSINORE, CA 92530

FOR LEASE

±2,894 SF INDUSTRIAL SPACE



D&D INDUSTRIAL

D&D INDUSTRIAL

18501 COLLIER AVENUE, LAKE ELSINORE, CA 92530

FOR LEASE

±2,894 SF INDUSTRIAL SPACE



FOR MORE INFORMATION, PLEASE CONTACT:

CAREY PASTOR

Senior Vice President

951.297.7434

cpastor@cbsocalgroup.com

CaIDRE # 01403298

KELLY ADAIR

Senior Associate

760.703.2668

kadair@cbsocalgroup.com

CaIDRE # 02212071

27368 Via Industria | Suite 102
Temecula | California | 92590
t 951.200.7683 | f 951.239.3147
cbsocalgroup.com



**COLDWELL BANKER
COMMERCIAL**

SC