

Office Space FOR LEASE

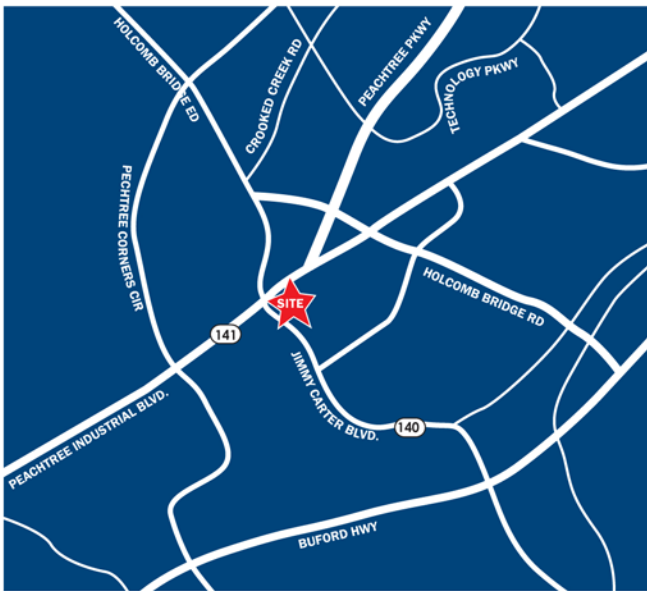

VERIDIAN BUSINESS PARK SUITES FROM 700 SF TO 7000+ SF

6825 - 6855 Jimmy Carter Blvd | Norcross, GA 30071



Property Details:

- Quality Office Space in a Variety of Sizes and Layouts
- Great Rates - Landlord Pays Electric
- Move in Ready Suites Available
- High Identity And Immediate Access Off Jimmy Carter Blvd.
- Abundant Parking
- All Suites are Ground Floor
- Floor to Ceiling Glass Windows
- On Site Maintenance
- Close to Shopping And Restaurants
- On Site Access to Bus Line
- Building Signage Available
- Racetrac and Others Will Soon be Neighbors Immediately Next Door

FOR MORE INFORMATION, PLEASE CONTACT:

Veridian Leasing Office

On-Site

Michele Miller

678-750-3940 Direct

MASTER SITE PLAN

SEEKING LARGER BUILD-TO-SUITS FROM 20,000 SF AND UP

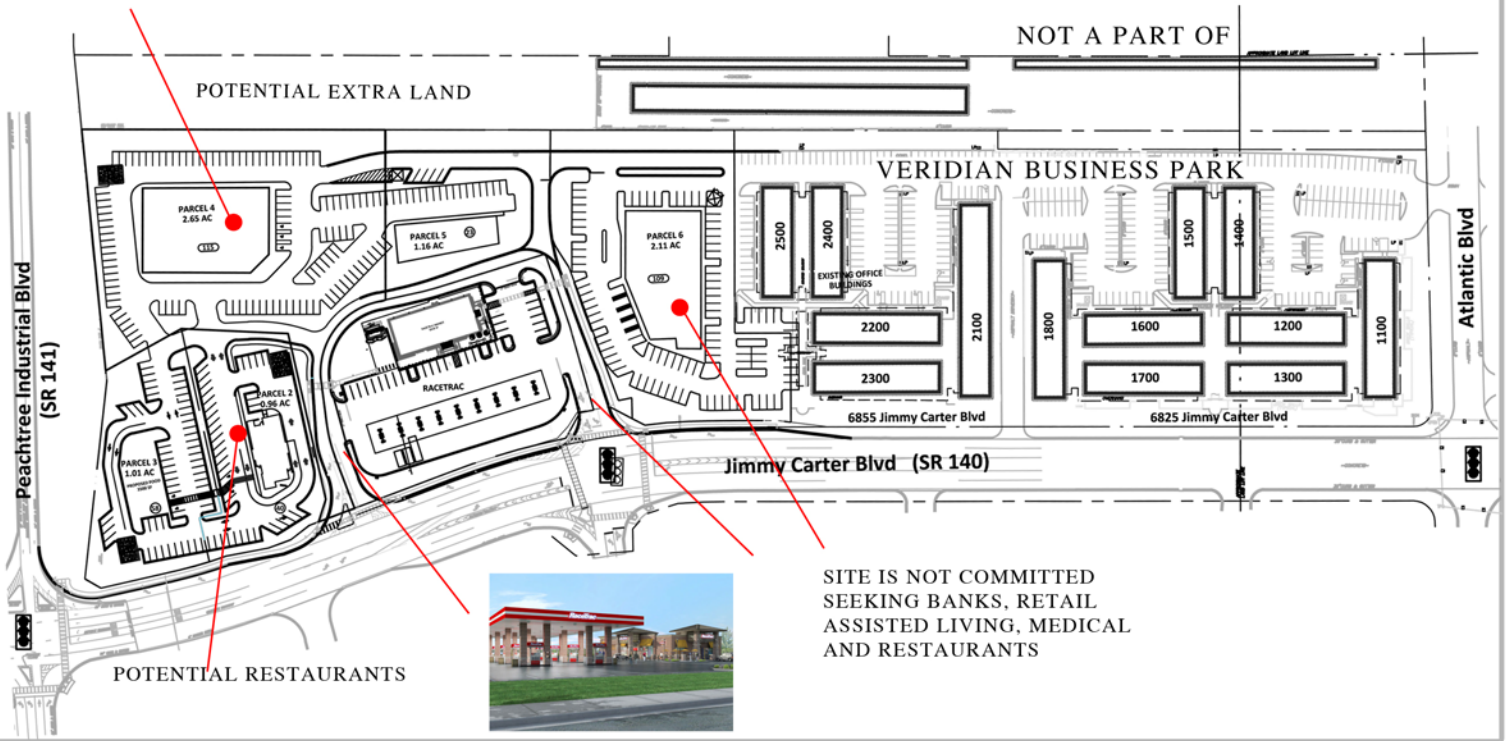

SITE IS NOT COMMITTED
SEEKING BANKS, RETAIL
ASSISTED LIVING, MEDICAL
AND RESTAURANTS

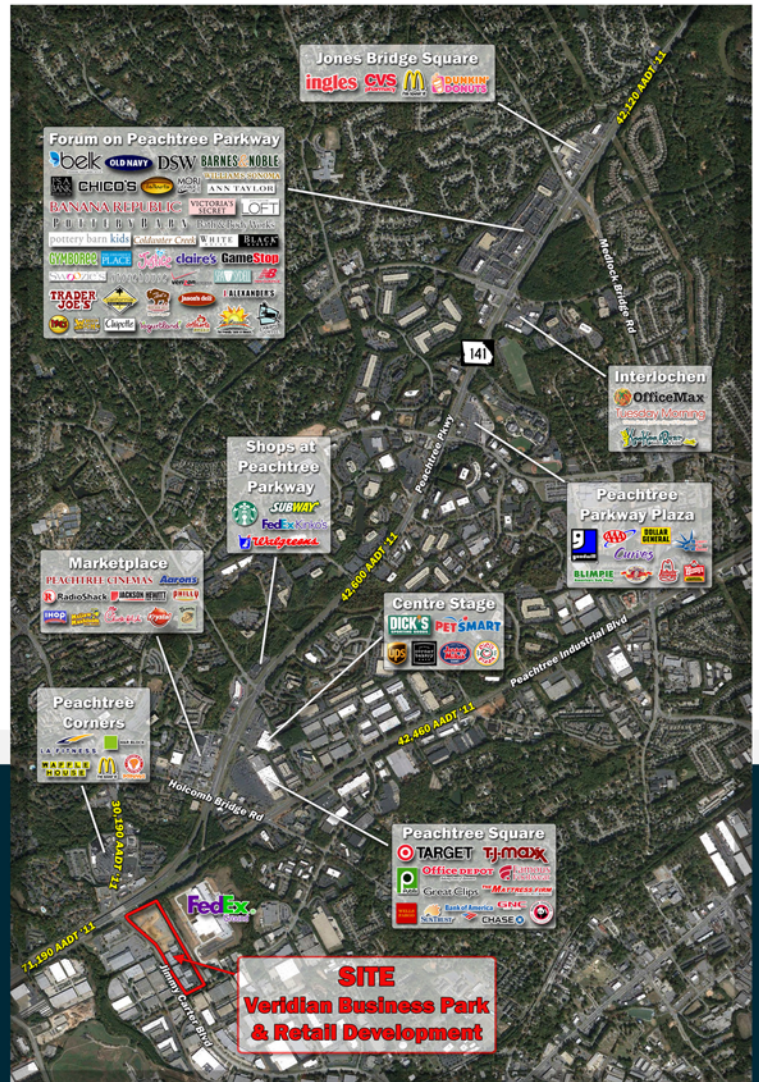

FOR MORE INFORMATION
Veridian Leasing Office
On-Site
Michele Miller
678-750-3940 Direct