



# 1001 S. GRAND AVENUE

Grand Avenue Frontage | Large Fenced Yard

EXCLUDED

S Grand Ave

FOR  
SUBLEASE

±30,000 SF INDUSTRIAL BUILDING ON ±3.49 AC

**CBRE**

1001 S. GRAND AVENUE, SANTA ANA, CA

# Property Features & Highlights

Address:	1001 S. Grand Avenue Santa Ana, CA
Size:	±30,000 SF Freestanding Industrial Building on ±3.49 AC Parcel
Office:	±3,000 SF Office
WH Clear Ht:	±16' Warehouse Clearance
GL Loading:	Four (4) Oversized Grade- Level Doors
Power:	800 Amps; Upgrade to 2,000 Amps / 480 Volt in Progress
Parking:	4.5/1,000 SF Parking Ratio
Sprinklers:	Fire Sprinkler System

- Large Fenced Yard with Potential to Expand Into Adjacent Lot (to use for parking)
- Four (4) Cranes on Site Included
- Grand Avenue Frontage
- Two Points of Ingress / Egress
- Close Proximity to the 5 & 55 Freeways
- Sublease Through July 31, 2029

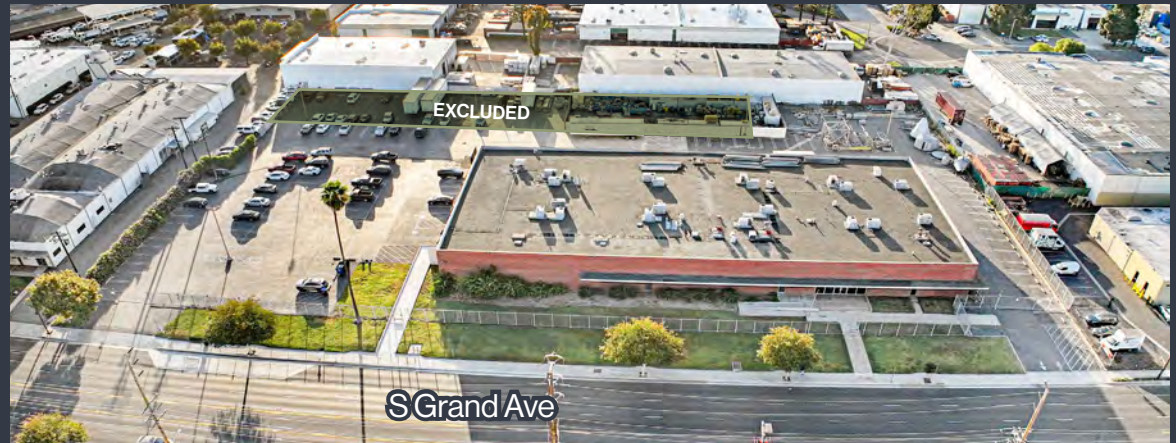

# Floor Plan

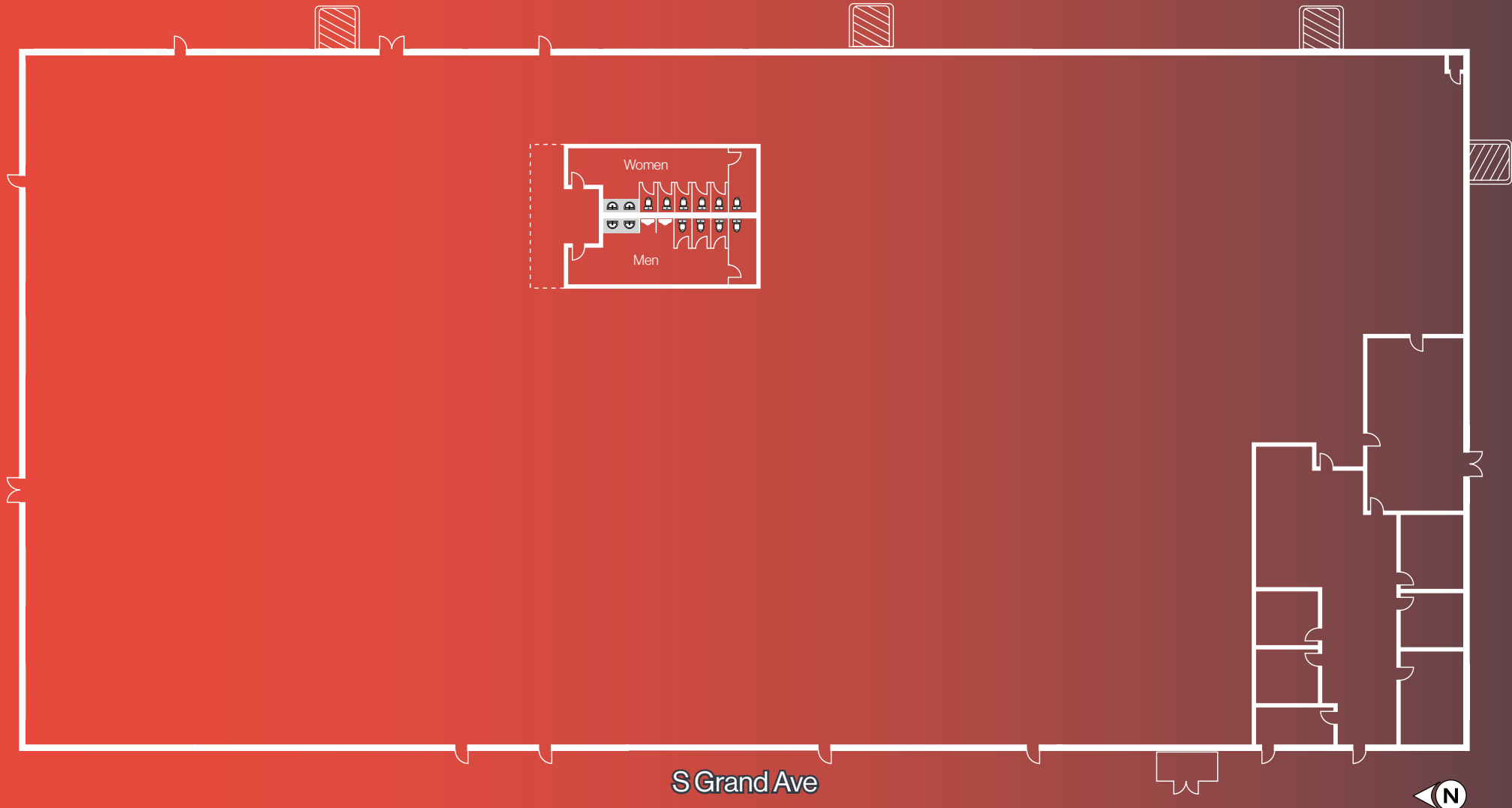

S Grand Ave



# Local Map

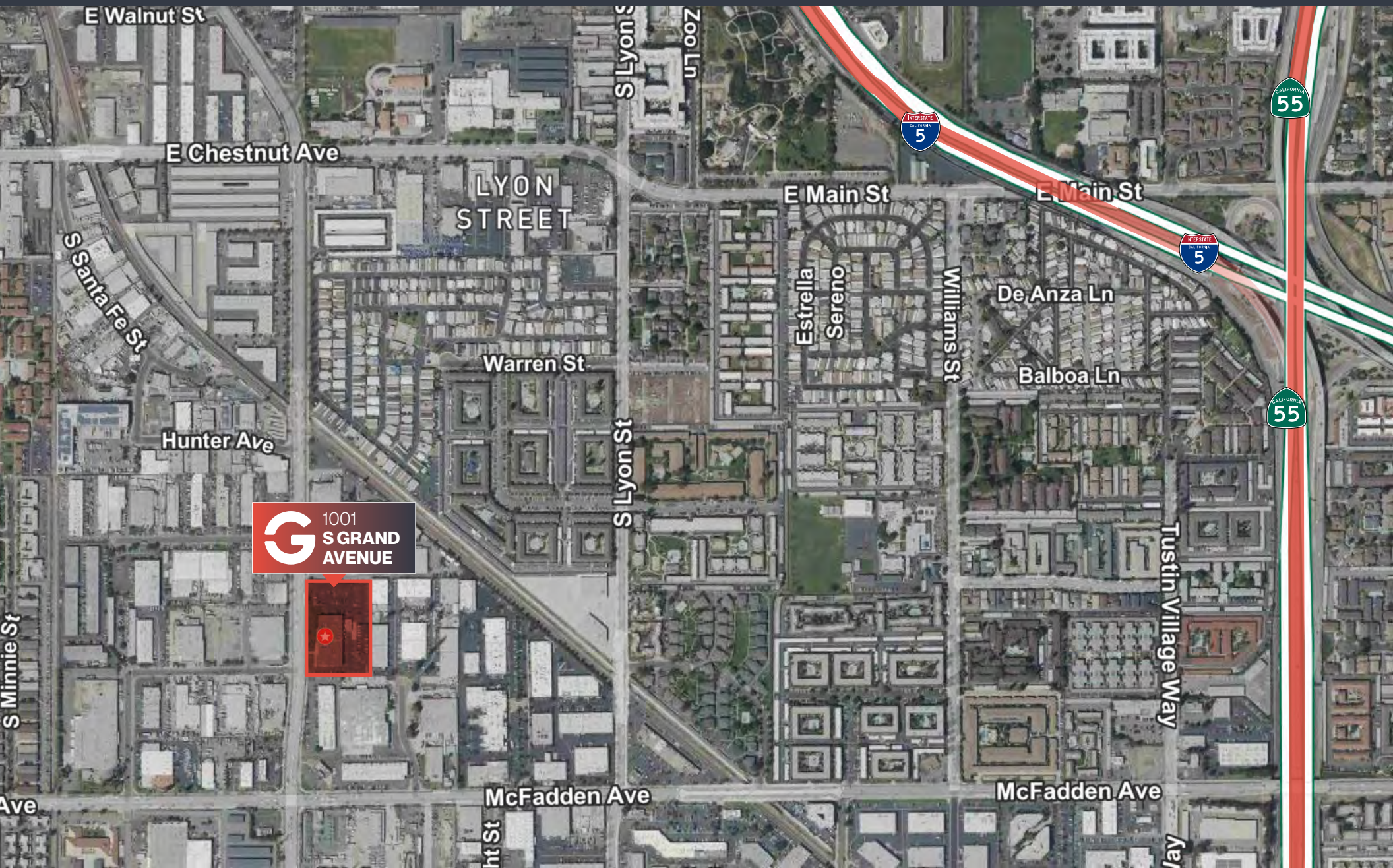

1001 S GRAND AVENUE, SANTA ANA, CA

# Regional Map

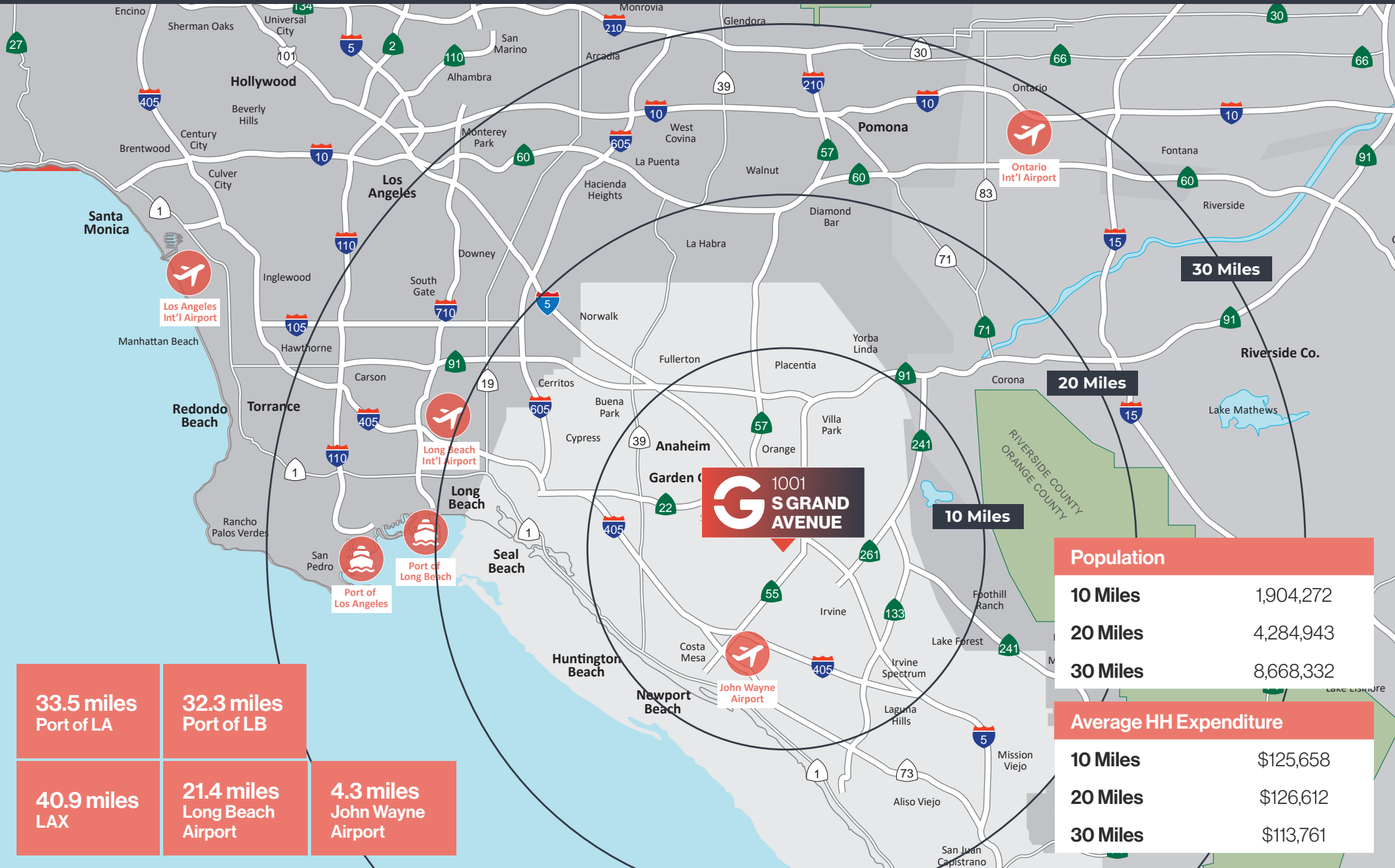

1001 S GRAND AVENUE, SANTA ANA, CA



# 1001 S S. GRAND AVENUE

SANTA ANA, CALIFORNIA

## CONTACTS

### SEAN WARD

Executive Vice President

Lic 01415499

714-371-9222

sean.ward@cbre.com

### BEN SEYBOLD

Executive Vice President

Lic 01081310

714-371-9233

ben.seybold@cbre.com

FOR  
SUBLEASE

±30,000 SF INDUSTRIAL BUILDING ON ±3.49 AC

**CBRE**

© 2026 CBRE, Inc. All rights reserved. This information has been obtained from sources believed reliable, but has not been verified for accuracy or completeness. Any projections, opinions, or estimates are subject to uncertainty. The information may not represent the current or future performance of the property. You and your advisors should conduct a careful, independent investigation of the property and verify all information. Any reliance on this information is solely at your own risk. CBRE and the CBRE logo are service marks of CBRE, Inc. and/or its affiliated or related companies in the United States and other countries. All other marks displayed on this document are the property of their respective owners.