

LOVETT

INDUSTRIAL

24,750 SF

FOR LEASE | CLASS A
PRIME CORNER SPACE

CLAYMOORE

BUSINESS PARK

CLAYMOORE

BUSINESS PARK

24,750 SF WITH 3,020 SF OF OFFICE
3900 CLAYMOORE RD | SUITE 130 | HOUSTON, TX 77043

THE GALLERIA

MEMORIAL CITY



KATY FREEWAY



W. SAM HOUSTON PKWY N.

3900 CLAYMOORE RD
SUITE 130
24,750 SF AVAILABLE

3700 CLAYMOORE PARK DR

10801 MOSS RIDGE RD

3550 BRITTMOORE RD

KEMPWOOD



11555 CLAY RD

3600 BRITTMOORE RD

11711 CLAY RD

3800 BRITTMOORE PARK DR

CLAYMOORE PARKWAY DR

CLAY ROAD

BRITTMOORE ROAD

AERIAL MAP

- Master-planned park with excellent accessibility
- Strategically located on Brittmoore Rd. just off Clay Rd. and Beltway 8
- Outstanding corporate identity
- Irreplaceable infill location

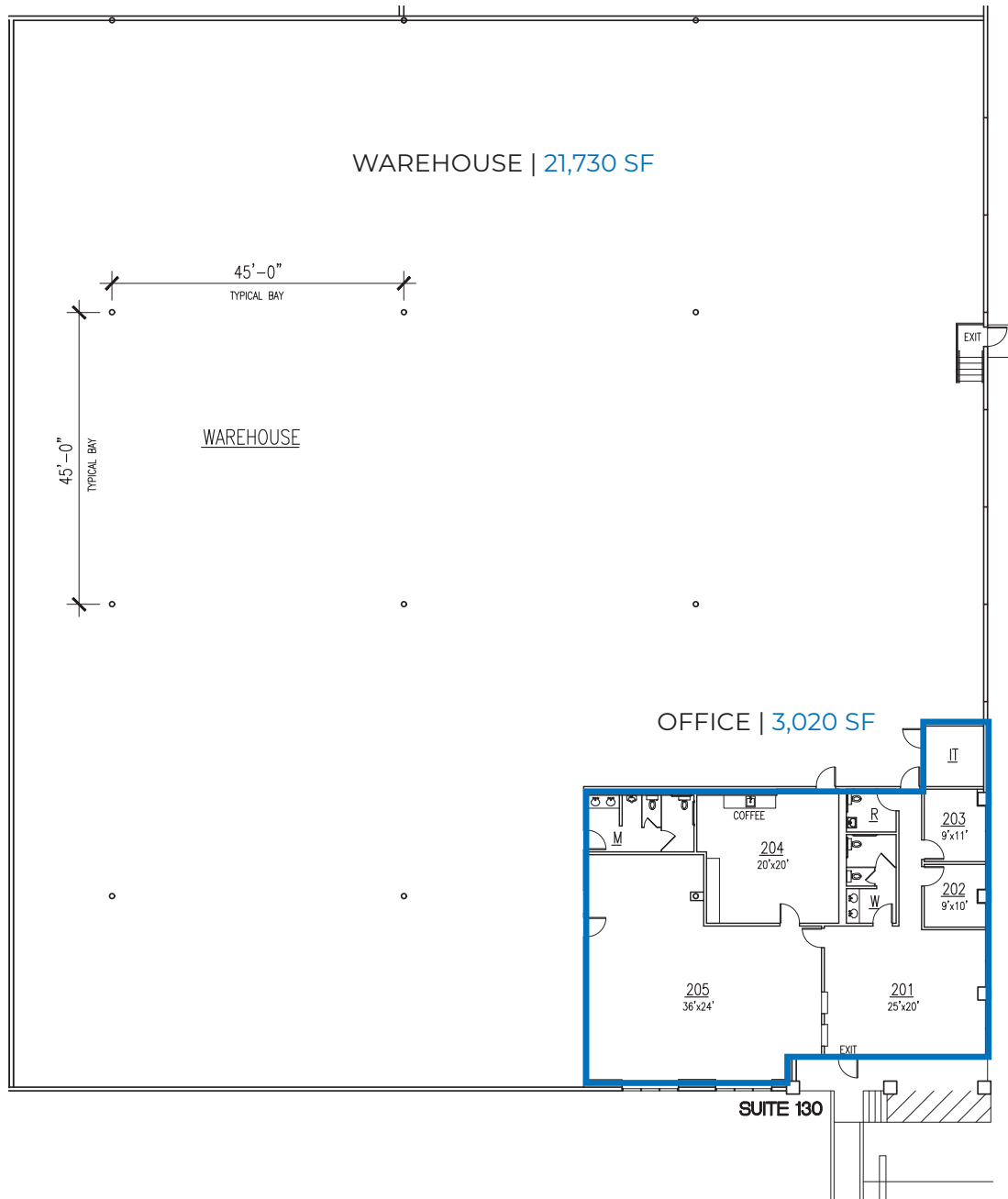

LOVETT

INDUSTRIAL

FLOOR PLAN

SPACE FEATURES:

- 24,750 SF Total
- 3,020 SF Office
- 21,730 SF Warehouse
- Corner suite
- Front-load / Dock-high
- 24' Clear height
- Four (4) dock-high doors
- Two (2) drive-in ramps
- Fully sprinklered
- All concrete paving

LOCAL AMENITIES

RESTAURANTS

- 1 Pappas BBQ
- 2 Pappadeaux Seafood
- 3 James Coney Island
- 4 Rudy's Bar-BQ
- 5 Taco Cabana
- 6 McDonald's
- 7 Starbucks
- 8 Chick-Fil-A
- 9 Niko Niko'shen
- 10 Kirby Ice House

HOTELS

- 11 Residence Inn by Marriott
- 12 Four Points by Sheraton
- 13 Comfort Suites
- 14 Staybridge Suites
- 15 The Westin Houston

SERVICES/RETAIL

- 16 Clay Road YMCA
- 17 Memorial City Mall
- 18 Life Time Fitness
- 19 CITYCENTRE
- 20 Town & Country Village
- 21 FedEx

CLAYMOORE
BUSINESS PARK



LOVETT

INDUSTRIAL



 **Transwestern**
LEASING INFORMATION:

Darryl Noon
P: 713.270.3325
E: Darryl.Noon@transwestern.com

Jude Filippone
P: 713.270.3318
E: Jude.Filippone@transwestern.com

Brian Gammill
P: 713.270.3321
E: Brian.Gammill@transwestern.com