

29 N Wacker Drive Chicago, IL

14,305 - 28,610 SF CONTIGUOUS BLOCK AVAILABLE



[CLICK FOR FLOORPLANS](#)

[CLICK FOR FLYER](#)

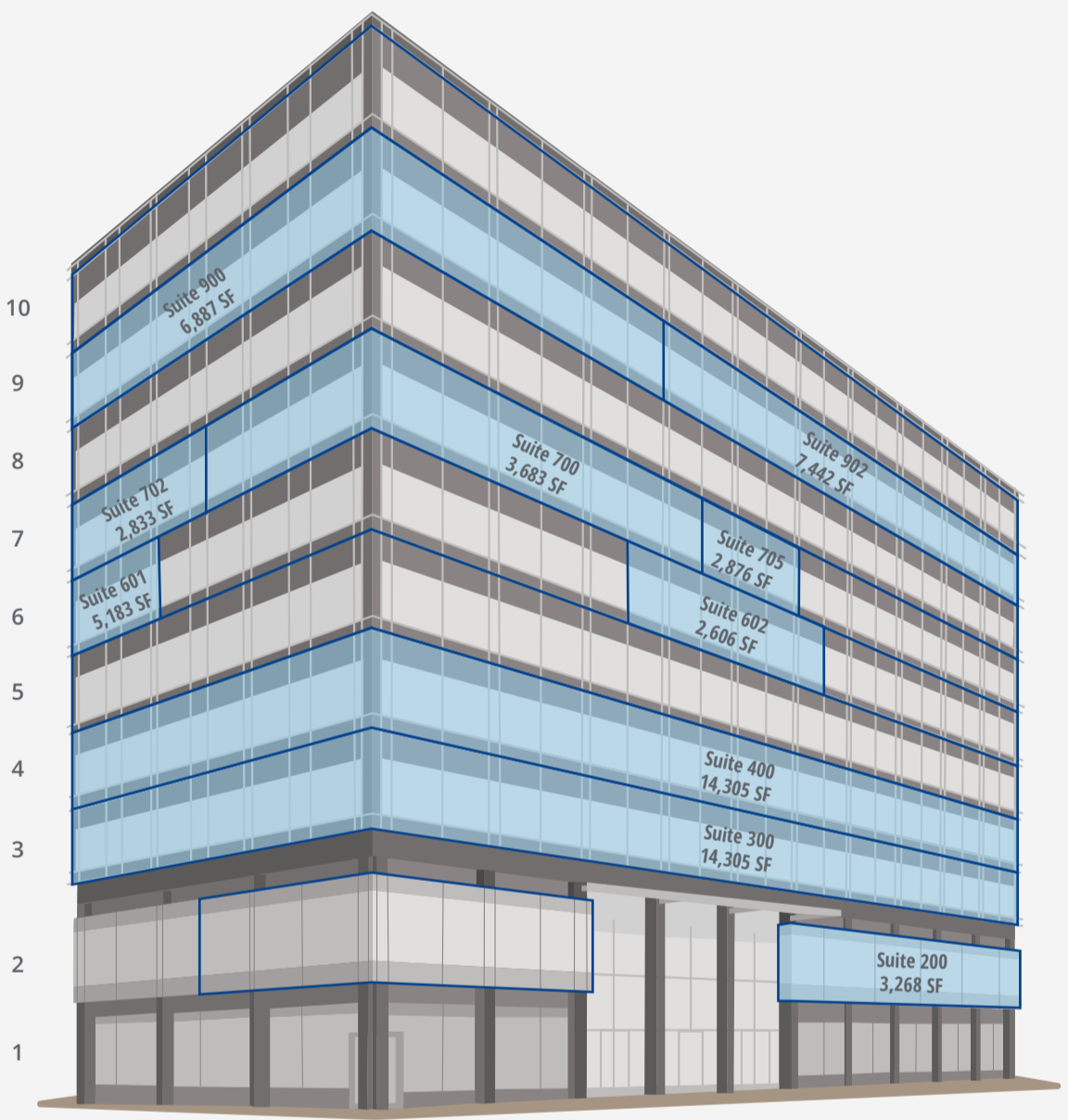

Ideal Location

Desireable Wacker Drive address located steps away from many popular dining options, hotels and transportation. 29 North Wacker is situated one block from Ogilvie Transportation Center and four blocks from Union Station ensuring ease of access for commuters. Additionally it is in close proximity to the CTA Brown, Purple and Orange Lines.

