

**FLOOR PLAN LEGEND**

- (A) DOOR MARKER
- WALL TAG
- ELEVATION MARKER

**FLOOR PLAN NOTES**

1. USE 5/8" TYPE "X" GYP. BOARD AT ALL WALLS.
2. VERIFY AND INSTALL 2X FIRE RETARDANT WOOD BLOCKING AS REQUIRED FOR MOUNTING OF ALL EQUIPMENT AND ACCESSORIES.
3. PUBLIC USE AREAS SHALL COMPLY WITH ADA/TAS (AMERICANS WITH DISABILITIES ACT AND TEXAS ACCESSIBILITY STANDARDS)
  - 6.1.2 USE COMMERCIAL GRADE HARDWARE WITH LEVER TYPE HANDLE 3'-0" A.F.F.
  - 3.1.3. DOOR OPENING FORCE SHALL NOT EXCEED 5 POUNDS.
  - 3.1.4 THRESHOLD SHALL NOT EXCEED 1/2".
  - 6.1.5 DOOR SIGNAGE SHALL COMPLY WITH ADA/TAS SECTION 703.
  - 3.1.6. MINIMUM DOOR HEIGHT SHALL BE 6'-8".
4. A READILY VISIBLE DURABLE SIGN IS REQUIRED AT THE EGRESS SIDE OF THE MAIN EXTERIOR DOOR POSTED ON OR ADJACENT TO THE DOOR STATING THIS DOOR TO REMAIN UNLOCKED WHEN BUILDING IS OCCUPIED. THE SIGN SHALL BE IN LETTERS 1 INCH (25MM) HIGH ON A CONTRASTING BACKGROUND
5. ALL GLAZING IN SHALL COMPLY WITH I.B.C. SECTION NO 2406.
6. INSULATION IN BUILDING SHALL HAVE A FLAME SPREAD NOT MORE THAN 25 AND SMOKE DEVELOPMENT RATING NOT MORE THAN 450.
7. GENERAL CONTRACTOR SHALL OBTAIN FROM THE LANDLORD THE TENANT CONSTRUCTION GUIDELINES. THESE GUIDELINES SHALL BE STRUCTURALLY ADHERED TO FOR ALL PHASES OF CONSTRUCTION.

**WALL TYPES**

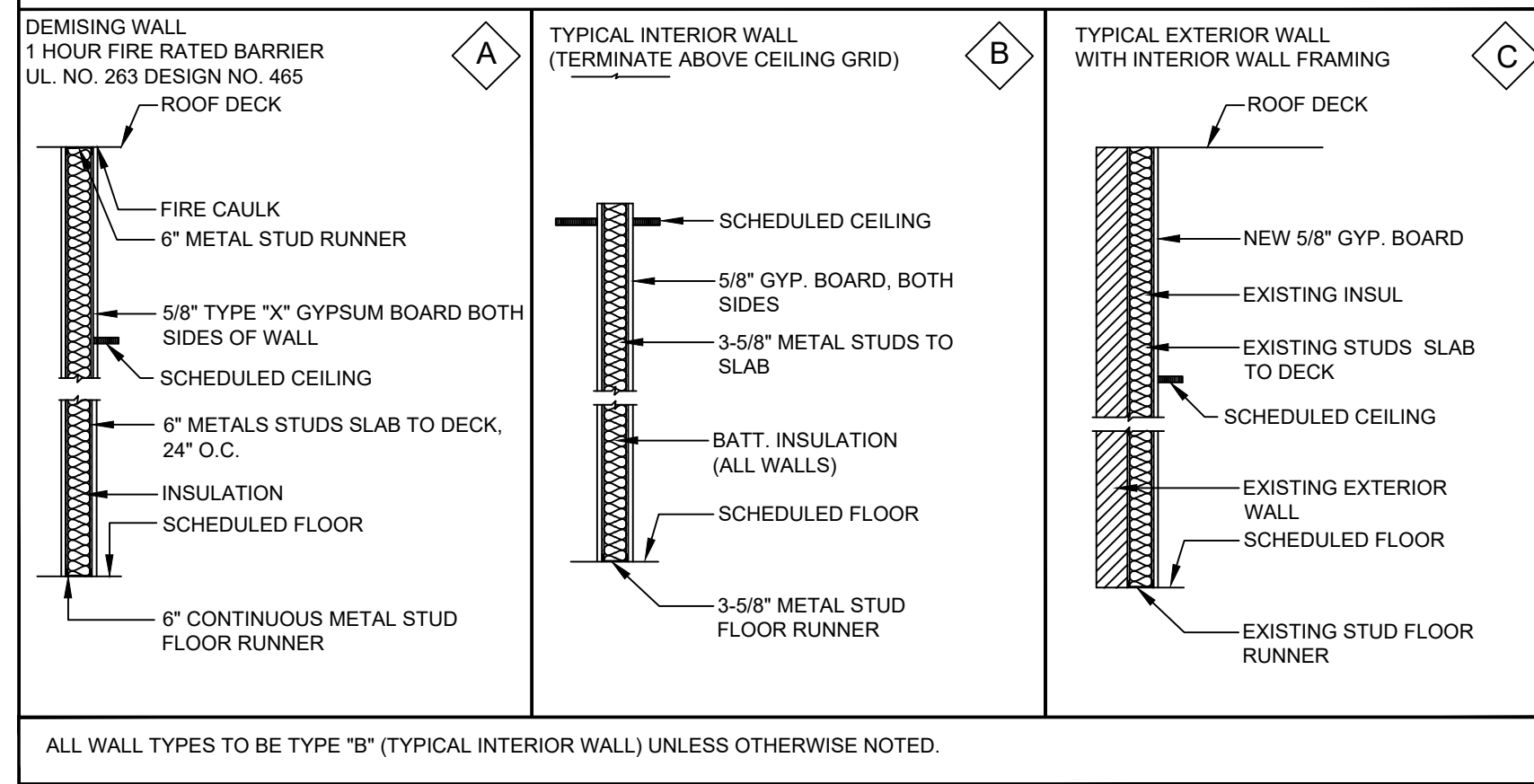

**DOOR SCHEDULE**

MARK	SIZE	MFR.	DOOR	FRAME	NOTES
(A)	3070	T.B.D.	GLASS	METAL STOREFRONT TYPE	TEMPERED GLASS, SEE NOTE 1 & 2
(B)	3070	REDIFRAME	WOOD	METAL	STAIN GRADE, SOLID CORE
(C)	3070	REDIFRAME	WOOD	METAL	STAIN GRADE, SOLID CORE, FULL LIGHT, TEMPERED GLASS
(D)	3070	-	WOOD	METAL	SLIDING BARN DOOR

NOTE 1 - EGRESS DOORS SHALL BE READILY OPEN FROM THE EGRESS SIDE WITHOUT THE USE OF A KEY OR SPECIAL KNOWLEDGE OR EFFORT.  
NOTE 2 - EGRESS DOOR LOCKS AND LATCHES SHALL COMPLY WITH CURRENT INTERNATIONAL BLD. CODE, SECTION 1008.1.8.3

**FLOORING SCHEDULE**

ROOM NAME	FLOORING	BASE	NOTES
RESTROOM	TILE	TILE	-
ALL OTHER AREAS	LVT	RUBBER	-

- PAINT NOTES:**
1. SMOOTH TEXTURE TO BE USED THROUGHOUT.
  2. SQUARE CORNER BEAD TO BE INSTALLED ON CORNER JOINTS OF ALL WALLS.

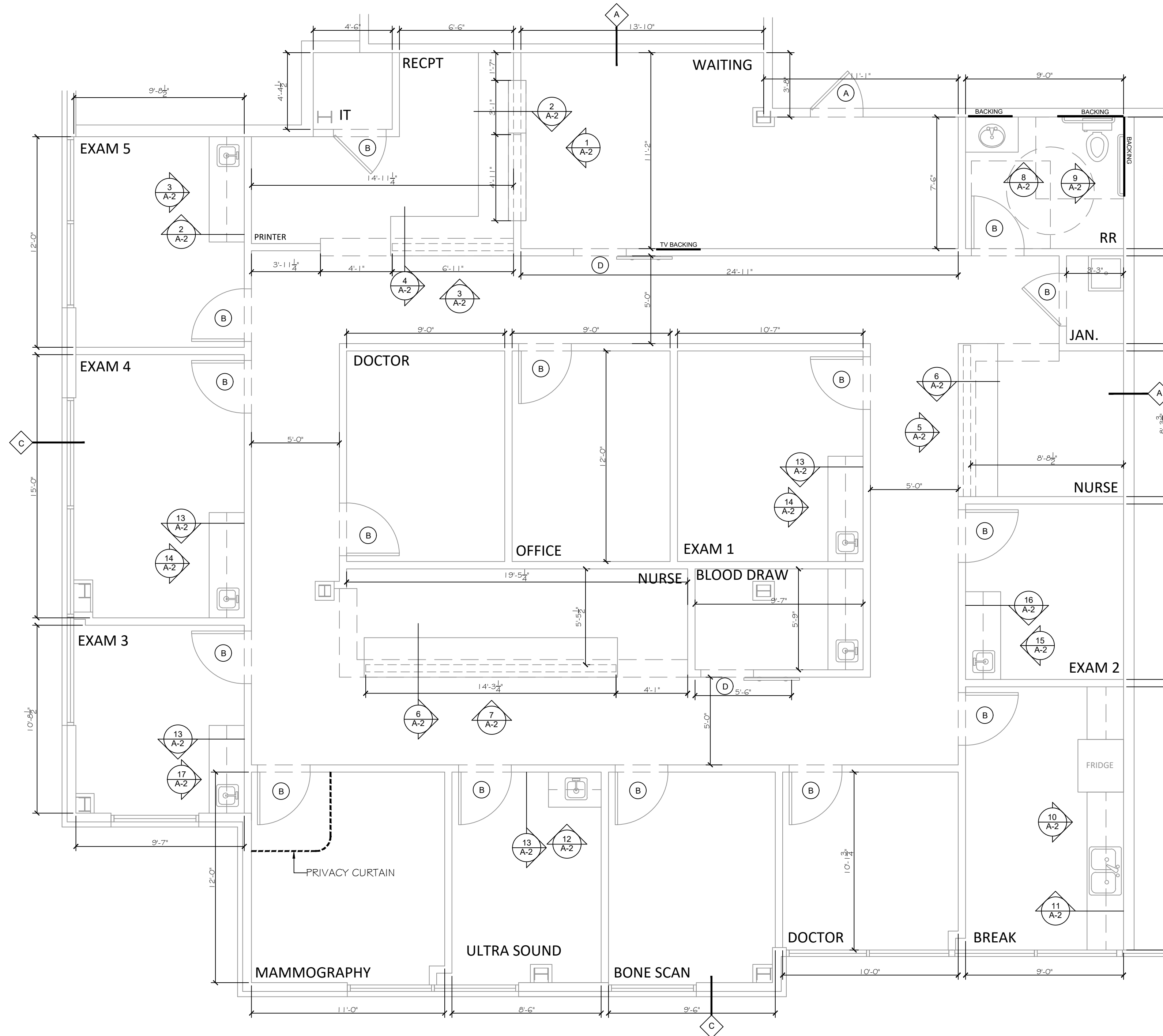

**FLOOR PLAN**  
1/4"=1'-0"

**GENESIS CARE**  
**129 N. COLLINS RD.**  
**SUNNYVALE, TX**



**2 ESSEX COURT**  
**HEATH, TX 75032**

REVISION NO.	DATE	DESCRIPTION
△ 1	04.27.2021	SUBMITTAL SET

SHEET TITLE:  
**FLOOR PLAN**

**A-1**

SHEET NUMBER: