

# Apple Tree Plaza

13622 NE 20th Street Bellevue, WA 98005



FOR LEASE

Storefront Retail Space for Lease

**Josh Heyum**  
Principle  
425.445.5799  
josh@vistapacificgroupinc.com

**Jake Staniszewski**  
Broker  
425.284.4270 ext. 1009  
jake@vistapacificgroupinc.com



# Apple Tree Plaza

13622 NE 20th Street Bellevue, WA 98005

## Building Features

- Former Medical Spa
- Efficient Floorplan
- Exclusive Storefront
- Private Signage
- Ample Parking

Suite	SF	Rate	Type
13622 - A1	726 RSF	\$30/SF/Yr, NNN	Retail

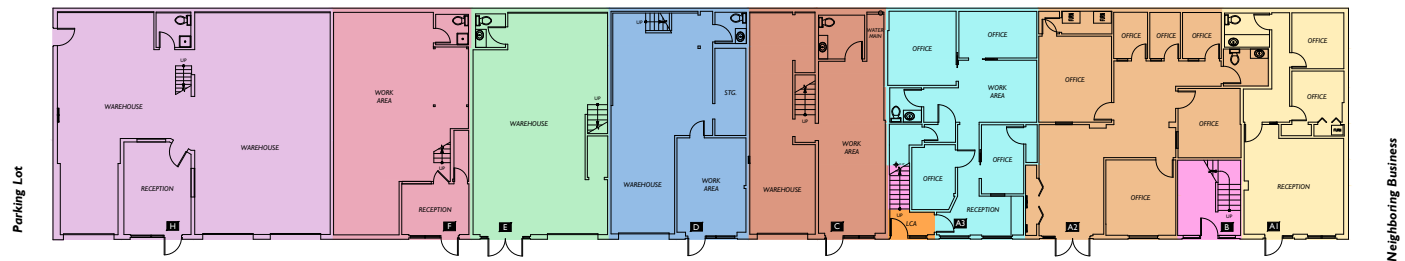

Josh Heyum

Principle

425.445.5799

Jake Staniszewski

Broker

425.284.4270 ext. 1009

jake@vistapacificgroupinc.com

	Office Area			Warehouse Area			Mezzanine Area			Total Suite Area		
	Suite #	Occupant Area	Occupant w/LCA	Suite #	Occupant Area	Occupant w/LCA	Suite #	Occupant Area	Occupant w/LCA	Suite #	Total Occupant Area	Total Occupant w/LCA
<b>Floor 1 Summary</b>		<b>SQ. FT.</b>										
Total Occupant Area		8,941.76										
Limited Common Area		41.85										
Building Service Area		0										
Total Vertical		0										
	Suite A1	725.76	--	Suite A1	0	--	Suite A1	0	--	Suite A1	725.76	--
	Suite A2	1,297.25	--	Suite A2	0	--	Suite A2	0	--	Suite A2	1,297.25	--
	Suite A3	942.95	951.35*	Suite A3	0	--	Suite A3	0	--	Suite A3	942.95	951.35*
	Suite B	188.37	190.05*	Suite B	0	--	Suite B	3,568.60	3,600.38*	Suite B	3,756.97	3,790.43*
	Suite C	484.96	--	Suite C	477.51	--	Suite C	1,005.67	--	Suite C	1,968.14	--
	Suite D	221.56	--	Suite D	738.20	--	Suite D	663.01	--	Suite D	1,622.77	--
	Suite E	0	--	Suite E	958.12	--	Suite E	627.05	--	Suite E	1,585.17	--
	Suite F	149.71	--	Suite F	814.51	--	Suite F	413.55	--	Suite F	1,377.77	--
	Suite H	208.26	--	Suite H	1,724.53	--	Suite H	465.34	--	Suite H	2,398.13	--

Area Analysis performed in accordance with ANSI/BOMA Z65.2 - 2012 Method A Standard.  
\*Area includes a proportional share of Limited Common Area (LCA = 41.85 SF).

Parking Lot  
Neighboring Business

