

# 3211-3213 AVENUE E

3211-3213 Avenue E | East Arlington, Texas 76011



## 6,392-12,942 SF FOR LEASE

### PROPERTY HIGHLIGHTS

- 6,392-12,942 SF for lease
- 924-2,280 SF office
- 16' clear height
- One (1) dock high door
- One (1) ramped door
- Heavy power
- Easy access to major thoroughfares
- Partially HVAC'd warehouse



Canon Shoultz  
972.280.8328  
cshoultz@holtlunsford.com

Maddy Coffman  
972.280.8325  
mcoffman@holtlunsford.com

### CONTACT

Walker Floyd  
972.265.0141  
wfloyd@holtlunsford.com

# 3211-3213 AVENUE E

3211-3213 Avenue E | East Arlington, Texas 76011

FLOOR PLANS

6,392-12,942 SF FOR LEASE

- ### SUITE 3211
- 6,550 SF available
  - 5,626 SF warehouse
  - 924 SF office
  - One (1) dock high door
  - 16' clear height
  - Heavy power

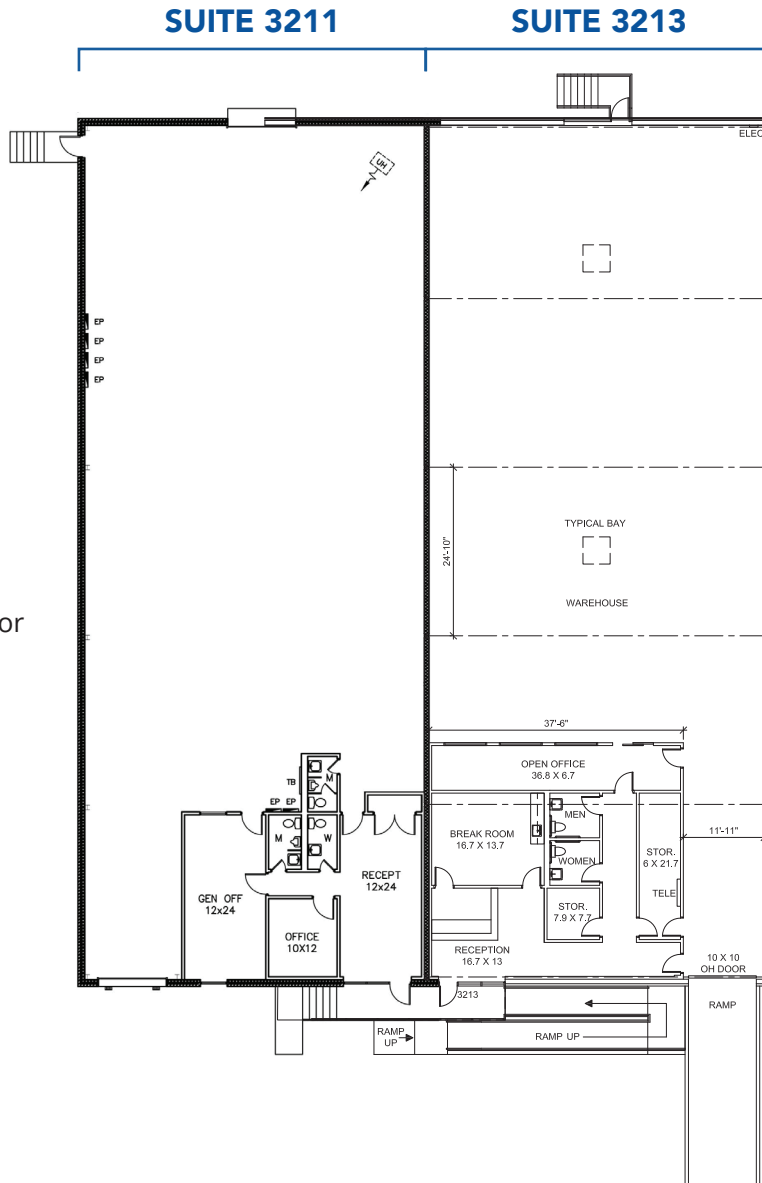

- ### SUITE 3213
- 6,392 SF available
  - 5,036 SF warehouse
  - 1,356 SF office
  - One (1) ramped door
  - 16' clear height
  - 100% HVAC



Canon Shoults  
972.280.8328  
cshoults@holtlunsford.com

Maddy Coffman  
972.280.8325  
mcoffman@holtlunsford.com

**CONTACT**  
Walker Floyd  
972.265.0141  
wfloyd@holtlunsford.com

