

FOR LEASE

2725 LOW COURT, FAIRFIELD, CALIFORNIA

# Fairfield Industrial Center

±205,233 SQUARE FEET AVAILABLE (DIVISIBLE)  
ON ±11.26 ACRE SITE

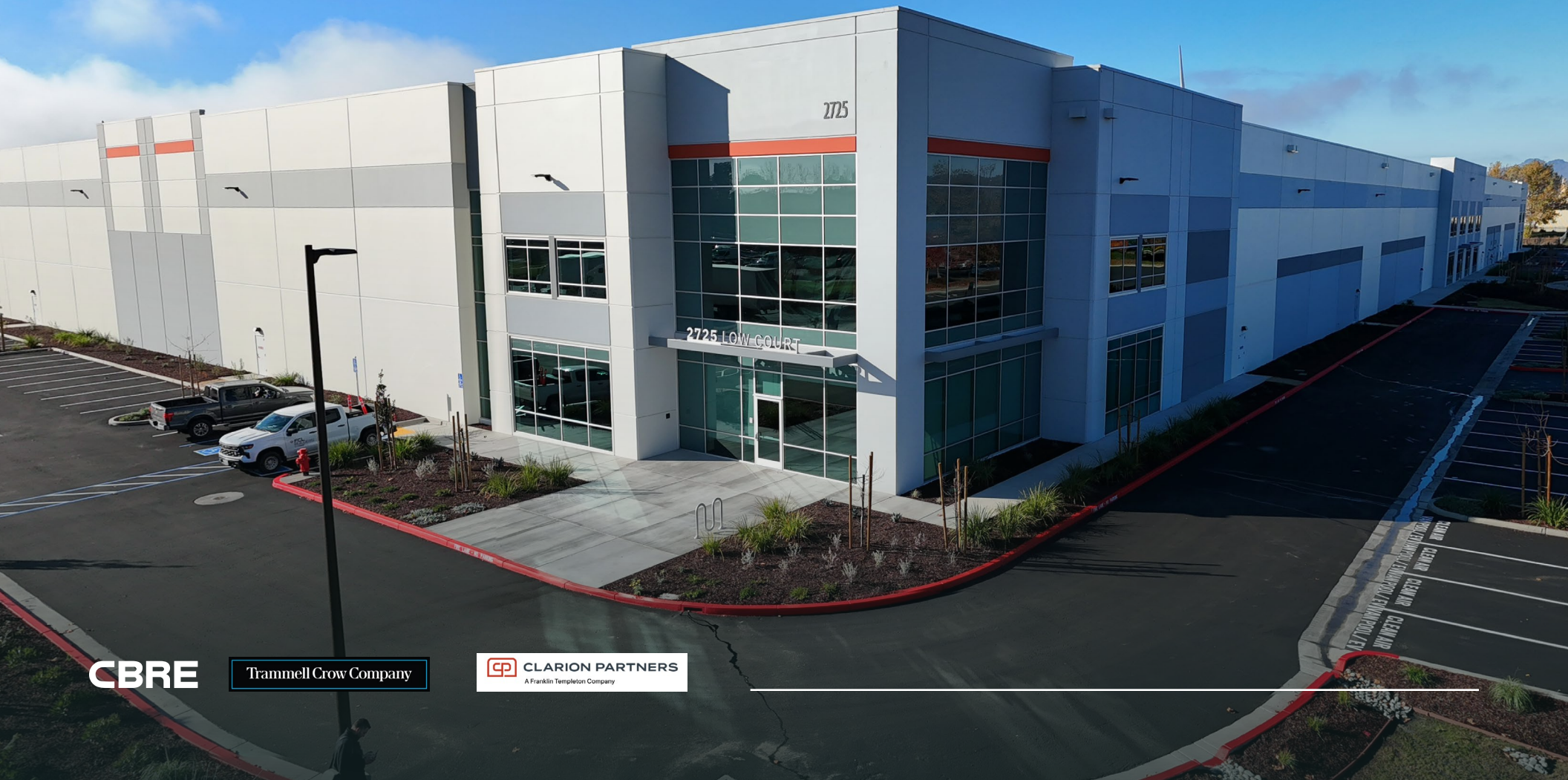

**CBRE**

Trammell Crow Company



**CLARION PARTNERS**

A Franklin Templeton Company



# Building Highlights

- ±205,223 Square Feet (Divisible) on ±11.26 acre site
- Building Dimensions: 778.5 (w) X 250' (d)
- ±11.05 Acres
- ±3,828 Square Foot Office
- 36' Minimum Clear Height
- ESFR Sprinklers
- 32 Dock Doors (9' X 10') Rear
- 16 Dock Levelers with Dock Seals (40,000 lb Mechanical Pits)
- 2 Grade Level Doors (12' X 14')
- 156 Auto Parking Stalls
- 45 Trailer Parking Stalls
- 185' Truck Court, 130' Staging, 55' Trailer Stalls
- 60' Speed Bay
- 7" Reinforced Slab
- 56'(w) x 47.5'(d) Column Spacing
- 2,500 Amps, 277/480 Volts
- LED Warehouse Lights (25' Candles)
- 100% Concrete Yard & Truck Court
- LEED Certified

# Site Plan

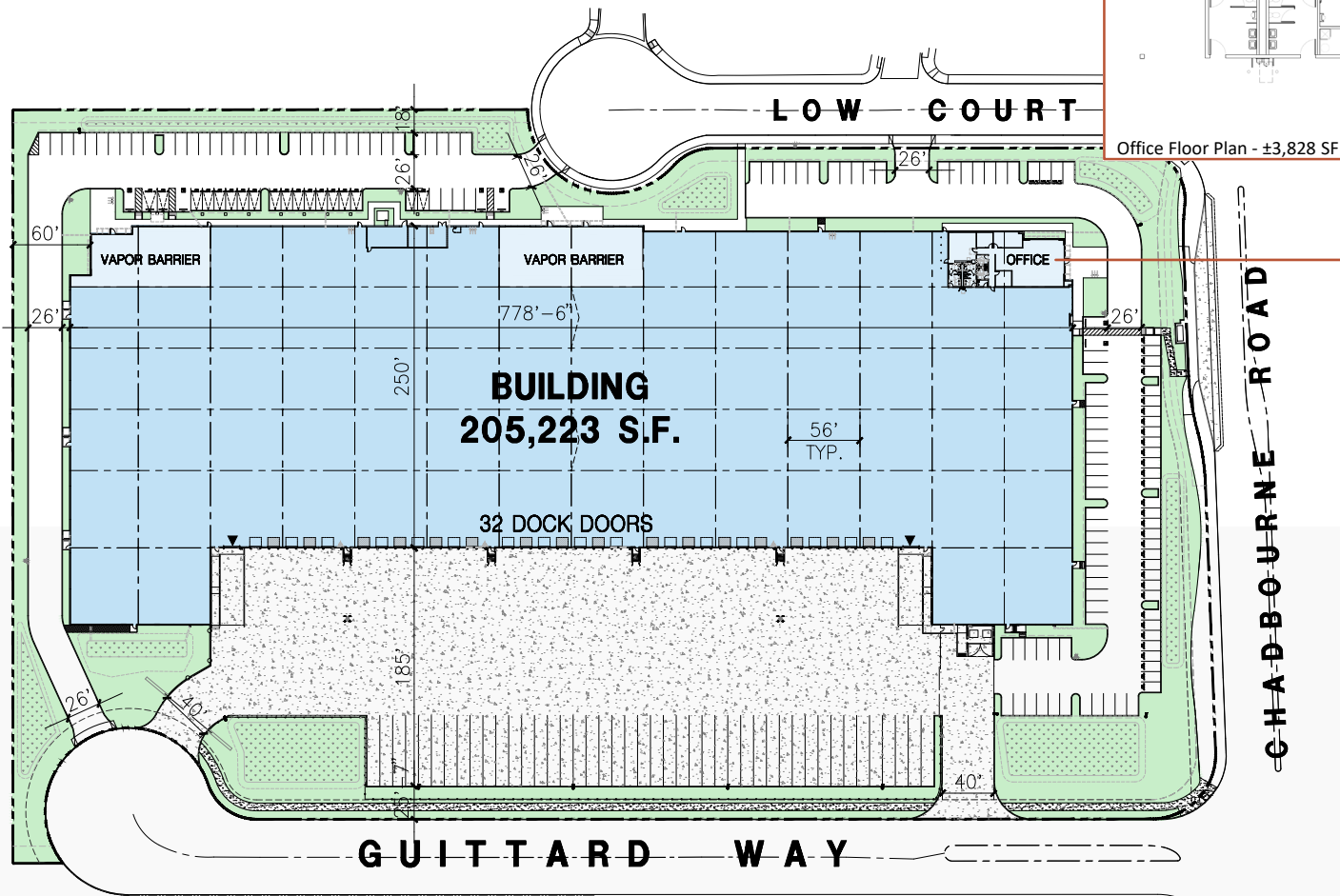

BUILDING SPECS	
WIDTH	±778.5'
DEPTH	±250'
WING BAY DEPTH	±60'

SPEED BAY	±60'
STAGING	±130'
TRAILER PARKING	±55'
COLUMN SPACING	±56'W - ±47.5'D

# Regional Map

Fairfield Industrial Center is located between San Francisco and Sacramento, with easy access to HWY-12 and I-80, making it well suited for both local and regional distribution.

## DRIVE DISTANCES TO CALIFORNIA CITIES

NAPA	±18 MILES - ±25 MINS
OAKLAND	±41 MILES - ±45 MINS
SACRAMENTO	±45 MILES - ±45 MINS
SAN FRANCISCO	±46 MILES - ±55 MINS
SAN JOSE	±78 MILES - ±85 MINS
RENO	±175 MILES - ±189 MINS

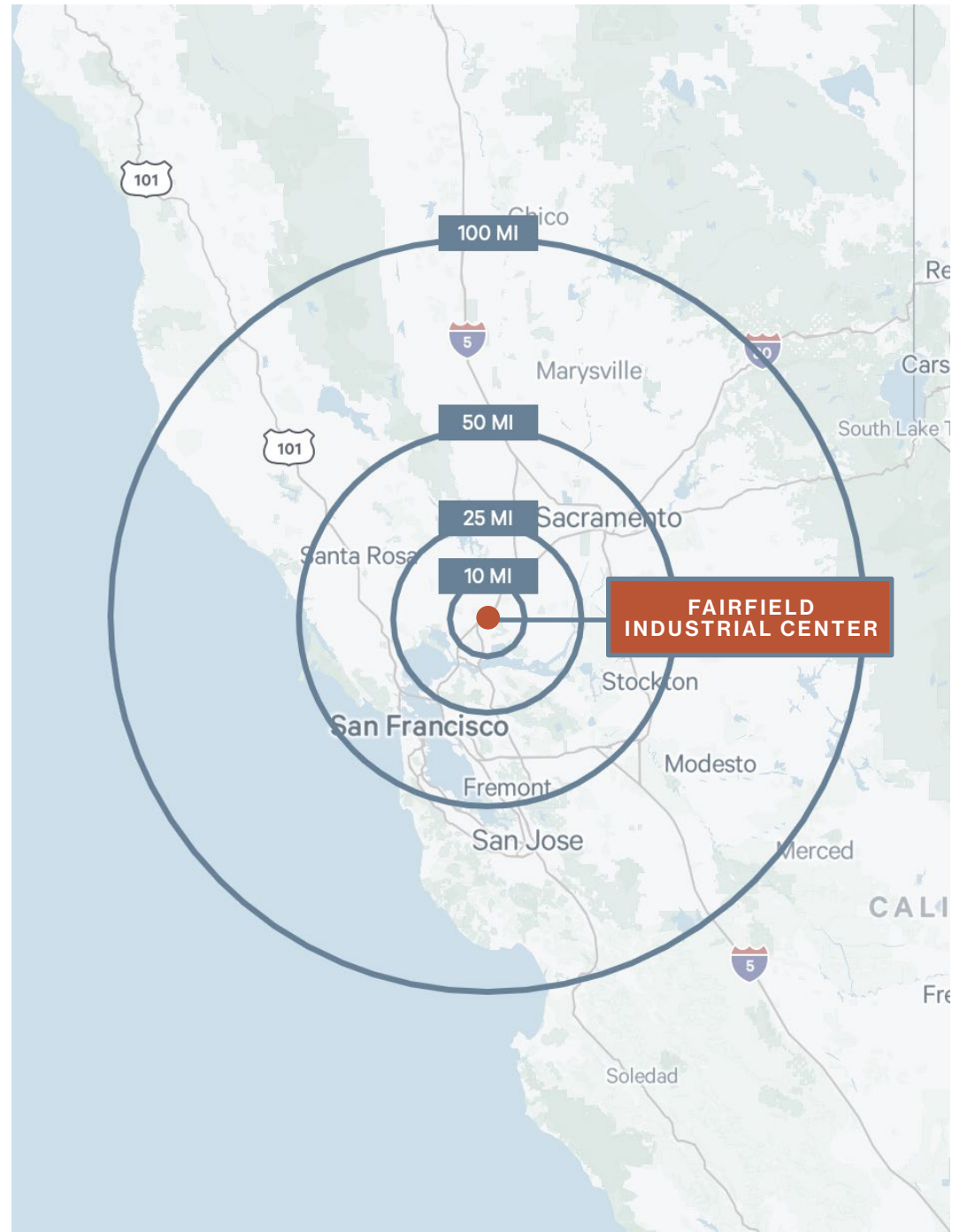

# Demographics

WITHIN A 25 MILES RADIUS OF PROPERTY

## Key Statistics

---

1,367,075  
Total Population



341,036  
Millennial Population



92,963  
Average Disposable  
Income



471,864  
Employees



246,256  
College Graduates



## Employment

---

48,403  
Manufacturing Employees



34,848  
Transportation &  
Warehouse Employees



60,715  
Professional, Scientific &  
Tech Services Employees



# Corporate Neighbors







2725 LOW COURT,  
FAIRFIELD, CALIFORNIA

# Fairfield Industrial Center

±205,233  
SQUARE FEET  
AVAILABLE  
(DIVISIBLE)  
ON ±11.26 ACRE SITE

**Brooks Pedder, SIOR**

+1925 296 7729

Brooks.pedder@cbre.com

Lic. 00902154

**Tony Binswanger, SIOR**

+1925 296 7728

Tony.binswanger@cbre.com

Lic. 01861701

**Courtney Curtis**

+1707 628 7584

Courtney.curtis@cbre.com

Lic. 02110227

**CBRE**

Trammell Crow Company

**CLARION PARTNERS**  
A Franklin Templeton Company

© 2025 CBRE, Inc. All rights reserved. This information has been obtained from sources believed reliable but has not been verified for accuracy or completeness. CBRE, Inc. makes no guarantee, representation or warranty and accepts no responsibility or liability as to the accuracy, completeness, or reliability of the information contained herein. You should conduct a careful, independent investigation of the property and verify all information. Any reliance on this information is solely at your own risk. CBRE and the CBRE logo are service marks of CBRE, Inc. All other marks displayed on this document are the property of their respective owners, and the use of such marks does not imply any affiliation with or endorsement of CBRE. Photos herein are the property of their respective owners. Use of these images without the express written consent of the owner is prohibited.