

# KURV DORAL

## BUILDING FOUR ±639,418 SF



## HIGHLIGHTS

- Premier location in one of the fastest growing cities in South Florida
- Immediate Highway Access with close proximity to MIA Cargo Entrance and Port Miami
- Seasoned Developer/Owner with proven national track record of Industrial Development
- Multiple space sizes available, including up to ±1.4 MSF Built-to-Suit Options
- Single and Multi-Tenant Building configurations available







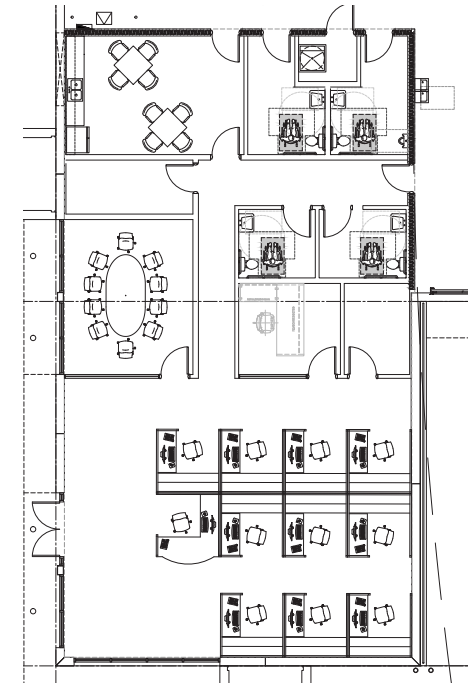
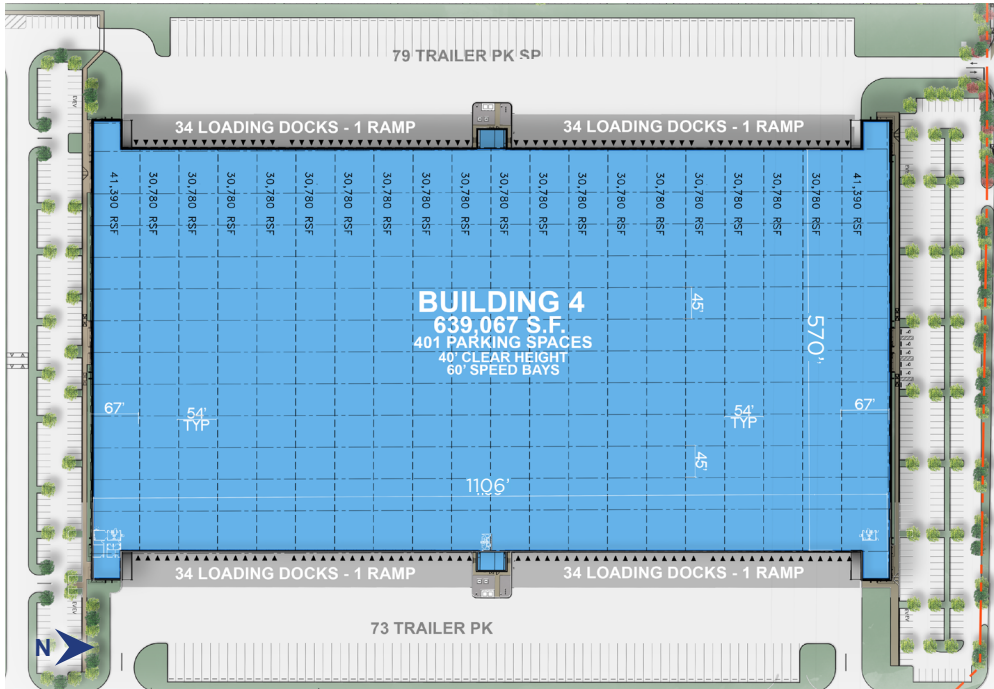





# KURV DORAL

## BUILDING FOUR ±639,418 SF



### BUILDING 4 FEATURES CROSS DOCK CONFIGURATION

-   
 ± 3,303 SF  
 Spec Office
-   
 4 per bay  
 Loading Doors  
 136 total
-   
 60' Staging Bay  
 cross dock
-   
 570' Building  
 Depth
-   
 120' Private  
 Truck Court +  
 Trailer Drops
-   
 40'  
 Clear Height
-   
 Four (4) 12'x14'  
 OH Door Ramps
-   
 403 Parking Spaces
-   
 54' Column Spacing
-   
 152 Trailer  
 Drops

**Wayne Ramoski**  
 wayne.ramoski@cushwake.com  
 786 210 3563

**Andrew Fernandez**  
 andrew.fernandez@cushwake.com  
 305 467 1449

**Ivanna Leitner Perez**  
 ivanna.leitner@cushwake.com  
 786 853 5431

**Skylar Stein**  
 skylar.stein@cushwake.com  
 305 533 2867



kurvindustrial.com

# KURV DORAL

## BUILDING FOUR ±639,418 SF



Polished Concrete Flooring

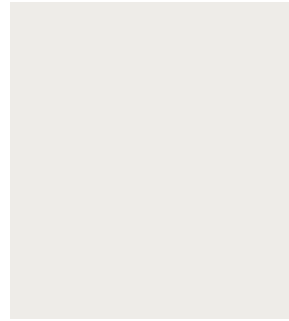

Paint- Sherwin Williams  
SW 7005 Pure White

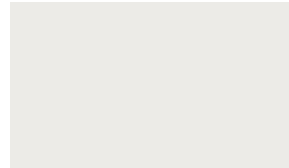

Traditional Wall Base- Tarkett  
460 Cotton W



Laminate Millwork-Top Cabinets- Wilsonart  
Harding Oak- 8258K-05-Timbergrain Finish



Laminate Millwork-Base Cabinets-Wilsonart  
Ethereal Velvet-15517-Ultra Matte



Edge Pull-Amerock  
4-1/2' Long Finger Cabinet Pull- Matte Black

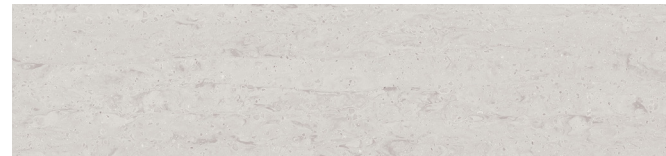

Solid Countertop- Wilsonart  
Iron Falls #9238SS

## TI FINISHES

### Wayne Ramoski

wayne.ramoski@cushwake.com  
786 210 3563

### Andrew Fernandez

andrew.fernandez@cushwake.com  
305 467 1449

### Ivanna Leitner Perez

ivanna.leitner@cushwake.com  
786 853 5431

### Skylar Stein

skylar.stein@cushwake.com  
305 533 2867



kurvindustrial.com