



GOWEN BUSINESS CENTER

COMMERCIAL

INDUSTRIAL SPACE FOR LEASE | 1057 EXCHANGE STREET | BOISE, ID 83716



CONTACT AGENT FOR SHOWING INSTRUCTIONS

CONTACT

DAN MINNAERT, SIOR, CCIM

208.947.0845
dan@tokcommercial.com

DEVIN PIERCE, SIOR

208.947.0850
devin@tokcommercial.com

HIGHLIGHTS

Prime industrial park location with easy access to I-84 and major thoroughfares.

Ste. 1057 has potential for a grade door. Contact agents to discuss.

Flexible and attractive space with excellent freeway visibility.

Primed for seamless distribution.

Each unit is equipped with a dock door.

Close proximity to Micron and retail amenities.

DETAILS

SPACE:	RSF:	RATE:
Ste. 1057	Office 520 SF	
	Whse 5,280 SF	
	Total 5,800 SF	\$0.95/SF/mo.

AVAILABLE: Immediately

CLEAR HEIGHT: 20'

LEASE TYPE: NNN

DOCK DOOR: 1/Unit

LEASE TERM: 3-5 Years

GRADE DOOR: Potential for Ste 1057 - Contact Agent

BLDG SIZE: 57,177 SF

ZONING: I-1

PARKING: Ample

POWER: 3 Phase

UPDATED: 5.28.2026

THIS PROPERTY IS EXCLUSIVELY MARKETING BY TOK BOISE LLC DBA TOK COMMERCIAL

This information was obtained from sources believed reliable but cannot be guaranteed. Any opinions or estimates are used for example only.

Another quality property by:



McLellan
C O M P A N Y

TOKCOMMERCIAL.COM

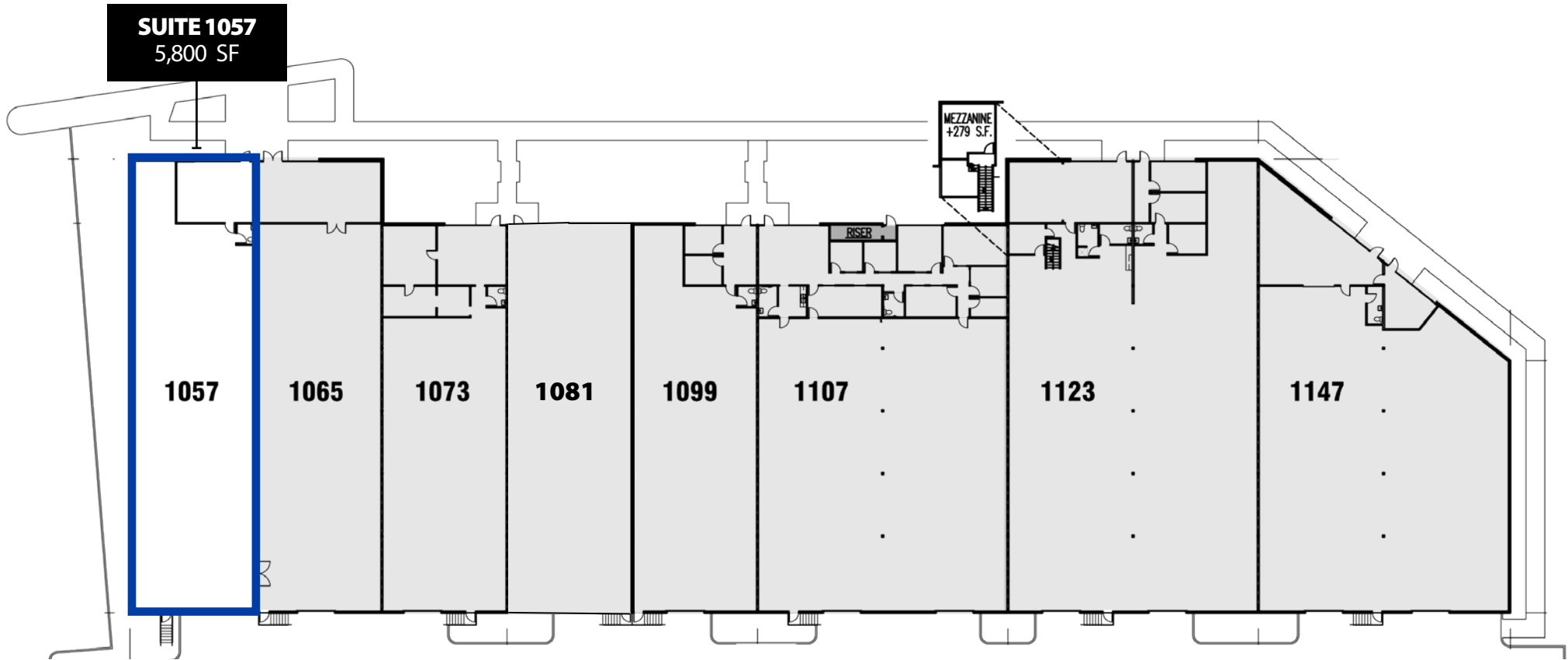

UPDATED: 5.28.2026

THIS PROPERTY IS EXCLUSIVELY MARKETING BY TOK BOISE LLC DBA TOK COMMERCIAL

This information was obtained from sources believed reliable but cannot be guaranteed. Any opinions or estimates are used for example only.

Boise Airport
7 MINUTE DRIVE (4.5 MILES)



SITE

COMMERCIAL TIRE

INTERSTATE ACCESS
3 MINUTE DRIVE (1.5 MILES)

RAVENWOOD SOLUTIONS

GOWEN RD

8 MINUTE DRIVE (2.5 MILES)
Micron

AZEK COMPANY



EXIT 57

AMAZON

KENWORTH