

ELECTRICAL SYMBOLS

- ⊠ - SINGLE POLE SWITCH
- ⊡ - 3 WAY SWITCH
- ⊞ - DUPLEX OUTLET
- ⊚ - FLOOR BURIED OUTLET WITH AN APPROVED WATERPROOF BOX AND COVER BY CARLON OR EQUAL. WIRING, BOX, AND COVER TO BE INSTALLED ACCORDING TO MANUFACTURER'S SPECIFICATIONS
- ⊚ - EXTERIOR OUTLET IN WATERPROOF BOX W/ LID
- ⊚ - GROUND FAULT INTERRUPT OUTLET
- ⊚ - BATTERY POWERED EMERGENCY LIGHTS
- ⊚ - WATERPROOF BATTERY POWERED EMERGENCY LIGHTS
- ⊚ - SELF-LUMINATION SIGN WITH SELF-CONTAINED BATTERY BACK-UP POWER SOURCE
- ⊚ - CEILING MOUNTED SURFACE INCANDESCENT LIGHT FIXTURE AS SELECTED BY OWNER
- ⊚ - CEILING MOUNTED LINEAR FLUORESCENT 4' BULB 48" LONG TB 32W FIXTURE
- ⊚ - CEILING MOUNTED LINEAR FLUORESCENT 8' BULB 48" LONG TB 32W FIXTURE
- ⊚ - CEILING MOUNTED DUCTED EXHAUST FAN W/ LIGHT FIXTURE
- ⊚ - HARD WIRED INTERCONNECTED SMOKE DETECTOR
- ⊚ - CEILING MOUNTED SMOKE DETECTOR TO BE AUDIO AND VISUAL
- ⊚ - INTERCONNECTED CARBON MONOXIDE DETECTOR
- ⊚ - CEILING MOUNTED CARBON MONOXIDE DETECTOR TO BE AUDIO AND VISUAL
- ⊚ - DUST DETECTORS SMOKE
- ⊚ - HORN/STROBE
- ⊚ - HORN/STROBE
- ⊚ - PULL STATION
- ⊚ - ANNUNCIATOR PANEL
- ⊚ - TELEPHONE JACK
- ⊚ - FLOOR TELEPHONE JACK WITH AN APPROVED WATERPROOF BOX AND COVER BY CARLON OR EQUAL. WIRING, BOX, AND COVER TO BE INSTALLED ACCORDING TO MANUFACTURER'S SPECIFICATIONS
- ⊚ - PORTABLE FIRE EXTINGUISHER

OCCUPANT LOAD CALCULATIONS

SPACE	USE	SQ. FT.	OCCUPANT LOAD PER S.F.	OCCUPANT LOAD PER SPACE
STORAGE NEIMAN	STORAGE	11792	300 GROSS	39 OCCUPANTS
NINJA TURTLE BJJ INDOOR	RECREATIONAL	3675	50 GROSS	73 OCCUPANTS
BADMINTON COURTS	GAMING	6961	7 NET	994 OCCUPANTS
PANORAMIC WINDOW AND DOORS	RETAIL	16872	60 GROSS	281 OCCUPANTS
SOE ENTERPRISE	RETAIL	2138	60 GROSS	35 OCCUPANTS
TRI COUNTY ELECTRICAL SUPPLY	RETAIL	1566	60 GROSS	26 OCCUPANTS
TOTAL OCCUPANTS ALL SPACES				1,448 OCCUPANTS

NOTE:
THE INTERIOR WALLS ARE BASED ON SKETCHES & OLD PLANS RECEIVED BY THE CLIENT & MIGHT BE SLIGHTLY BIGGER OR SMALLER

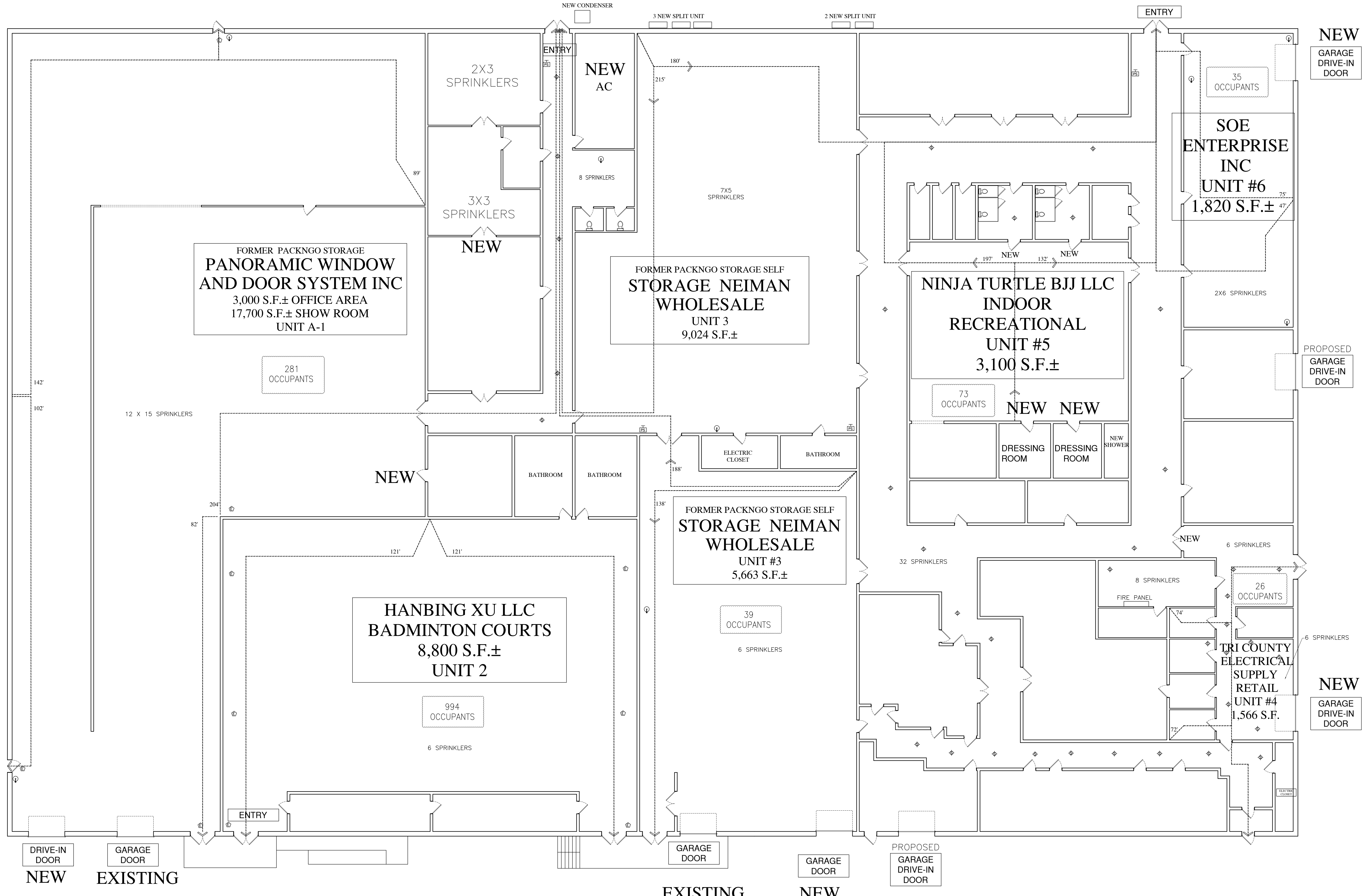

1 FIRST FLOOR LAYOUT & EGRESS DISTANCE
SCALE: 3/16" = 1'-0"

Hartman Design
COMMERCIAL - RESIDENTIAL
412 N. MAIN STREET, SUITE 301
MONROE NY 10510 845-781-4232
LARRY@HARTMANSDESIGN.COM

Jay H. Reichgott, P.E.
24GE04417500
9/2/2025

STATE OF NEW YORK
No. GE 44175
Professional Engineer
SEAL

WARNING: IT IS A VIOLATION OF NY STATE EDUCATION LAW, ARTICLE 145, SECTION 7209 FOR ANY PERSON, UNLESS ACTING UNDER THE DIRECTION OF A LICENSED PROFESSIONAL ENGINEER OR ARCHITECT, TO ALTER THESE DOCUMENTS IN ANY WAY. IF ALTERED, THE ALTERING INDIVIDUAL(S) MUST SIGN, WITH HIS OR HER SEAL, AND THE NOTATION "ALTERED BY" FOLLOWED BY HIS OR HER SIGNATURE, THE DATE OF SUCH ALTERATION, AND A SPECIFIC DESCRIPTION OF THE ALTERATION.

PROPOSED INTERIOR REMODELING FOR:
1422 NJ-179
LAMBERTVILLE
HUNTERDON COUNTY, NEW JERSEY

WRITTEN STATEMENT
TO THE BEST OF MY KNOWLEDGE, BELIEF AND PROFESSIONAL JUDGMENT, THESE PLANS AND SPECIFICATIONS ARE IN COMPLIANCE WITH THE NEW YORK STATE ENERGY CONSERVATION CONSTRUCTION CODE, AS CURRENTLY IN EFFECT.

Project No. 1422150
Drawn By: JHR
Reviewed By: JHR
Date: NOV. 26, 2024

01/30/25 REVISED AS PER B.D.
02/04/25 REVISED AS PER CLIENT
08/25/25 REVISED AS PER CLIENT
9/20/25 REVISED AS PER B.D.