



FOR SUBLEASE

10,451 RSF

**2333
WAUKEGAN
RD**

BANNOCKBURN, IL



10,451 RSF AVAILABLE ON 1ST FLOOR

- Term: Thru 7/31/2027
- Rate: \$15.00 Full-Service Gross
- Availability: 30 Days Notice
- Commission Rate: \$1.75/SF
- Furniture: Fully Available

SPACE NOTES

- Open receptions
- 14 Offices
- 41 Workstations
- Two Conference Rooms
- Copy/Print/Storage/Supply Room
- Large Break Room
- Fully Furnished, Wired & Cabled (Cat-6)

PROPERTY PHOTOS



1st Floor

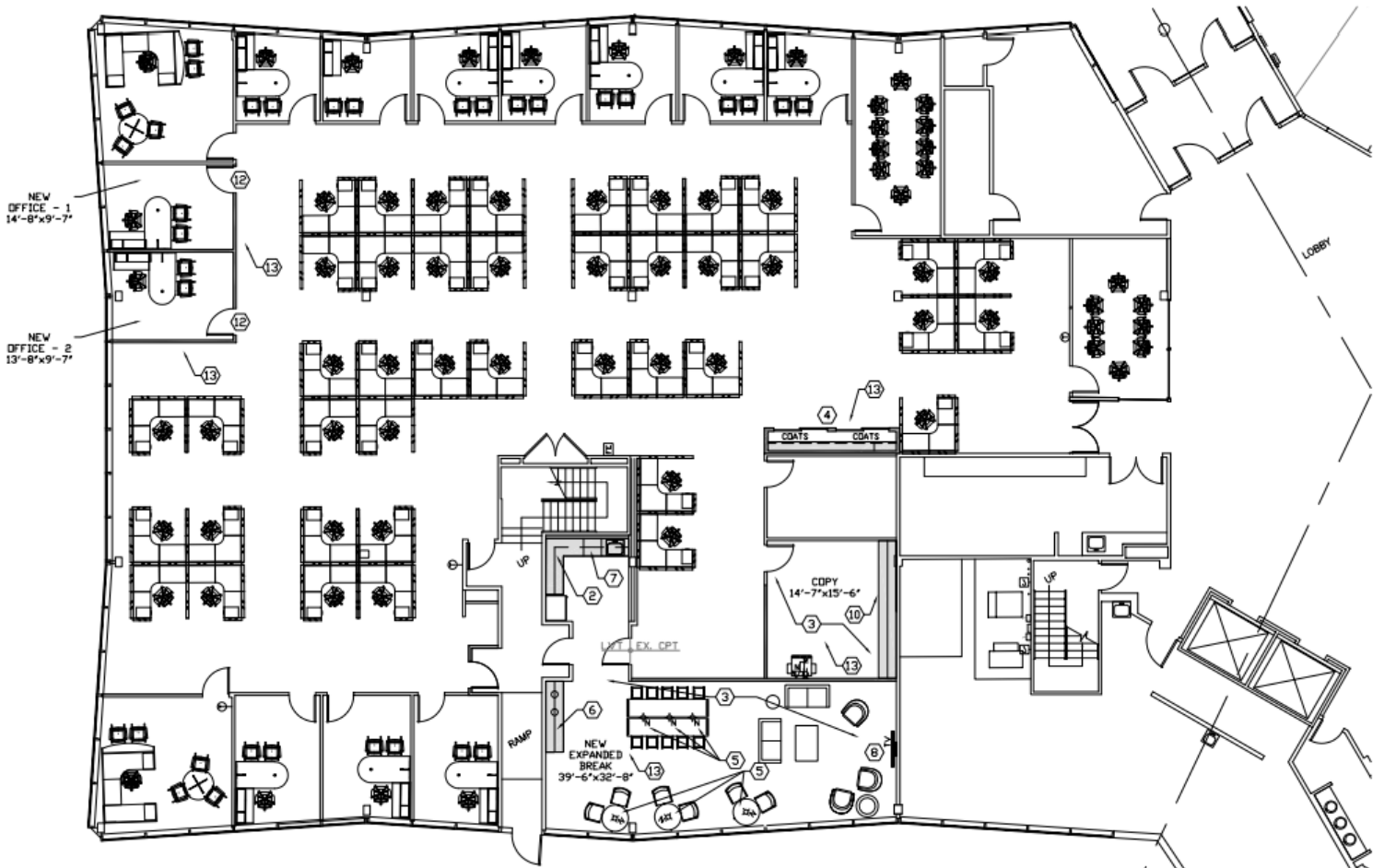

©2025 Cushman & Wakefield. All rights reserved. The information contained in this communication is strictly confidential. This information has been obtained from sources believed to be reliable but has not been verified. NO WARRANTY OR REPRESENTATION, EXPRESS OR IMPLIED, IS MADE AS TO THE CONDITION OF THE PROPERTY (OR PROPERTIES) REFERENCED HEREIN OR AS TO THE ACCURACY OR COMPLETENESS OF THE INFORMATION CONTAINED HEREIN, AND SAME IS SUBMITTED SUBJECT TO ERRORS, OMISSIONS, CHANGE OF PRICE, RENTAL OR OTHER CONDITIONS, WITHDRAWAL WITHOUT NOTICE, AND TO ANY SPECIAL LISTING CONDITIONS IMPOSED BY THE PROPERTY OWNER(S). ANY PROJECTIONS, OPINIONS OR ESTIMATES ARE SUBJECT TO UNCERTAINTY AND DO NOT SIGNIFY CURRENT OR FUTURE PROPERTY PERFORMANCE.



Michael Madden

Director

Office: +1 312 424 8079

Mobile: +1 847 636 2650

michael.madden@cushwake.com

Jonathan Metzl

Vice Chair

+1312 871 5016

jonathan.metzl@cushwake.com

