

- PLAT LEGEND**
- 1/2" X 24" STEEL REBAR SET WITH A YELLOW ID CAP
  - STAMPED "J, LYNCH PLS 3953"
  - STAMPED "WITNESS PLS 3953"
  - 1/2" STEEL REBAR FOUND WITH AN ORANGE ID CAP
  - 1/2" STEEL REBAR FOUND WITH A YELLOW ID CAP
  - ▲ STAMPED "BILLINGS PLS 3472"
  - 1/2" STEEL REBAR FOUND WITHOUT AN ID CAP
  - PIPES FOUND (SIZES NOTED ON PLAT) NO ID CAPS
  - UTILITY POLES
  - PIPES FOUND (SIZES NOTED ON PLAT) NO ID CAPS
  - C/L OF 30" ELECTRIC LINE EASEMENT

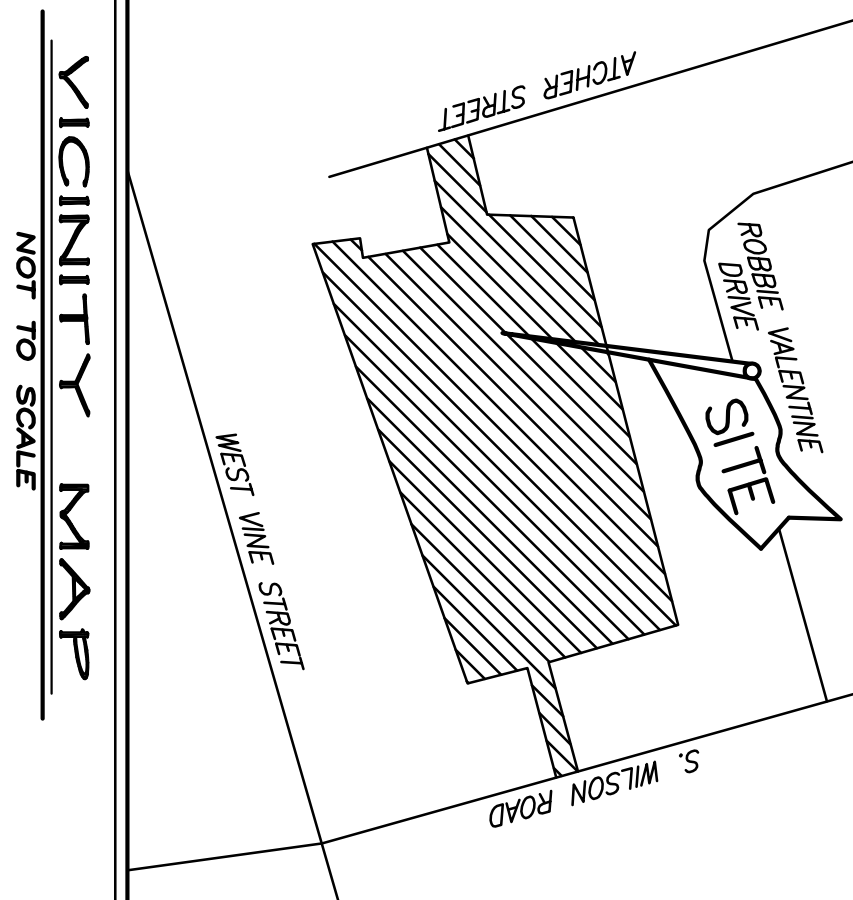
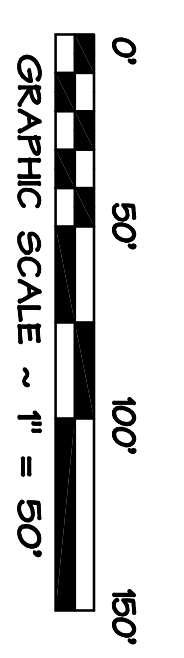

**SURVEYORS CERTIFICATION**

I HEREBY CERTIFY THAT THE SURVEY DEPICTED BY THIS PLAT WAS DONE BY PERSONS UNDER MY DIRECT SUPERVISION BY THE METHOD OF SURVEYING AND RECORDING BY RANDOM WALKS, TRANSIT, OR GPS SURVEYING USING THE FOLLOWING INSTRUMENTS AND EQUIPMENT: GPS EQUIPMENT WITH THE REMAINDER USING A TOPCON GTS 303 SERIES TOTAL STATION.

THIS SURVEY IS A RURAL SURVEY AND MEETS ALL THE ACCURACY & PRECISION SPECIFICATIONS OF THIS CLASS AND/OR THE RELATIVE POSITIONAL ACCURACY OF EACH POINT IS ± 0.06' (100PPM). THE ANGULAR & LINEAR MEASUREMENTS HAVE NOT BEEN ADJUSTED FOR CLOSE AND ARE ALL MEASUREMENTS INDICATED HERE DO ACTUALLY EXIST AND THAT THEIR LOCATIONS, SIZES AND MATERIALS ARE CORRECTLY INDICATED.

HORIZONTAL DATUM - NAD 83; VERTICAL DATUM - WMD 98; GEOID MODEL - GEOID 12.

DATE OF PROFESSIONAL LAND SURVEYOR #3953

JEREMY L. LYNCH, LICENSED PROFESSIONAL LAND SURVEYOR #3953

DATE OF FIELD SURVEY 11/19/15

DATE OF FINAL PLAT 11/20/15

**BOUNDARY SURVEY OF:**

**MARGARET KIETA PROPERTY**

S. WILSON RD & ATCHER ST., RADCLIFF, HARRIN CO., KENTUCKY

OWNER/CLIENT: MARGARET KIETA  
1306 WINGARD DRIVE  
RADCLIFF, KENTUCKY 40160

SCALE: 1 IN. = 50 FT. DWG. BY: J. LYNCH PLS 160-20-05-058  
DATE: 11/20/15 AREA: 9.287 ACRES DWG. NUMBER: DSWMS1507000T  
BUILD: 15-160 SOURCE: DB 211, PG 97 & PT OF DB 208, PG 112

**TURNER ENGINEERING**  
A DIVISION OF NEW BANKS INC.  
5735 NORTH DIXIE HIGHWAY  
ELIZABETHTOWN, KENTUCKY 42701  
PH: (270) 731-3232 ~ FAX (270) 769-5497

THIS PLAT REPRESENTS A BOUNDARY SURVEY AND COMPLIES WITH 201 KAR 181.50.

**GENERAL PLAT NOTES:**

1. SITE IS SUBJECT TO ALL RIGHT-OF-WAYS AND EASEMENTS OF RECORD OR IMPLIED AND SUBJECT TO LEGAL REVIEW AS TO CONFORMANCE WITH ALL STATE AND LOCAL REGULATIONS CONCERNING LAND DIVISIONS & SUBDIVISIONS.