

DETAIL
SCALE: 1" = 25 FEET

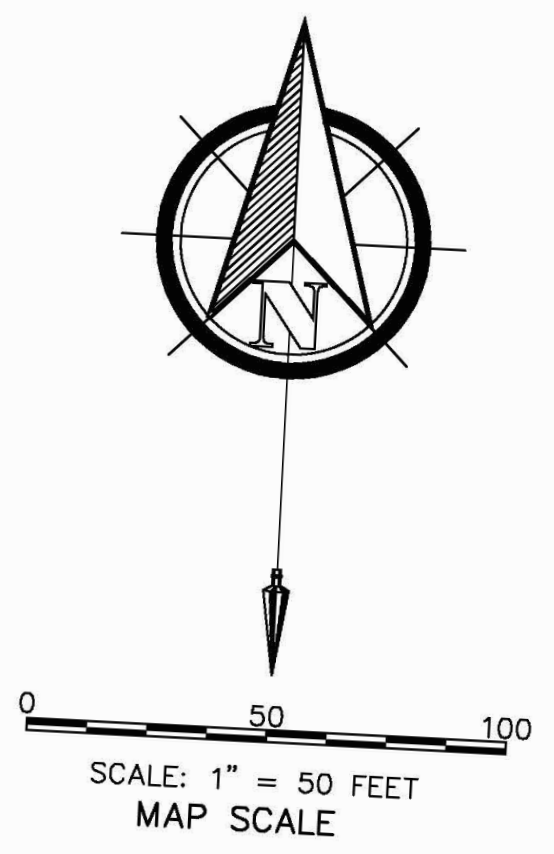

BASIS OF BEARINGS

N 81°02'35" E AS DETERMINED AND MEASURED BETWEEN FOUND MONUMENTS AS SHOWN HEREON, AND AS REFERENCE IN SUB. MAP Vol. 9, Pg. 57-62, BEING A CALIFORNIA ZONE 3 GRID BASIS

MAP & DEED REFERENCES

- R1 SUB. Vol. 9, Pgs. 57-62
- R2 P.M. Vol. 21, Pg. 100
- R3 R.S. Vol. 43, Pg. 49
- R4 Vol.1304 O.R. Pg.557

LEGEND:

- SET 3/4" REBAR TAGGED LS7698
- SET 3/4" REBAR TAGGED LS7698
- SET 3/4" REBAR TAGGED LS7698
- SET 3/4" REBAR TAGGED LS7698
- RESUB PARCELS BOUNDARY LINE
- ADJACENT PARCEL AND R.O.W. LINE
- EASEMENT SIDELINE AS NOTED
- CENTERLINE
- RADIAL LINE
- M MEASURED BEARING & DISTANCE
- C CALCULATED POINT ONLY
- SNF SEARCHED NOTHING FOUND

PARCEL MAP

for a RE-SUBDIVISION
of Lot 53 of Black Oak Estates Unit Two,
Vol. 9, Sub., Pgs. 57-62, and Parcel 1 and Parcel 2,
of Grant Deed 1304 O.R. 557,
Official Records of Tuolumne County,
lying in the NE 1/4 of the SW 1/4 of Section 9,
T.2 N., R.16 E., M.D.M.,
TUOLUMNE COUNTY, CALIFORNIA

Doc. # 2021008302
Golden State Realty Assc.