

REDUCED PRICE!



PILOT
PROPERTY GROUP

HEAVY INDUSTRIAL ZONING
24650 SHERWOOD AVE, CENTERLINE, MI 48015

PROPERTY OVERVIEW:

- Great investment opportunity
- Truck parking available
- Well maintained building
- Tenant paying \$9,000/month until 3/1/27
- Ample Parking

Property Type:	Industrial Investment
Cross Streets:	On Sherwood just south of 10 Mile Road
Total Square Footage:	14,776
Year Built:	1998
Parcel ID:	01-13-28-202-006
Total Acreage:	1.6 AC
Zoning:	M-1
Sale Price:	\$1,825,000.00 \$1,600,000.00

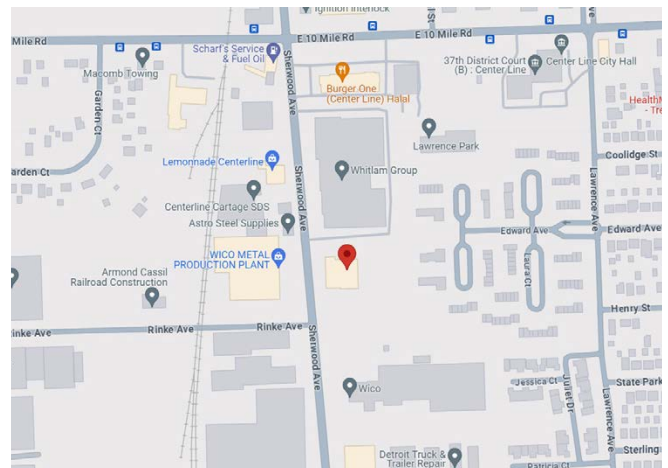

AGENT CONTACT INFO

JUSTIN FRANCEK O: 586.254.0900 x124 • C: 586.227.9515 • justin@pilotpg.com

Matching the right people to the right place.

Offices in Sterling Heights and Port Huron to serve you
586.254.0900 • www.pilotpg.com

FLOOR PLAN

Image/Sketch for Parcel: 01-13-28-202-006

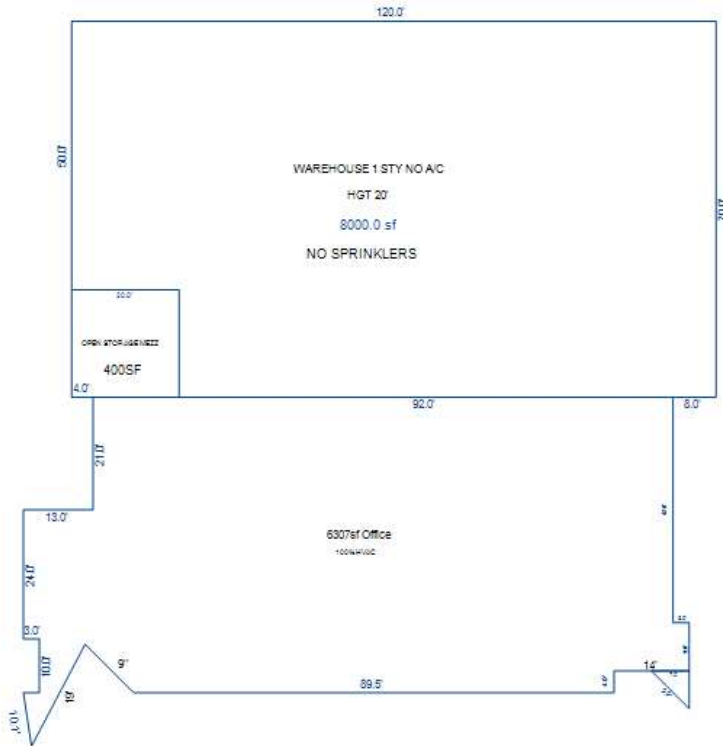

MSR'D 2022-08-29'

Matching the right people to the right place.

Offices in Sterling Heights and Port Huron to serve you
586.254.0900 • www.pilotpg.com

ADDITIONAL PHOTOS



Matching the right people to the right place.

Offices in Sterling Heights and Port Huron to serve you
586.254.0900 • www.pilotpg.com

ADDITIONAL PHOTOS



Matching the right people to the right place.

Offices in Sterling Heights and Port Huron to serve you
586.254.0900 • www.pilotpg.com