

For **Industrial Crane Building - 40,000 SqFt - High Power**  
**SALE** 6202 S. State Rd Goodrich, MI



**\$3,300,000**

480 VAC 3-Phase, 3,500 Amps • Extensive Power Drops and Air Lines • High Speed Networks  
31,000 Factory (32' Ceilings, 138' Length) • 7.5-Ton Bridge Cranes (3), 5-Ton Crane  
14'x16' Grade Doors (4) • Truck Well w/ Leveling Dock • 8'x10' Grade Door  
9,000 SqFt Renovated Office • Locker Room • Showers • Cafeteria and Kitchenette  
**South-East of Flint: Quick Access to I-69 & Metro Detroit**

# 6202 S. State Road Goodrich, MI 48438



**Paint Booth, 25x13**  
**Air Compressor and Dryer**  
**New LED lighting**  
**Radiant Gas Heat**  
**Built in 1986 /1995/ 1996**  
**Renovated in 2018 & 2024**  
**Parcel ID: 02-10-100-019**  
**Zoning: M-1, C-2**



**40x36 Barn with 4 OH Doors**  
**24.96 Acres**  
**Well and Septic**

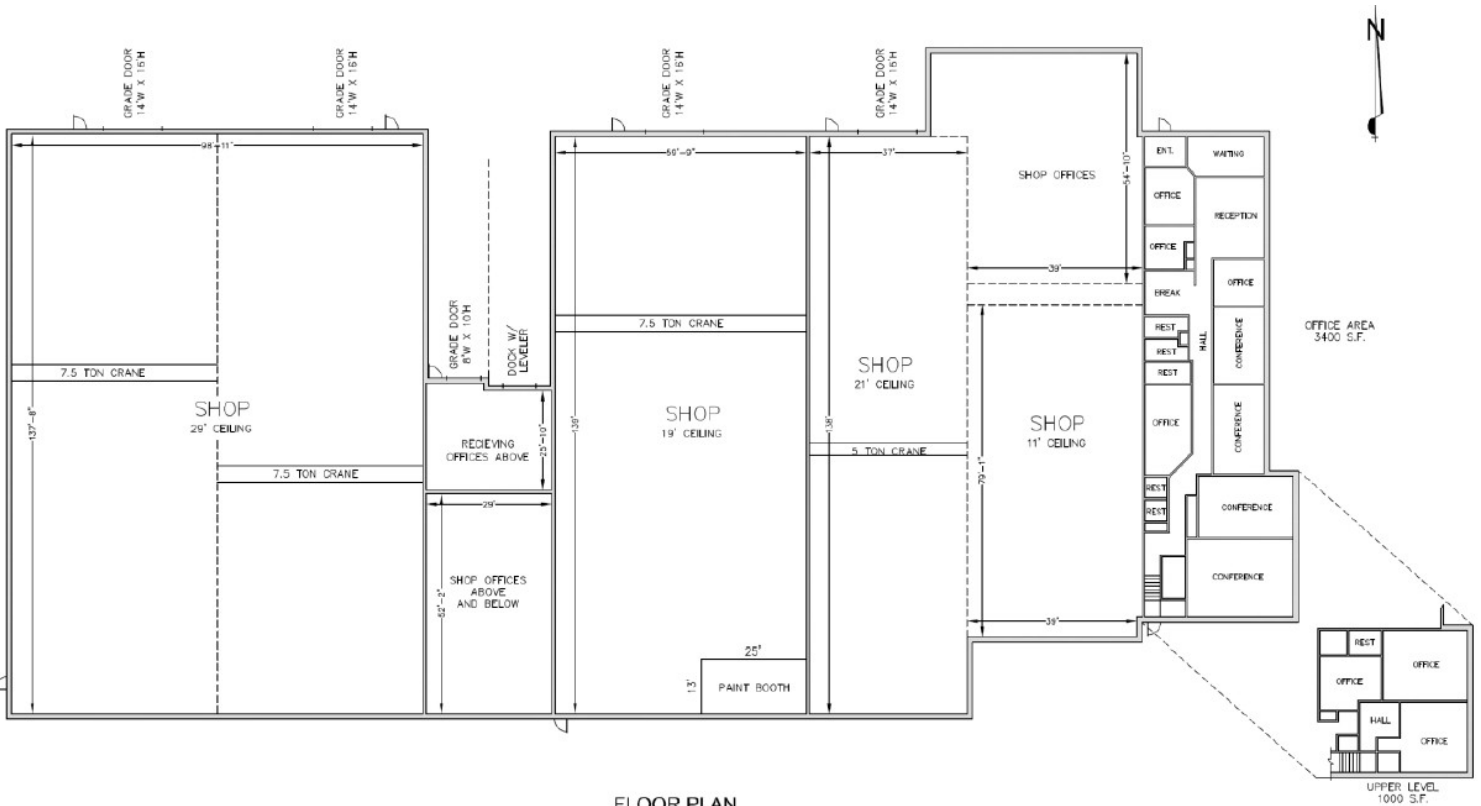

FLOOR PLAN  
6202 S. STATE ROAD  
GROSS AREA 40,000 S.F.